

# DMC 450SL - SOLID SUBSTRATE

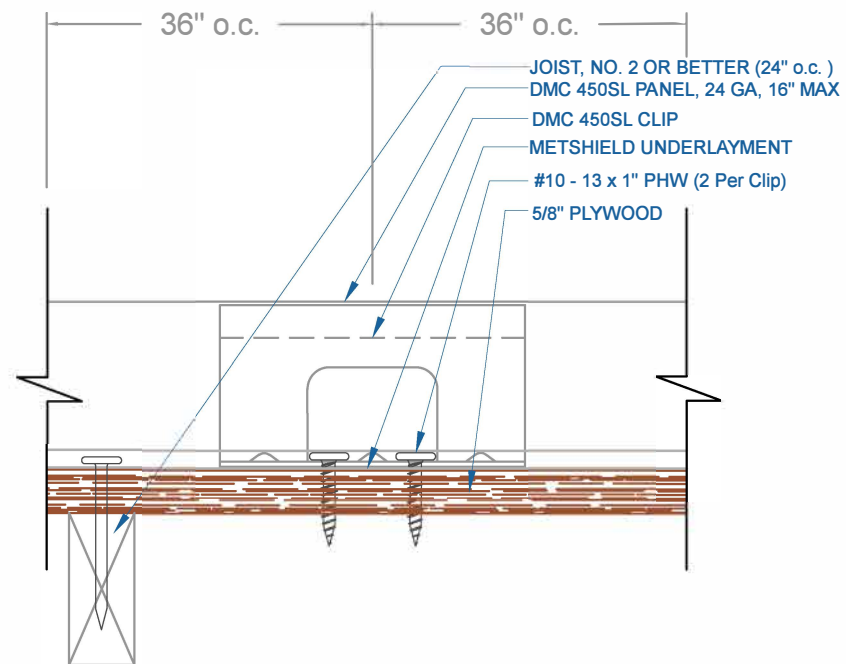

## INSTALLATION

SCALE: NTS  
EFFECTIVE DATE: 09-13-13

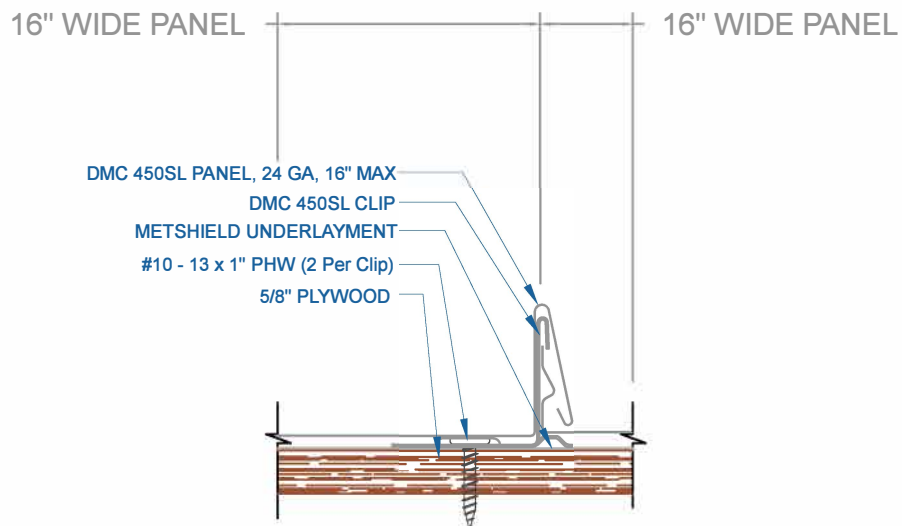

# DMC 450SL - PLYWOOD

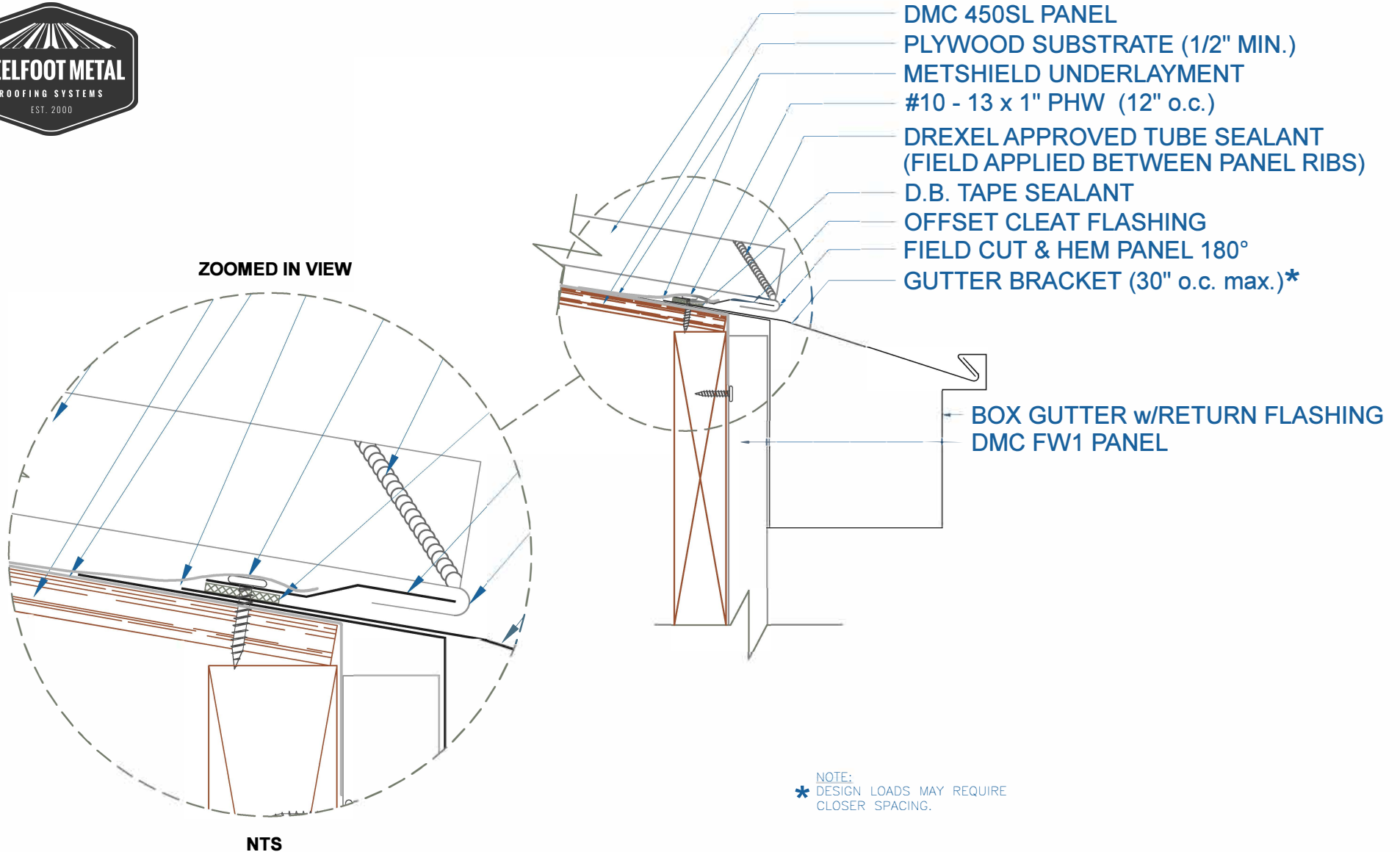

## BOX GUTTER - w/RETURN w/FLUSH PANEL

EFFECTIVE DATE: 01-06-2014  
SUBJECT TO CHANGE WITHOUT NOTICE

SCALE: 3" = 1'-0"



# DMC 450SL - PLYWOOD

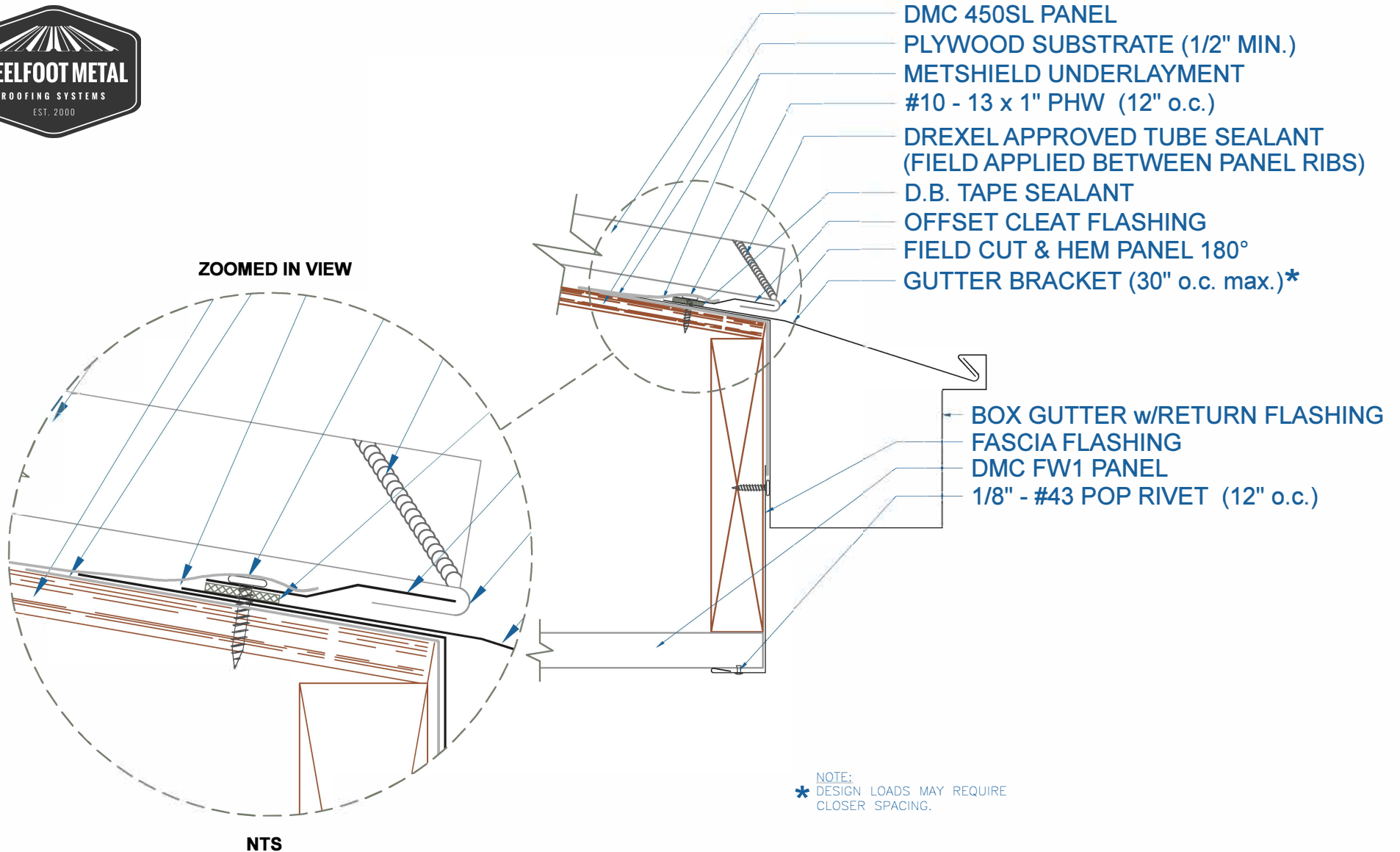

## BOX GUTTER - w/RETURN w/SOFFIT

EFFECTIVE DATE: 01-06-14  
SUBJECT TO CHANGE WITHOUT NOTICE

SCALE: 3" = 1'-0"



# DMC 450SL - PLYWOOD

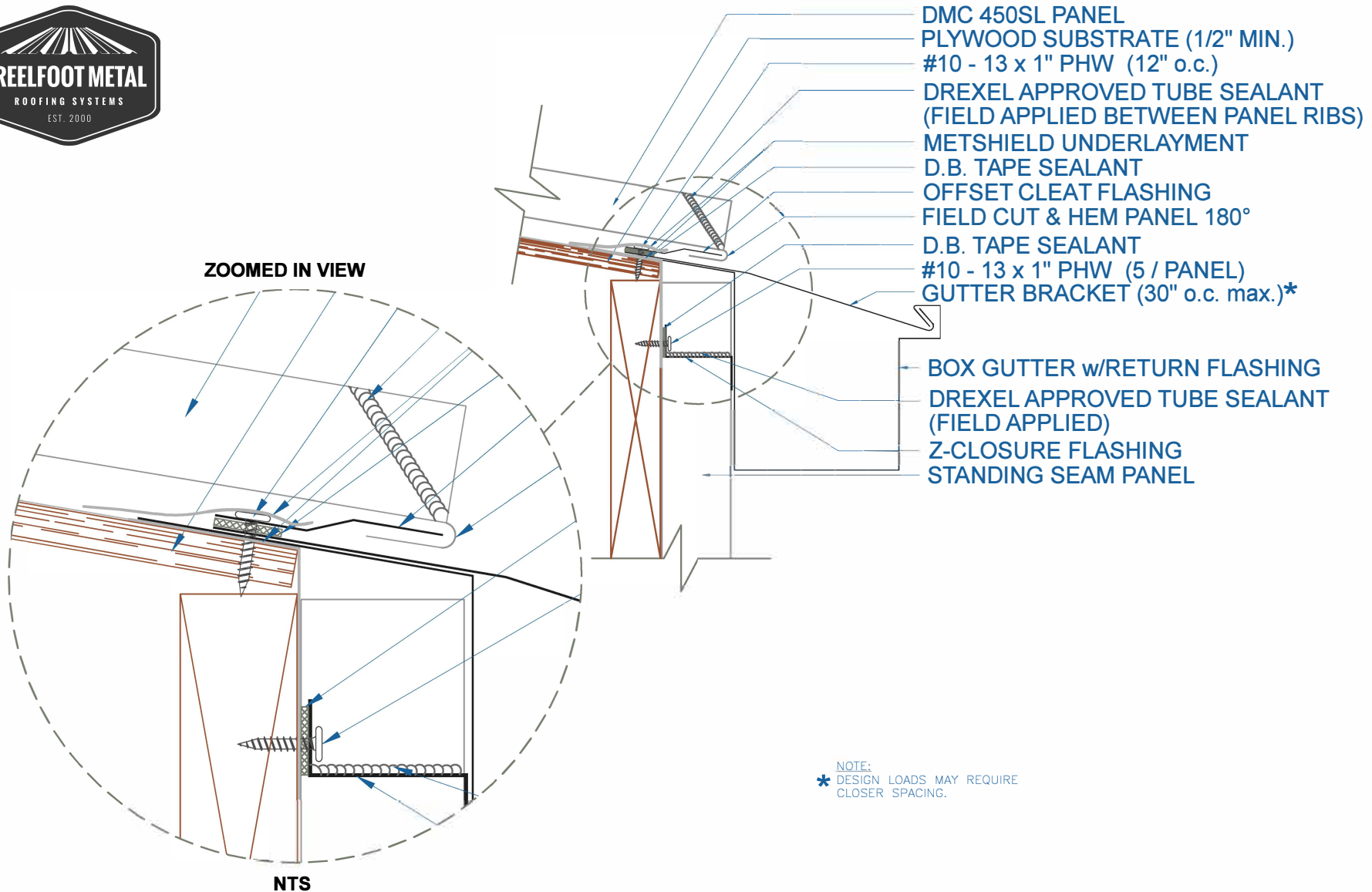

NOTE:  
\* DESIGN LOADS MAY REQUIRE  
CLOSER SPACING.

## BOX GUTTER w/RETURN w/STANDING SEAM PANEL

SCALE: 3" = 1'-0"

EFFECTIVE DATE: 01-06-14  
SUBJECT TO CHANGE WITHOUT NOTICE

**DrexelMetals**  
Roofing Systems + Custom Fabrication





# DMC 450SL - PLYWOOD

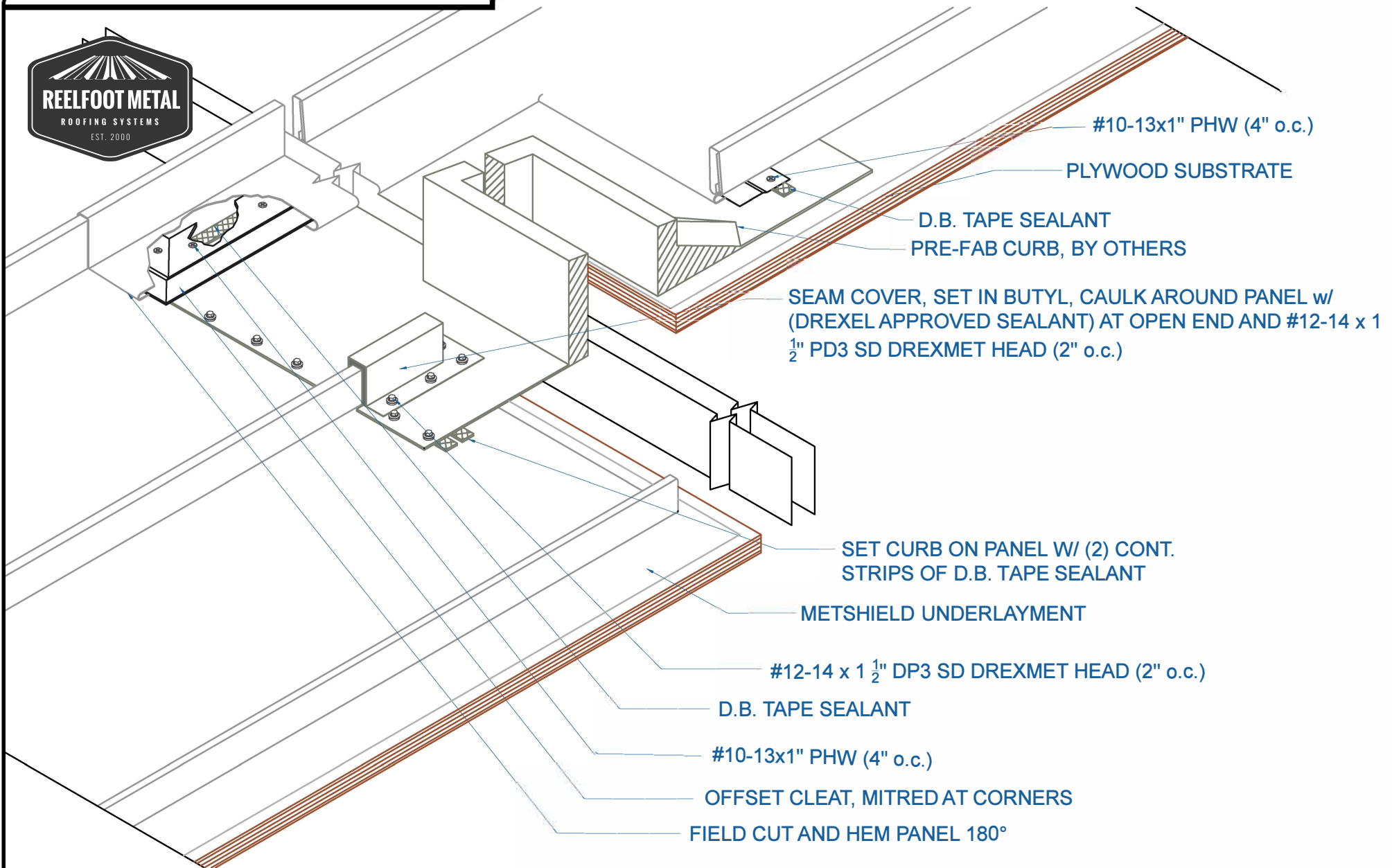

## CURB DETAIL

SCALE: NTS

EFFECTIVE DATE: 01-06-2014  
SUBJECT TO CHANGE WITHOUT NOTICE



# DMC 450SL - PLYWOOD

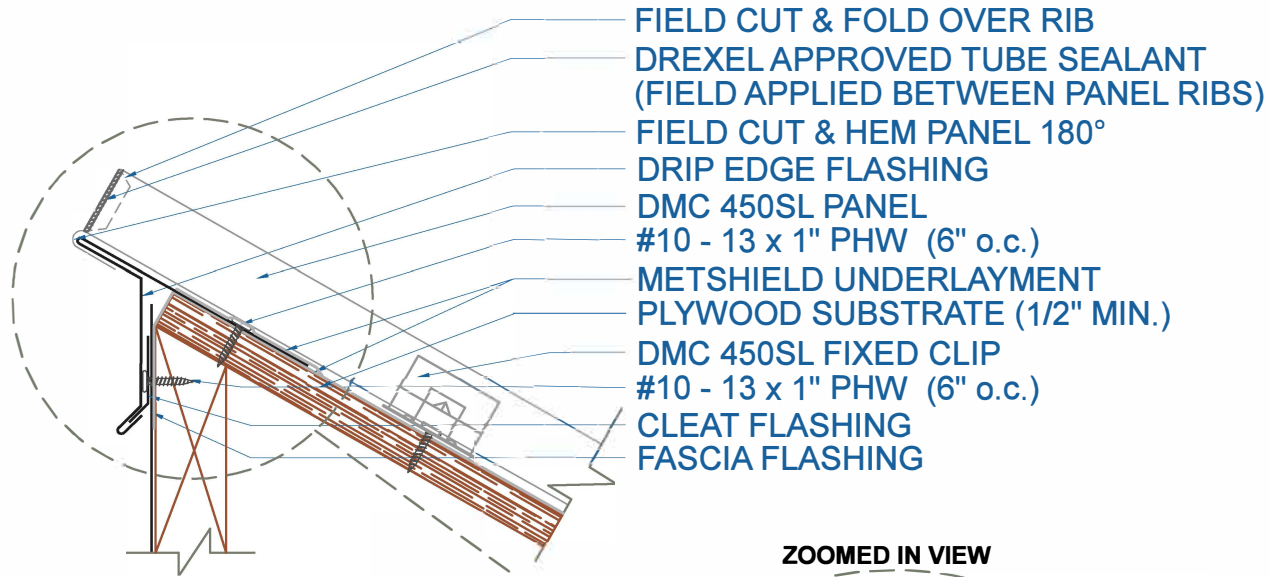

- FIELD CUT & FOLD OVER RIB
- DREXEL APPROVED TUBE SEALANT  
(FIELD APPLIED BETWEEN PANEL RIBS)
- FIELD CUT & HEM PANEL 180°
- DRIP EDGE FLASHING
- DMC 450SL PANEL
- #10 - 13 x 1" PHW (6" o.c.)
- METSHIELD UNDERLAYMENT
- PLYWOOD SUBSTRATE (1/2" MIN.)
- DMC 450SL FIXED CLIP
- #10 - 13 x 1" PHW (6" o.c.)
- CLEAT FLASHING
- FASCIA FLASHING

ZOOMED IN VIEW

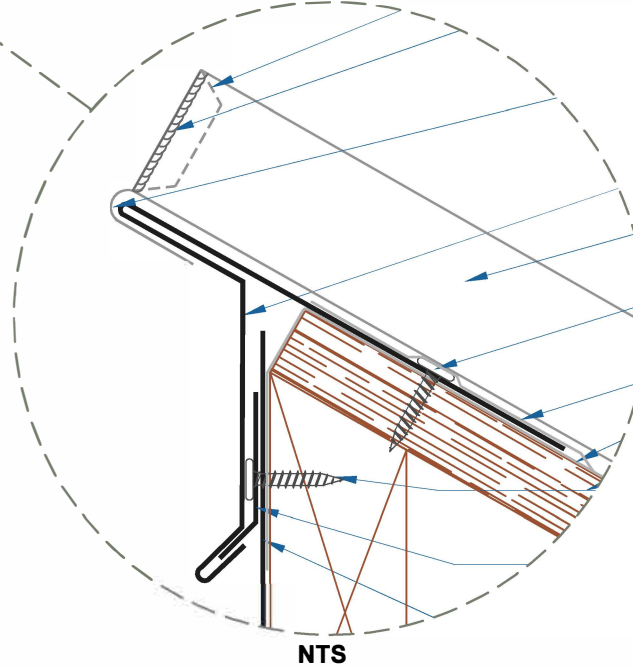

NTS

EFFECTIVE DATE: 01-06-14  
SUBJECT TO CHANGE WITHOUT NOTICE

## DRIP EDGE PEAK

SCALE: 3" = 1'-0"

**Drexel Metals**  
Roofing Systems + Custom Fabrication



# DMC 450SL - PLYWOOD

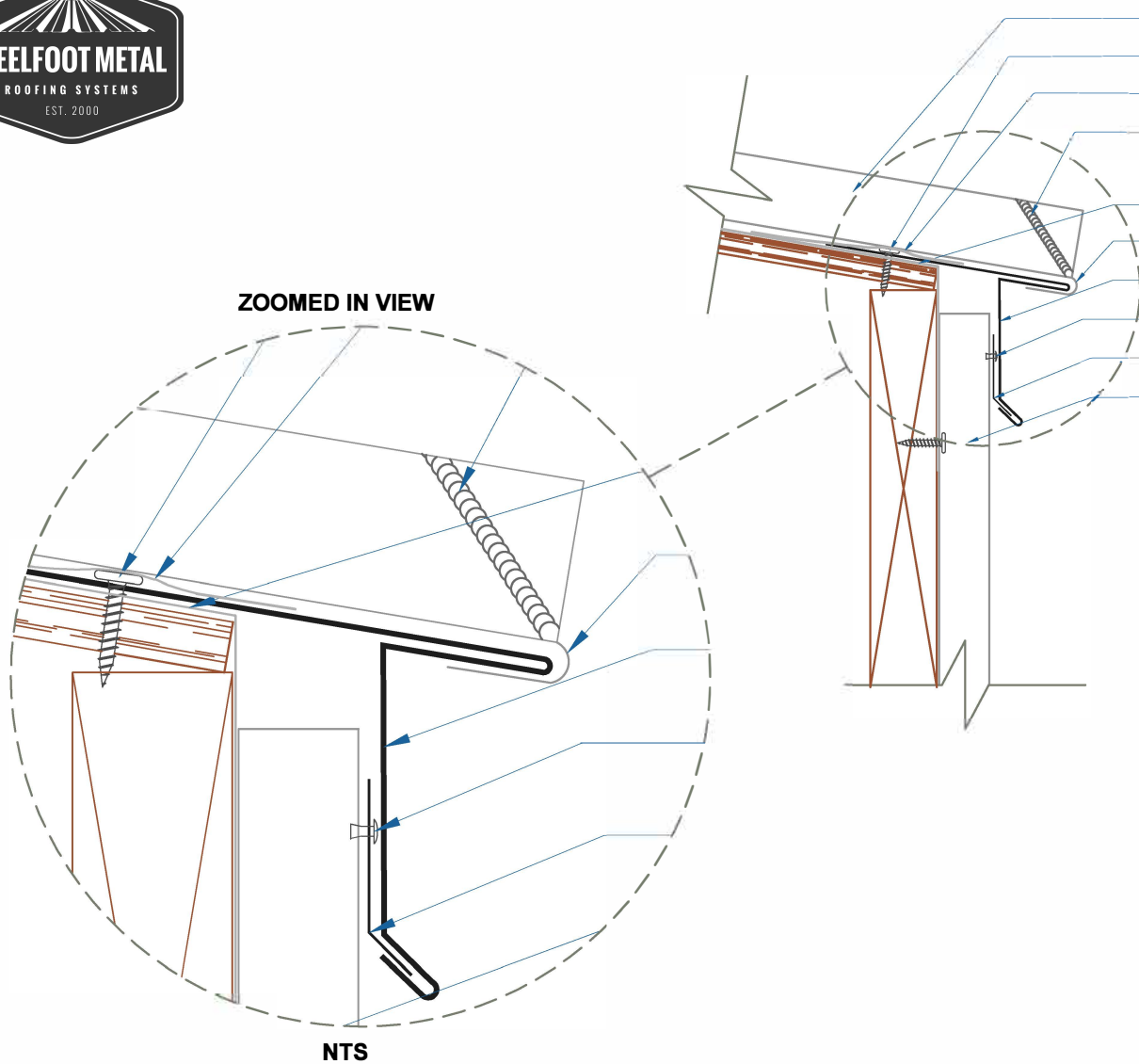

- DMC 450SL PANEL
- #10 - 13 x 1" PHW (12" o.c.)
- METSHIELD UNDERLAYMENT
- DREXEL APPROVED TUBE SEALANT (FIELD APPLIED BETWEEN PANEL RIBS)
- METSHIELD UNDERLAYMENT
- FIELD CUT & HEM PANEL 180°
- DRIP EDGE FLASHING
- 1/8" - #43 POP RIVET (6" o.c.)
- CLEAT FLASHING
- DMC FW1 PANEL

## DRIP EDGE w/FLUSH PANEL

SCALE: 3" = 1'-0"

EFFECTIVE DATE: 01-06-14  
SUBJECT TO CHANGE WITHOUT NOTICE



# DMC 450SL - PLYWOOD

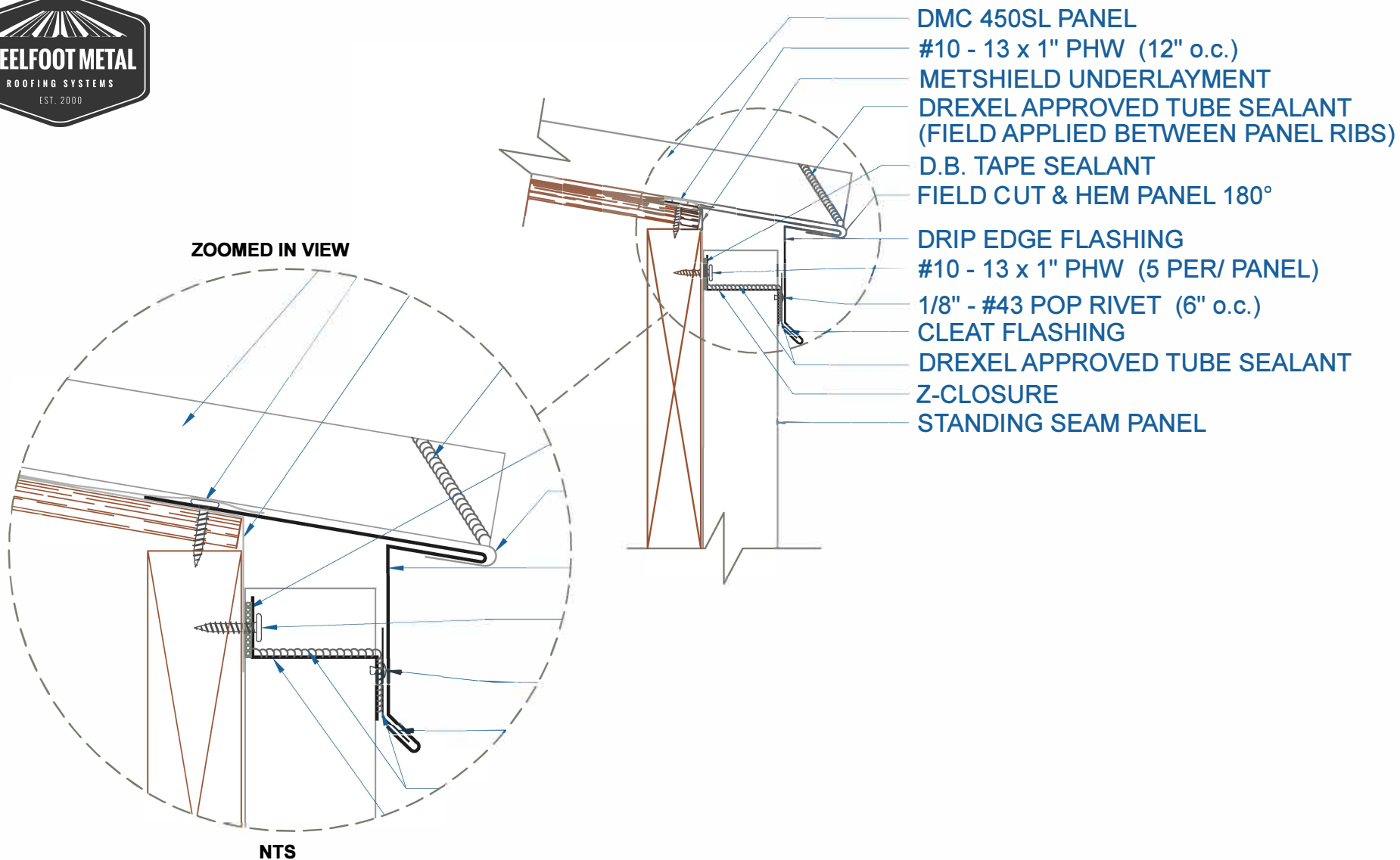

## DRIP EDGE w/STANDING SEAM PANEL

EFFECTIVE DATE: 01-06-14  
SUBJECT TO CHANGE WITHOUT NOTICE

SCALE: 3" = 1'-0"

**DrexelMetals**  
Roofing Systems + Custom Fabrication



# DMC 450SL - PLYWOOD



ZOOMED IN VIEW

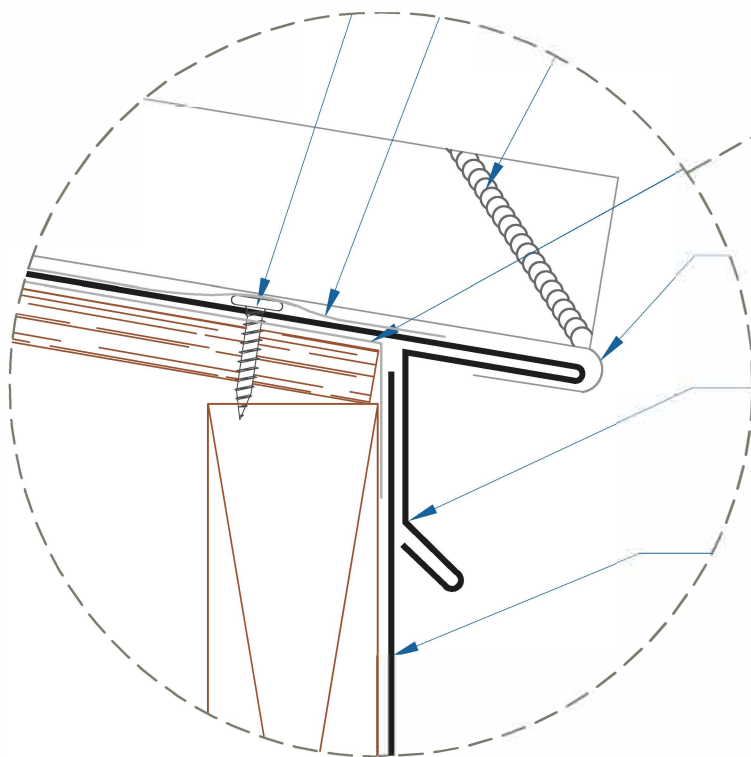

NTS

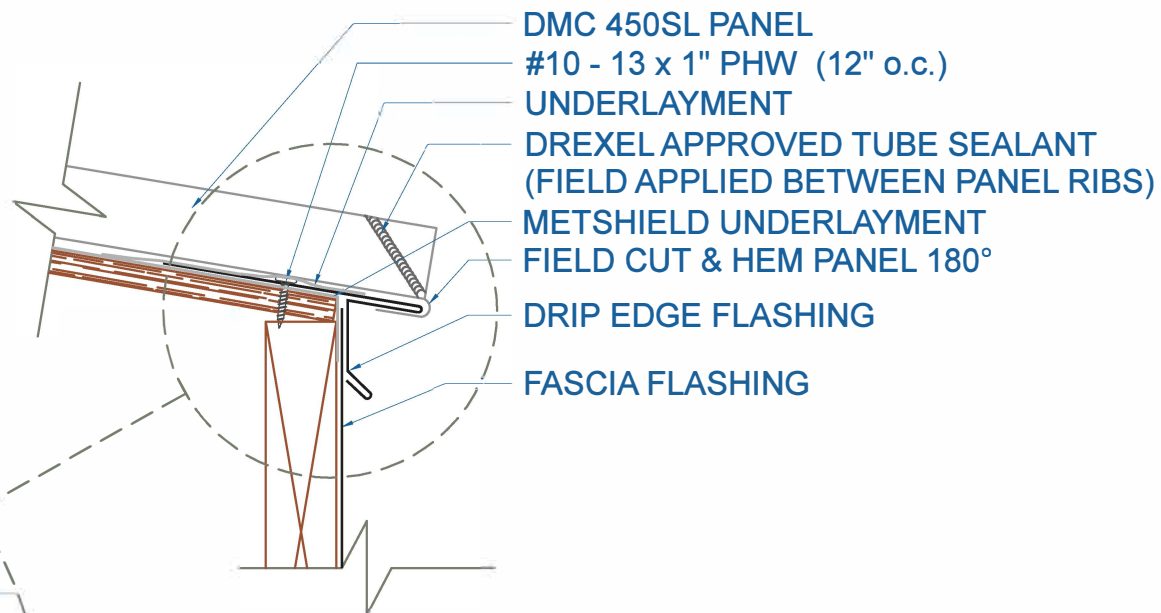

- DMC 450SL PANEL
- #10 - 13 x 1" PHW (12" o.c.)
- UNDERLAYMENT
- DREXEL APPROVED TUBE SEALANT (FIELD APPLIED BETWEEN PANEL RIBS)
- METSHIELD UNDERLAYMENT
- FIELD CUT & HEM PANEL 180°
- DRIP EDGE FLASHING
- FASCIA FLASHING

EFFECTIVE DATE: 01-06-14  
SUBJECT TO CHANGE WITHOUT NOTICE

## DRIP EDGE

SCALE: 3" = 1'-0"



# DMC 450SL - PLYWOOD

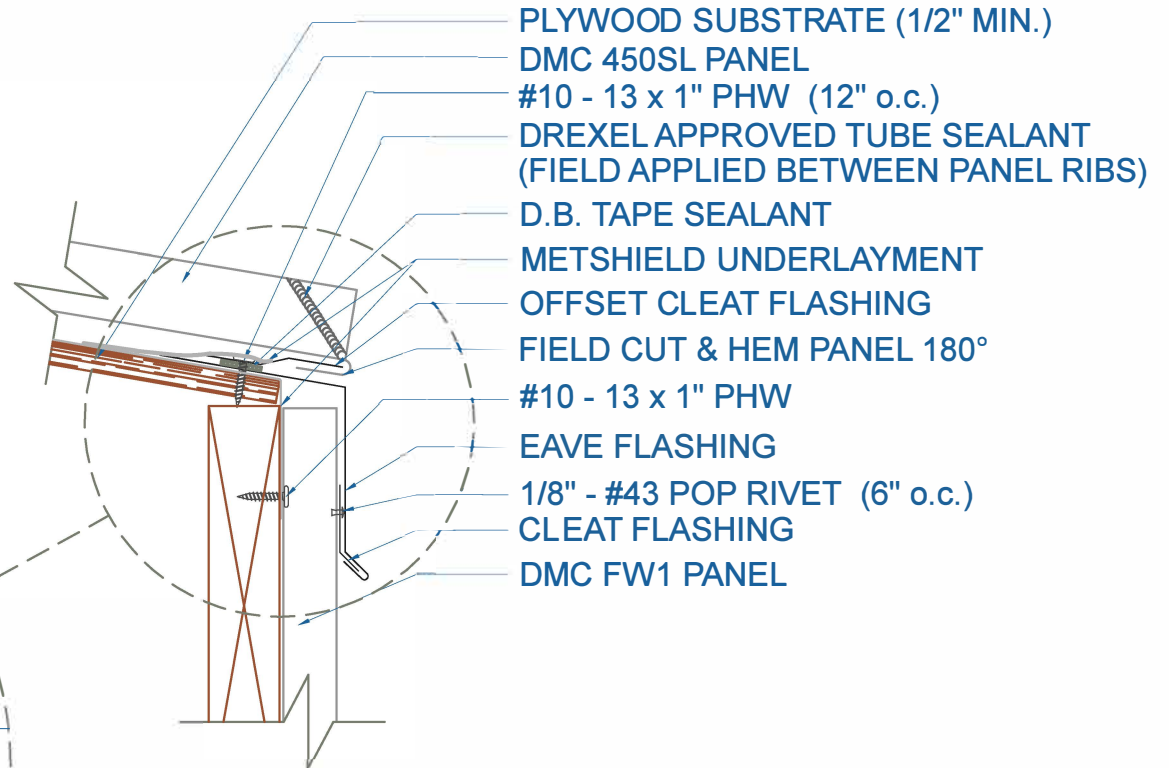
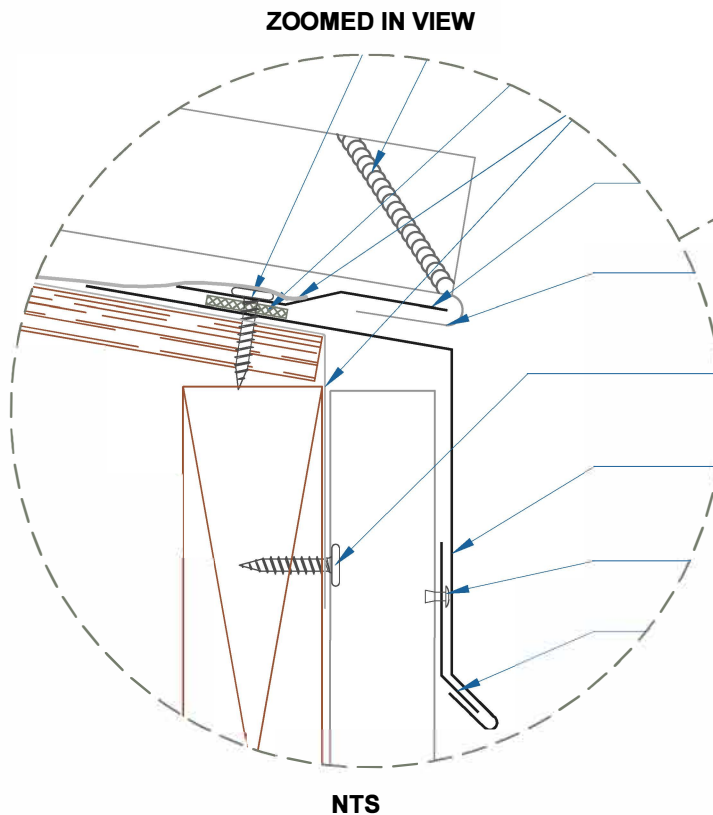

## EAVE w/FLUSH PANEL

SCALE: 3" = 1'-0"

EFFECTIVE DATE: 01-06-14  
SUBJECT TO CHANGE WITHOUT NOTICE

**DrexelMetals**  
Roofing Systems + Custom Fabrication





# DMC 450SL - PLYWOOD

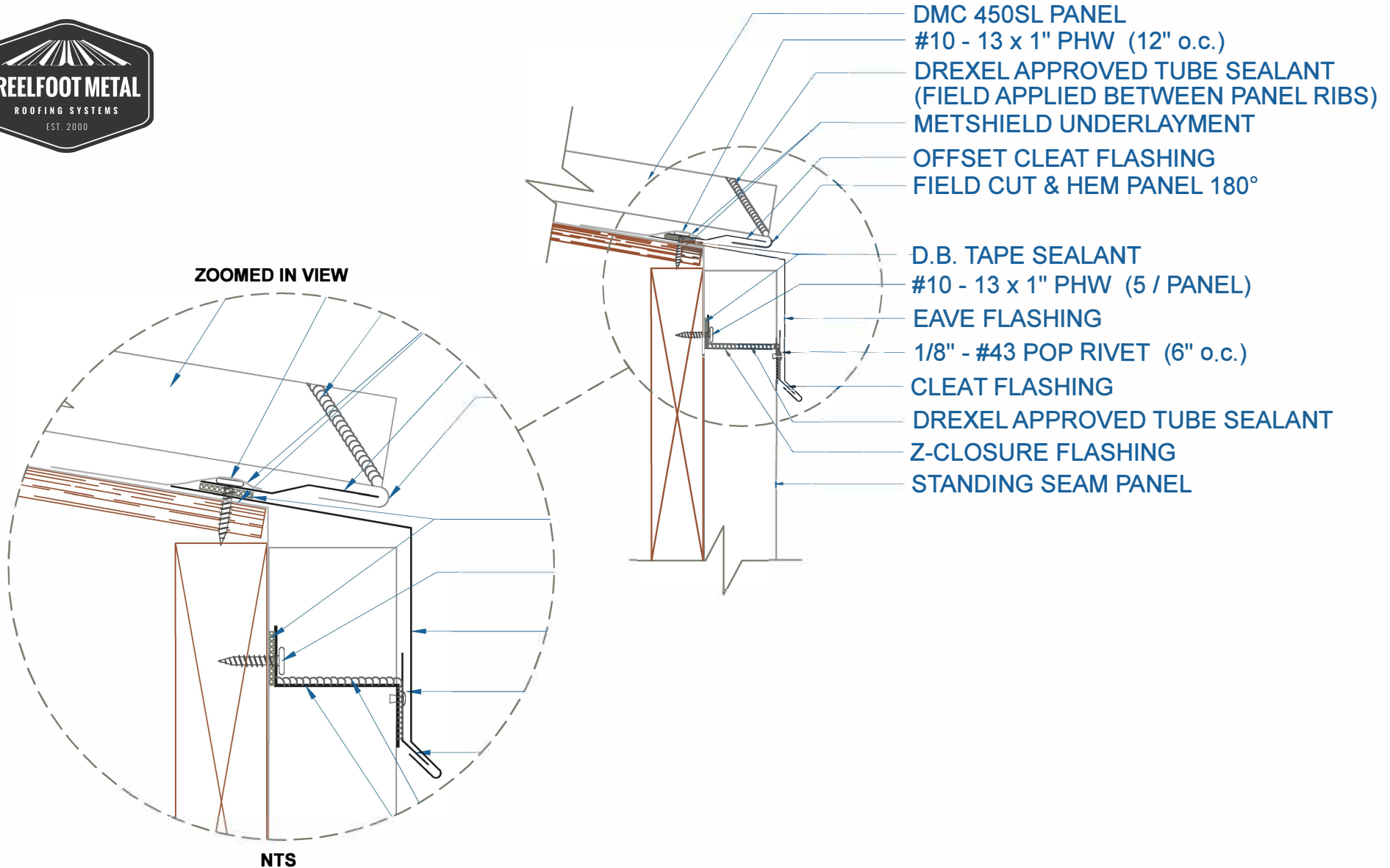

## EAVE w/STANDING SEAM PANEL

EFFECTIVE DATE: 01-06-14  
SUBJECT TO CHANGE WITHOUT NOTICE

SCALE: 3" = 1'-0"



# DMC 450SL - PLYWOOD



- #10 - 13 x 1" PHW (12" o.c.)
- METSHIELD UNDERLAYMENT
- PLYWOOD SUBSTRATE (1/2" MIN.)
- DMC 450SL PANEL (FIELD CUT AND BEND)
- #10 - 13 x 1" PHW (12" o.c.)
- DRIP EDGE FLASHING
- CLEAT FLASHING
- FASCIA FLASHING

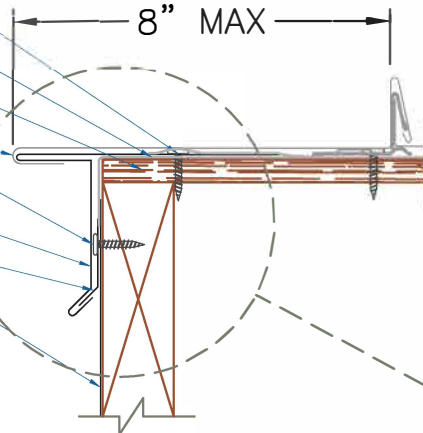

ZOOMED IN VIEW

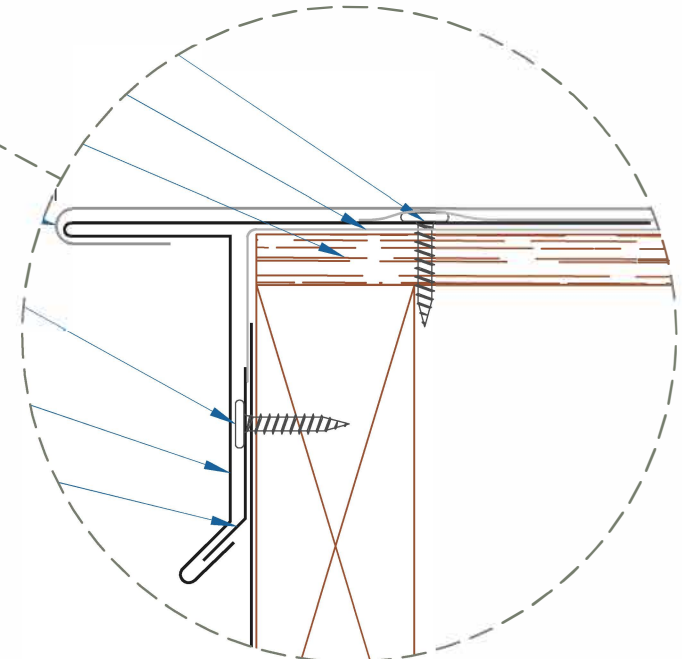

NTS

## GABLE ALTERNATE / CURVED

EFFECTIVE DATE: 01-06-14  
SUBJECT TO CHANGE WITHOUT NOTICE

SCALE: 3" = 1'-0"



# DMC 450SL - PLYWOOD

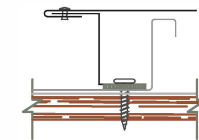
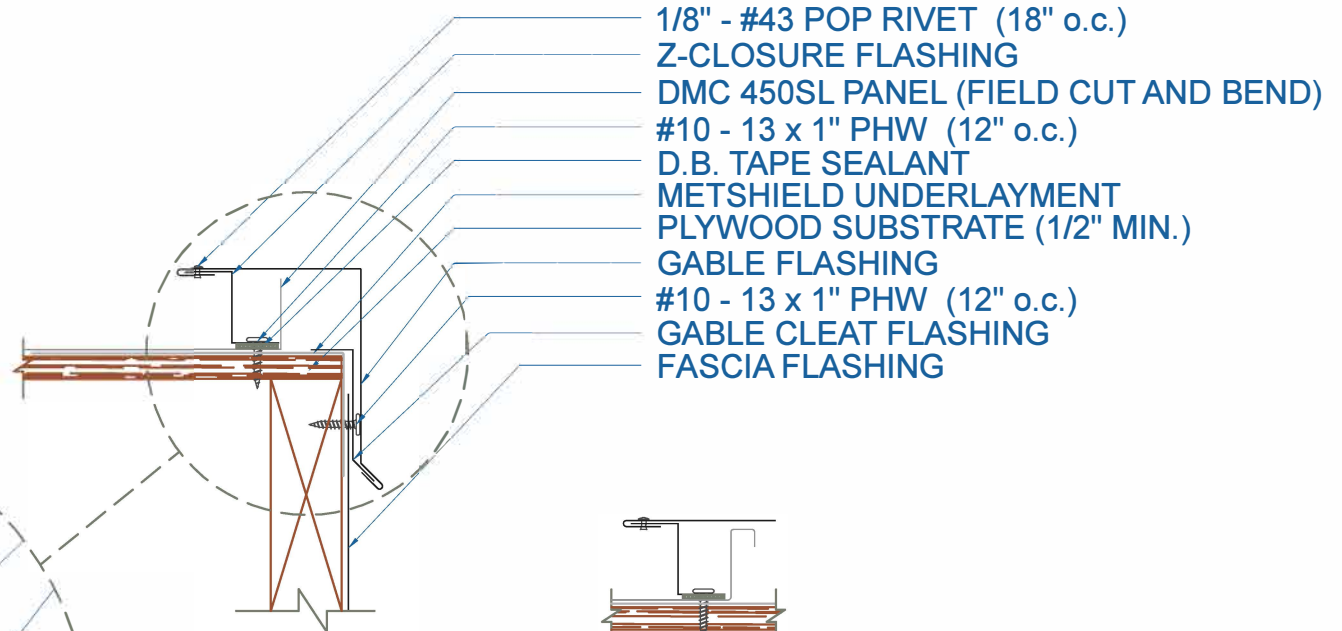

ON MODULE

EFFECTIVE DATE: 01-06-14  
SUBJECT TO CHANGE WITHOUT NOTICE

**GABLE**  
SCALE: 3" = 1'-0"

**Drexel Metals**  
Roofing Systems + Custom Fabrication



# DMC 450SL - PLYWOOD

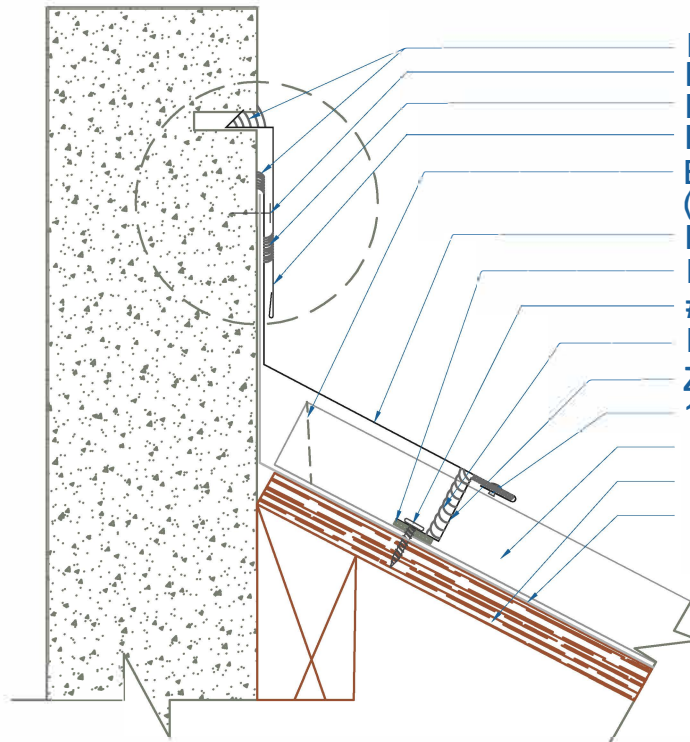

- DREXEL APPROVED TUBE SEALANT
- FASTENERS (BY OTHERS)
- DREXEL APPROVED TUBE SEALANT
- REGLET FLASHING
- BOX END OF PANEL  
(SEE ZEE CLOSURE OPTIONS DETAIL)
- HEADWALL FLASHING
- D.B. TAPE SEALANT
- #10 - 13 x 1" PHW (5 PER PANEL)
- DREXEL APPROVED TUBE SEALANT
- Z-CLOSURE FLASHING
- 1/8" - #43 POP RIVET (18" o.c.)
- DMC 450SL PANEL
- PLYWOOD SUBSTRATE (1/2" MIN.)
- METSHIELD UNDERLAYMENT

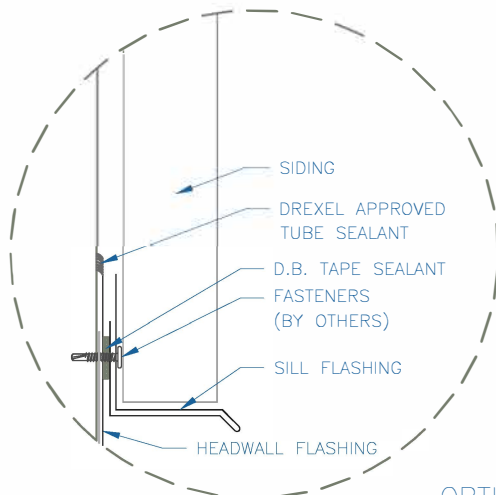

OPTION 1

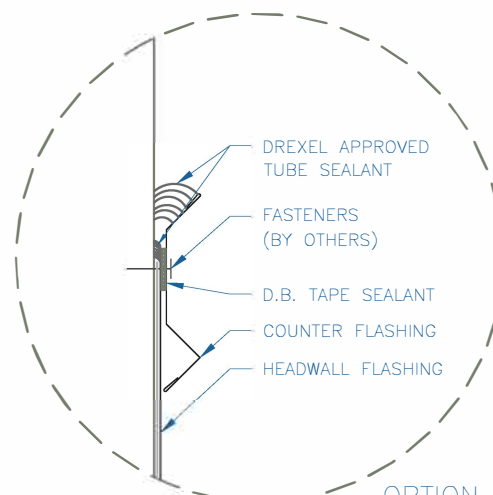

OPTION 2

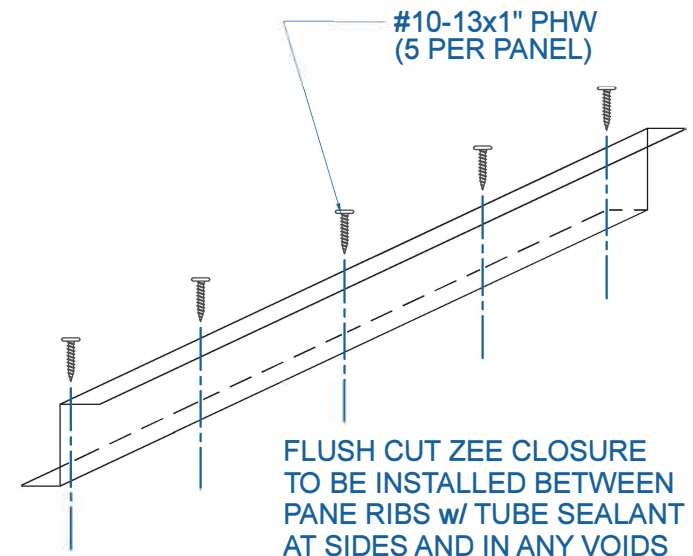

EFFECTIVE DATE: 01-06-14  
SUBJECT TO CHANGE WITHOUT NOTICE

## HEADWALL

SCALE: 3" = 1'-0"



# DMC 450SL - PLYWOOD

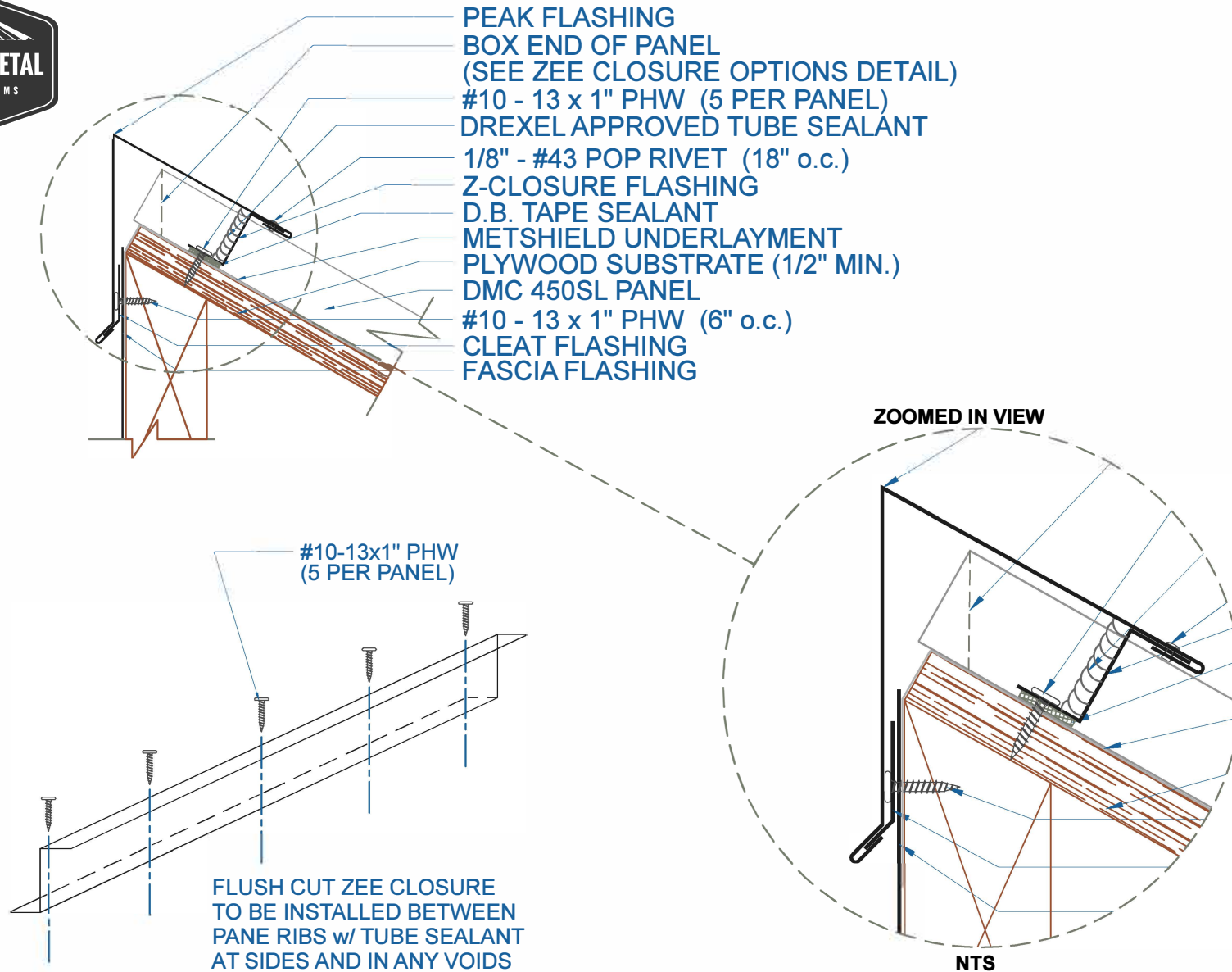

EFFECTIVE DATE: 01-06-14  
 SUBJECT TO CHANGE WITHOUT NOTICE

**PEAK**  
 SCALE: 3" = 1'-0"

**Drexel Metals**  
 Roofing Systems + Custom Fabrication



# DMC 450SL - PLYWOOD

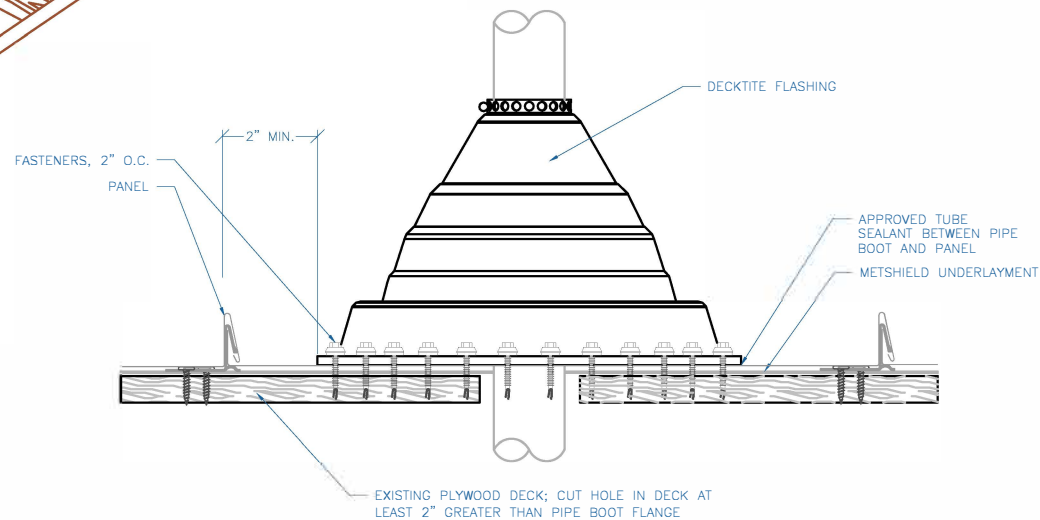
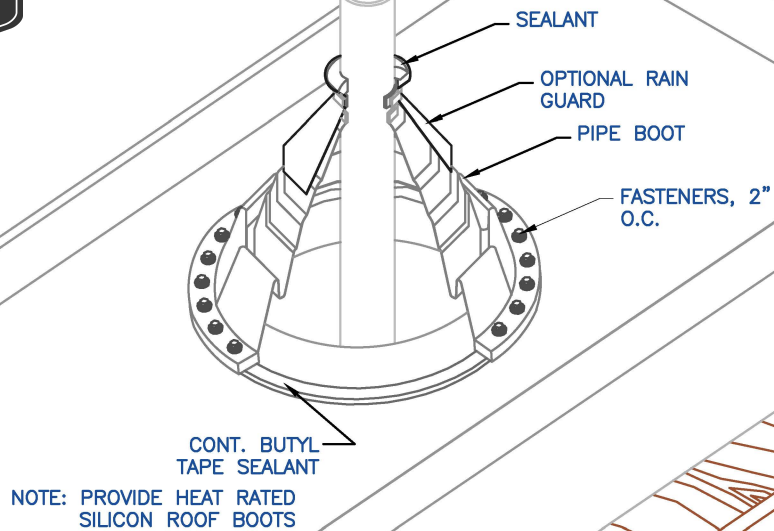

## PIPE FLASHING DETAIL

SCALE: NTS

EFFECTIVE DATE: 01-06-2014  
SUBJECT TO CHANGE WITHOUT NOTICE

**Drexel Metals**  
Roofing Systems + Custom Fabrication





# DMC 450SL - PLYWOOD

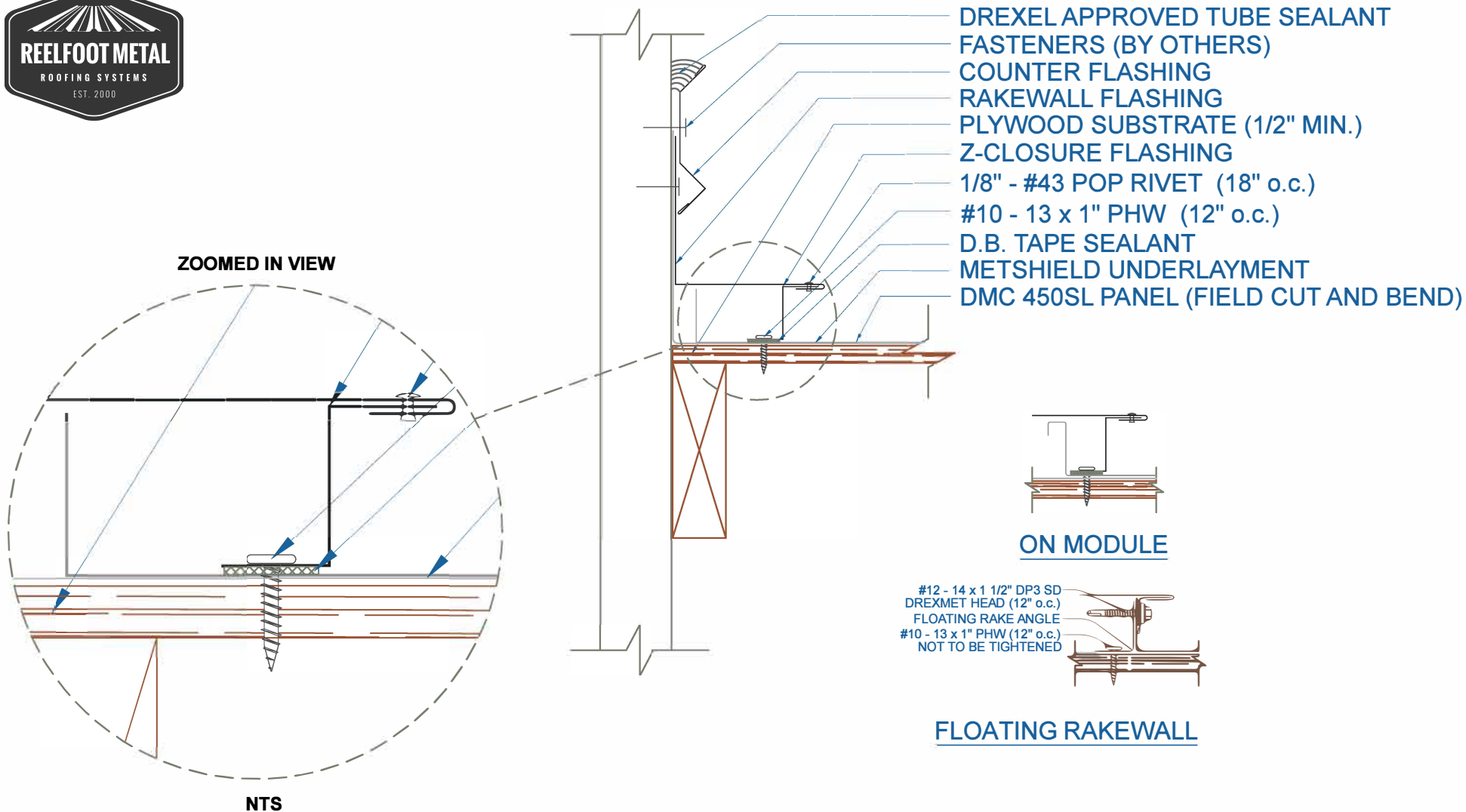

EFFECTIVE DATE: 01-06-14  
SUBJECT TO CHANGE WITHOUT NOTICE

**RAKEWALL**  
SCALE: 3" = 1'-0"

**DrexelMetals**  
Roofing Systems + Custom Fabrication

# DMC 450SL - PLYWOOD

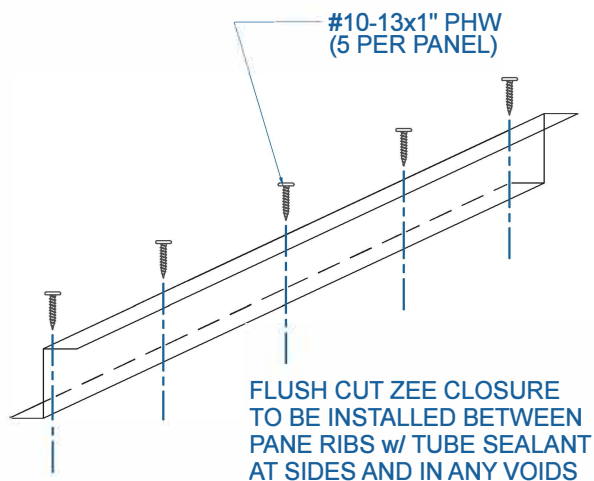
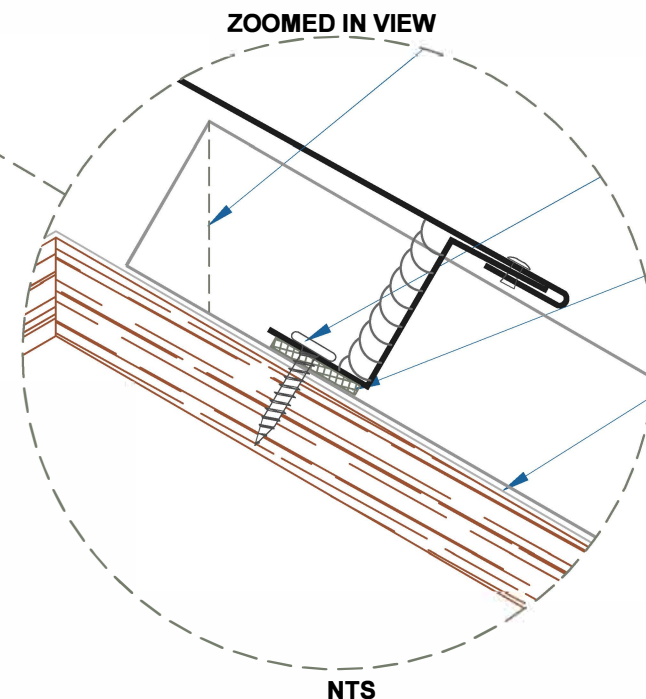
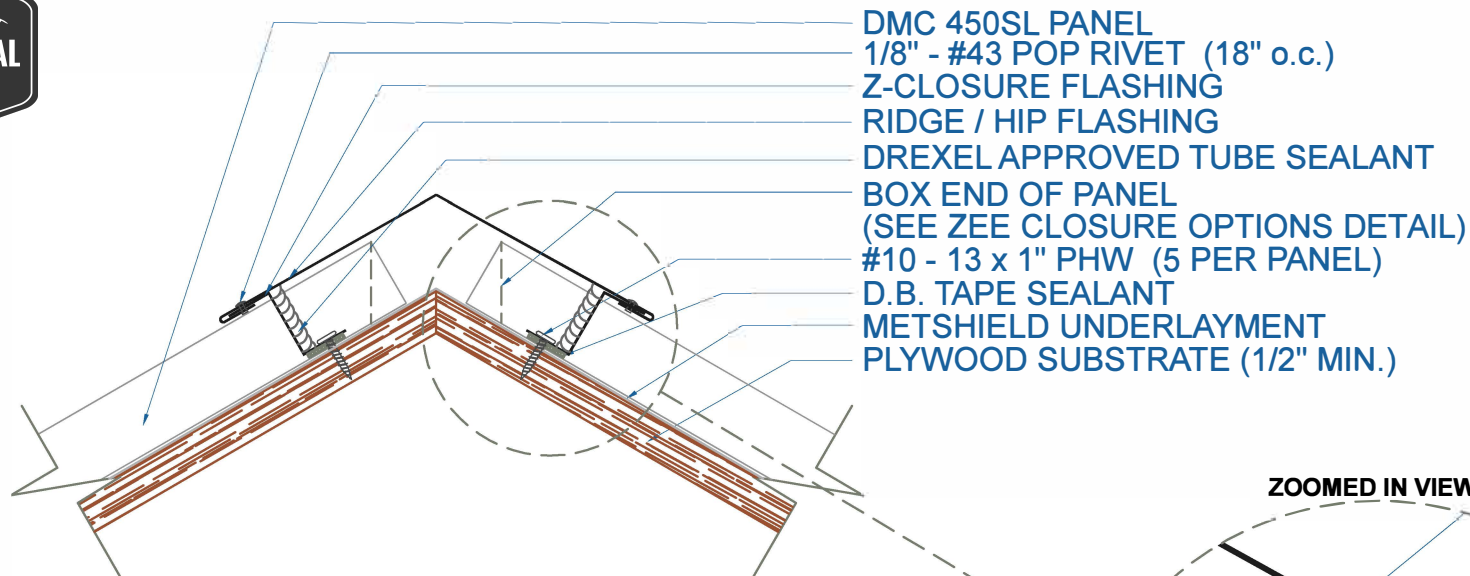

EFFECTIVE DATE: 01-06-14  
SUBJECT TO CHANGE WITHOUT NOTICE

**RIDGE / HIP**  
SCALE: 3" = 1'-0"

**Drexel Metals**  
Roofing Systems + Custom Fabrication

# DMC 450SL - PLYWOOD



- DMC 450SL PANEL
- #10 - 13 x 1" PHW (12" o.c.)
- D.B. TAPE SEALANT
- OFFSET CLEAT FLASHING
- FIELD CUT & HEM PANEL 180°
- BOX END OF PANEL  
(SEE ZEE CLOSURE OPTIONS DETAIL)
- TRANSITION FLASHING
- 1/8" - #43 POP RIVET (18" o.c.)
- Z-CLOSURE
- #10 - 13 x 1" PHW (5 PER PANEL)
- D.B. TAPE SEALANT
- PLYWOOD SUBSTRATE (1/2" MIN.)
- DMC 450SL PANEL
- METSHIELD UNDERLAYMENT

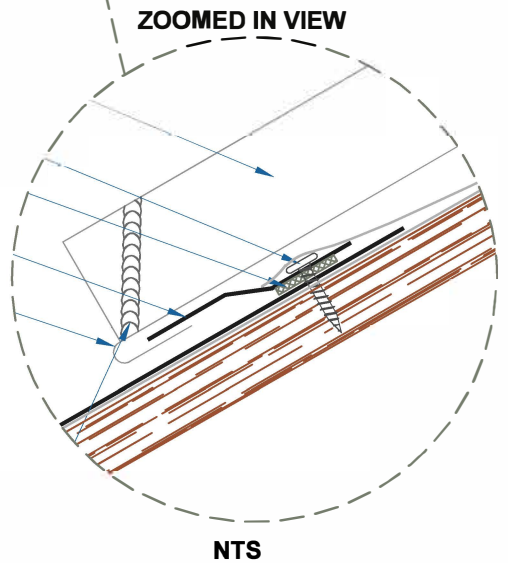
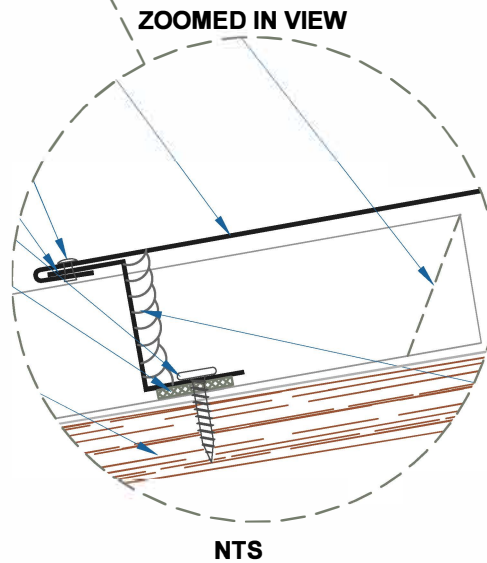
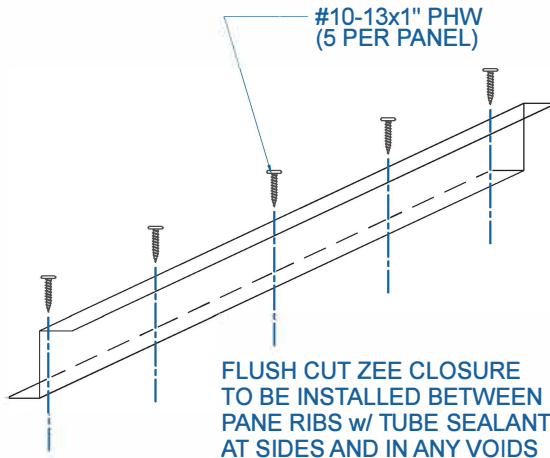
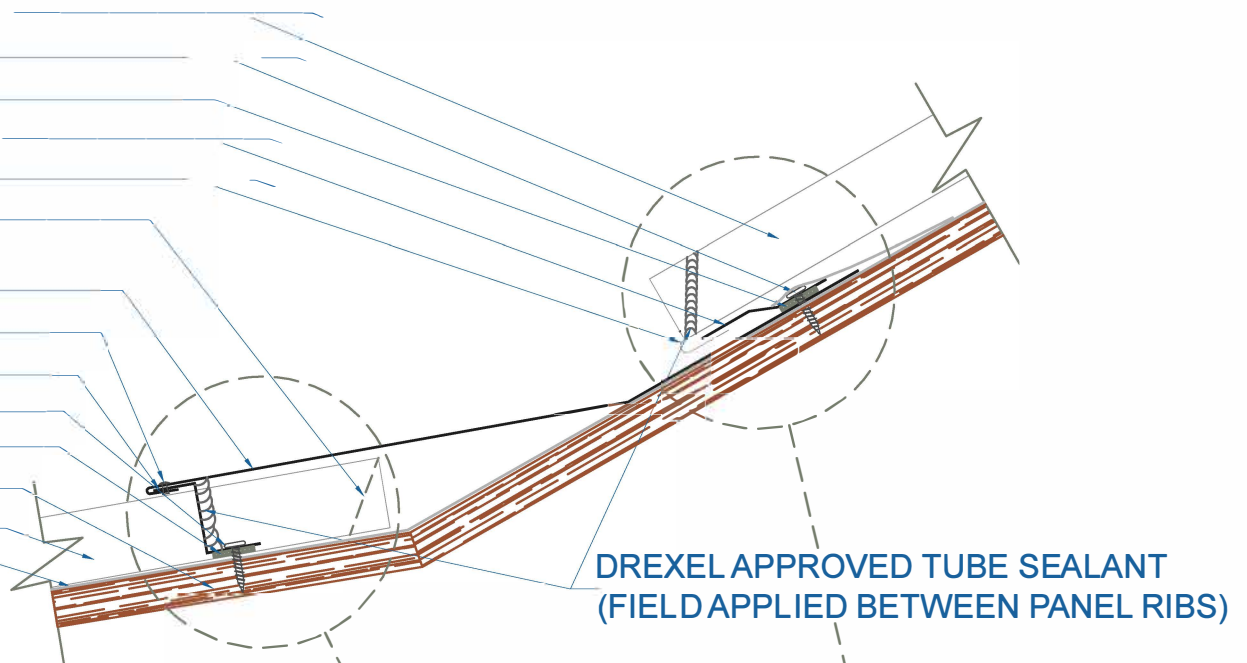

## TRANSITION

SCALE: 3" = 1'-0"

EFFECTIVE DATE: 01-06-14  
SUBJECT TO CHANGE WITHOUT NOTICE



# DMC 450SL - PLYWOOD



ZOOMED IN VIEW

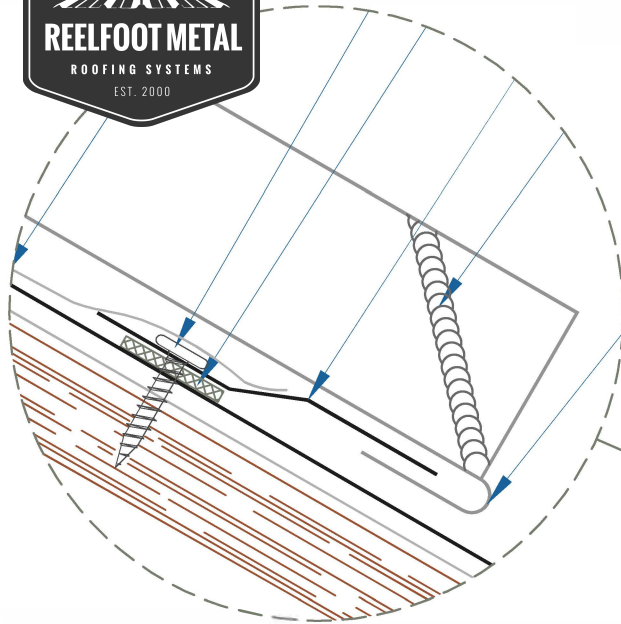

NTS

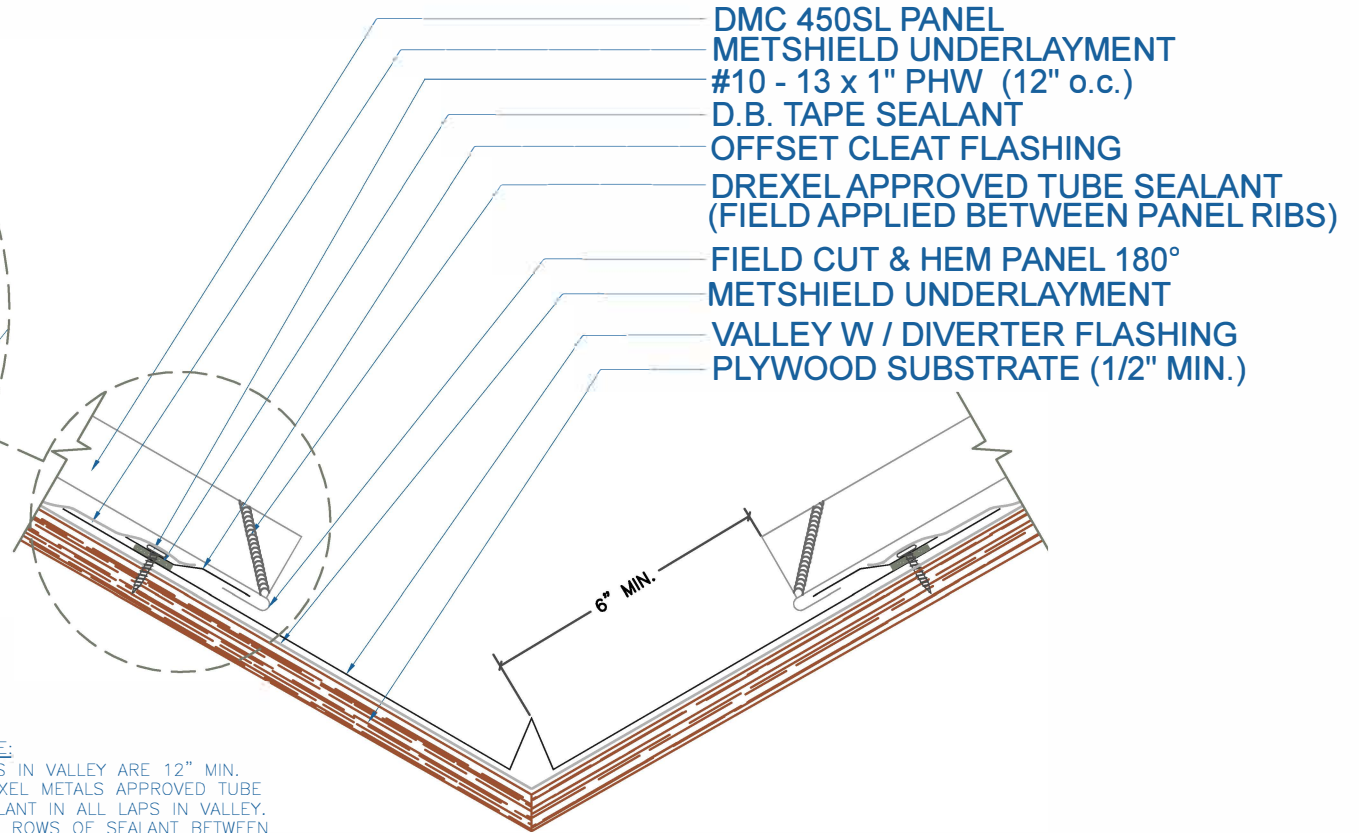

- NOTE:
- 1.) LAPS IN VALLEY ARE 12" MIN.  
DREXEL METALS APPROVED TUBE SEALANT IN ALL LAPS IN VALLEY.  
TWO ROWS OF SEALANT BETWEEN VALLEY LAPS, 4" UP FROM LAP.
  - 2.) LARGE ROOF AREAS MAY REQUIRE A LARGER GAP BETWEEN PANEL AND DIVERTER TO ALLOW FOR STORM WATER RUN OFF.

## VALLEY W / DIVERTER

SCALE: 3" = 1'-0"

**DrexelMetals**  
Roofing Systems + Custom Fabrication

EFFECTIVE DATE: 01-06-14  
SUBJECT TO CHANGE WITHOUT NOTICE

# DMC 450SL - PLYWOOD



ZOOMED IN VIEW

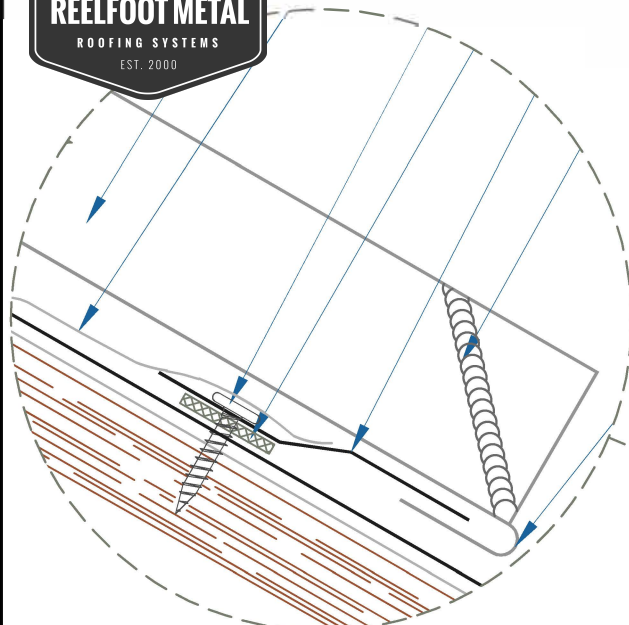

NTS

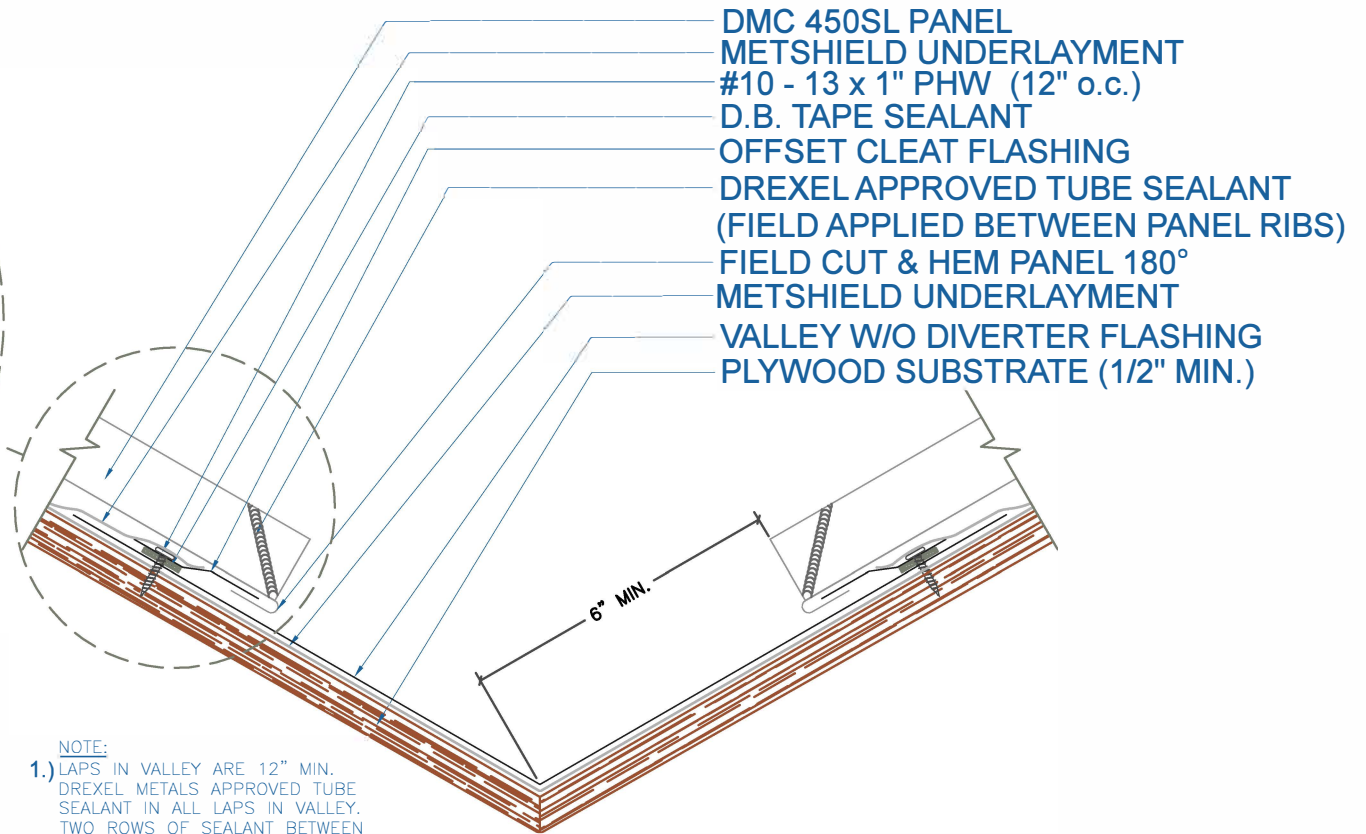

## NOTE:

- 1.) LAPS IN VALLEY ARE 12" MIN.  
DREXEL METALS APPROVED TUBE SEALANT IN ALL LAPS IN VALLEY.  
TWO ROWS OF SEALANT BETWEEN VALLEY LAPS, 4" UP FROM LAP.
- 2.) LARGE ROOF AREAS MAY REQUIRE A LARGER GAP BETWEEN PANEL AND DIVERTER TO ALLOW FOR STORM WATER RUN OFF.

## VALLEY W/O DIVERTER

**Drexel Metals**  
Roofing Systems + Custom Fabrication

EFFECTIVE DATE: 01-06-14  
SUBJECT TO CHANGE WITHOUT NOTICE

SCALE: 3" = 1'-0"



# DMC 450SL - PLYWOOD



## NOTE:

- 1.) LAPS IN VALLEYWALL ARE 12" MIN. DREXEL METALS APPROVED SEALANT IN ALL LAPS IN VALLEY. TWO ROWS OF SEALANT BETWEEN VALLEYWALL LAPS, 4" UP FROM LAP.
- 2.) LARGE ROOF AREAS MAY REQUIRE A LARGER GAP BETWEEN PANEL AND WALL TO ALLOW FOR STORM WATER RUN OFF.

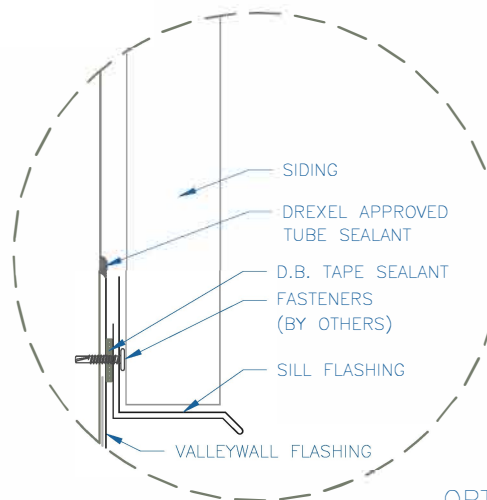
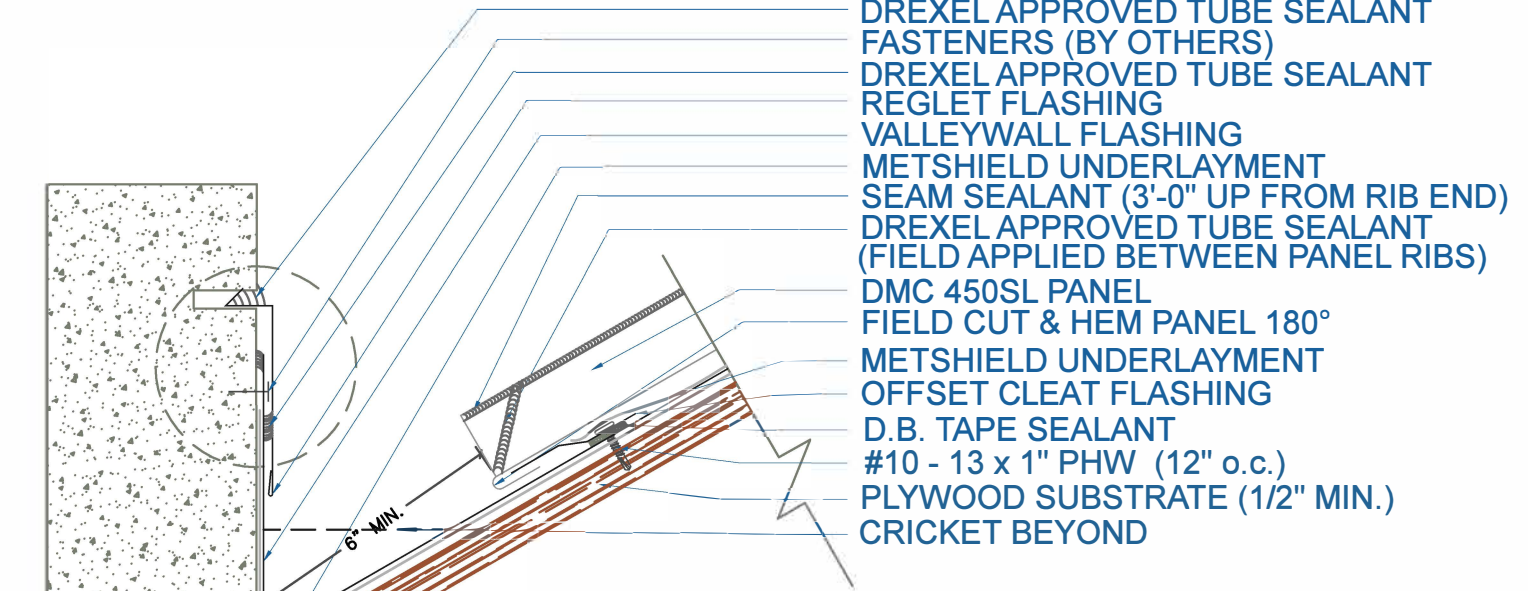

OPTION 1

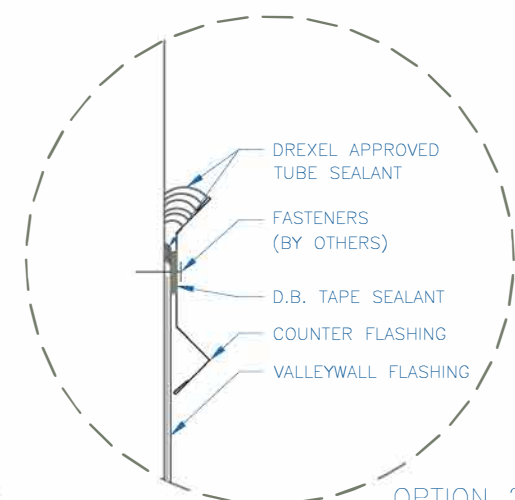

OPTION 2

## VALLEYWALL

SCALE: 3" = 1'-0"

EFFECTIVE DATE: 01-06-14  
SUBJECT TO CHANGE WITHOUT NOTICE





# DMC 450SL - PLYWOOD

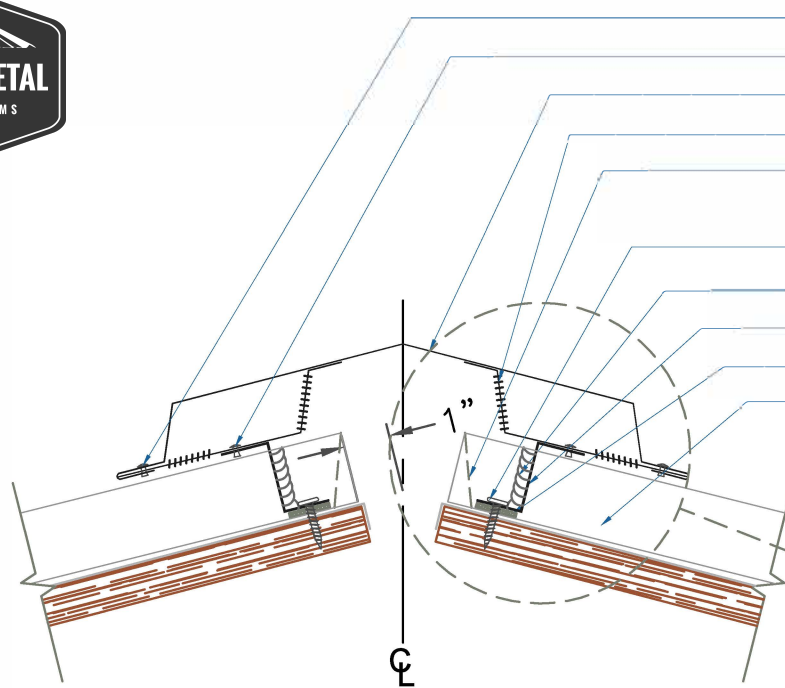

- 1/8" - #43 POP RIVET (18" o.c.)
- 1/8" - #43 POP RIVET (3 PER PANEL)
- VENTED RIDGE FLASHING
- PERFORATED Z SUPPORT FLASHING
- BOX END OF PANEL  
(SEE ZEE CLOSURE OPTIONS DETAIL)
- #10 - 13 x 1" PHW (5 PER PANEL)
- DREXEL APPROVED TUBE SEALANT
- Z-CLOSURE FLASHING
- D.B. TAPE SEALANT
- DMC 450SL PANEL

NOTE:  
1.) NET FREE AREA = 6.16 SQ IN/FT

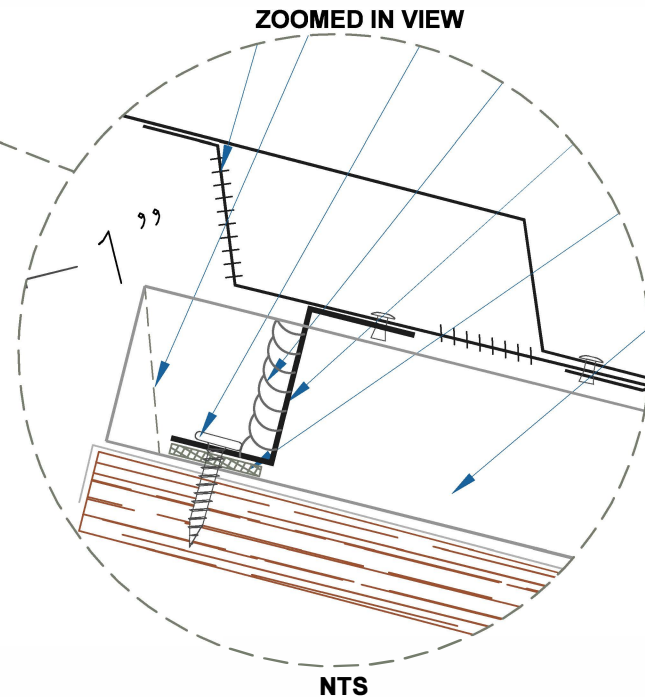
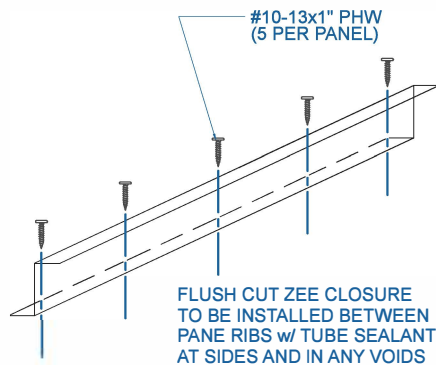

EFFECTIVE DATE: 01-06-14  
SUBJECT TO CHANGE WITHOUT NOTICE

## VENTED RIDGE / HIP

SCALE: 3" = 1'-0"

**DrexelMetals**  
Roofing Systems + Custom Fabrication

