

# DMC 200S - SOLID SUBSTRATE

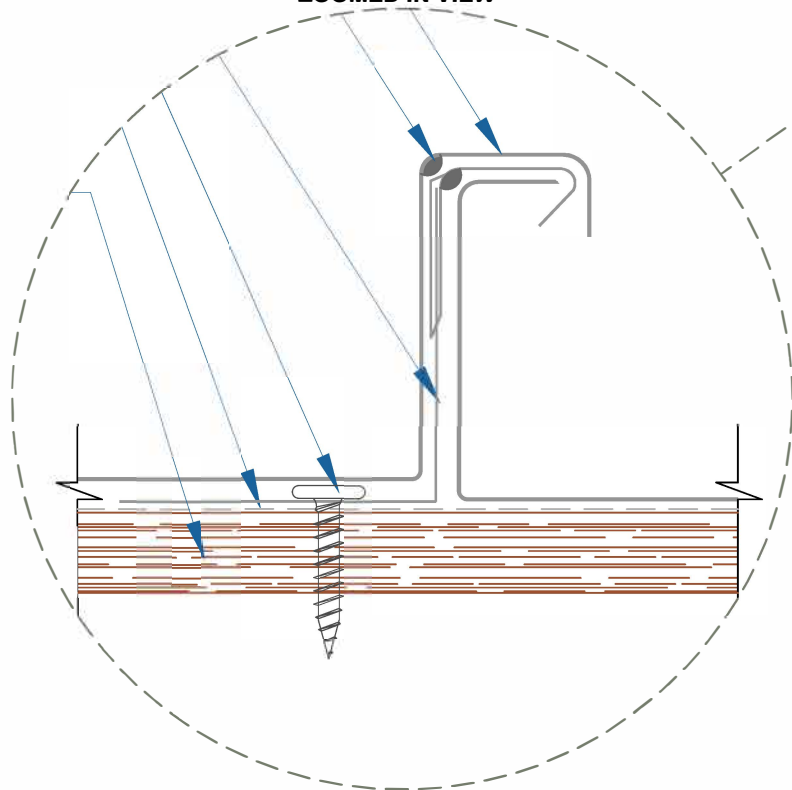

DMC 200S PANEL  
DREXEL APPROVED SEALANT (OPTIONAL)  
(FIELD OR MACHINE APPLIED SEALANT)  
DMC 200S BUTTERFLY CLIP  
(2) #10 - 13 x 1" PHW  
METSHIELD UNDERLAYMENT  
1/2" PLYWOOD MIN.

ZOOMED IN VIEW



NTS

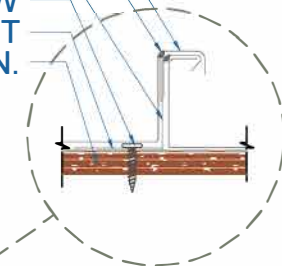

CROSS SECTION  
BEFORE SEAMING

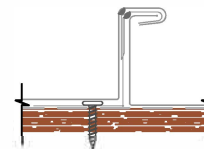

CROSS SECTION  
90° SEAMING

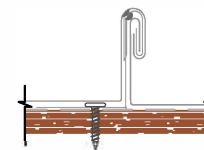

CROSS SECTION  
180° SEAMING

SEAMER TOOL RENTAL  
SEAMER TOOLS, INC.  
8265 HIGHWAY 178  
OLIVE BRANCH, MS 38654  
PH:(662)895-1222  
FAX:(662)890-4775  
RENT@SEAMERTOOLS.COM

EFFECTIVE DATE: 12-07-12  
SUBJECT TO CHANGE WITHOUT NOTICE

## INSTALLATION DETAIL

SCALE: 3" = 1'-0"



# DMC 200S - PLYWOOD



ZOOMED IN VIEW

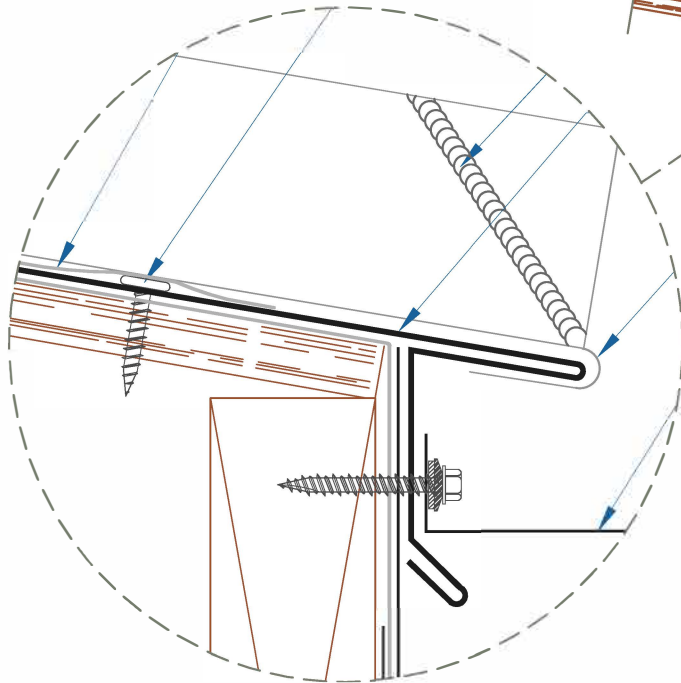

NTS

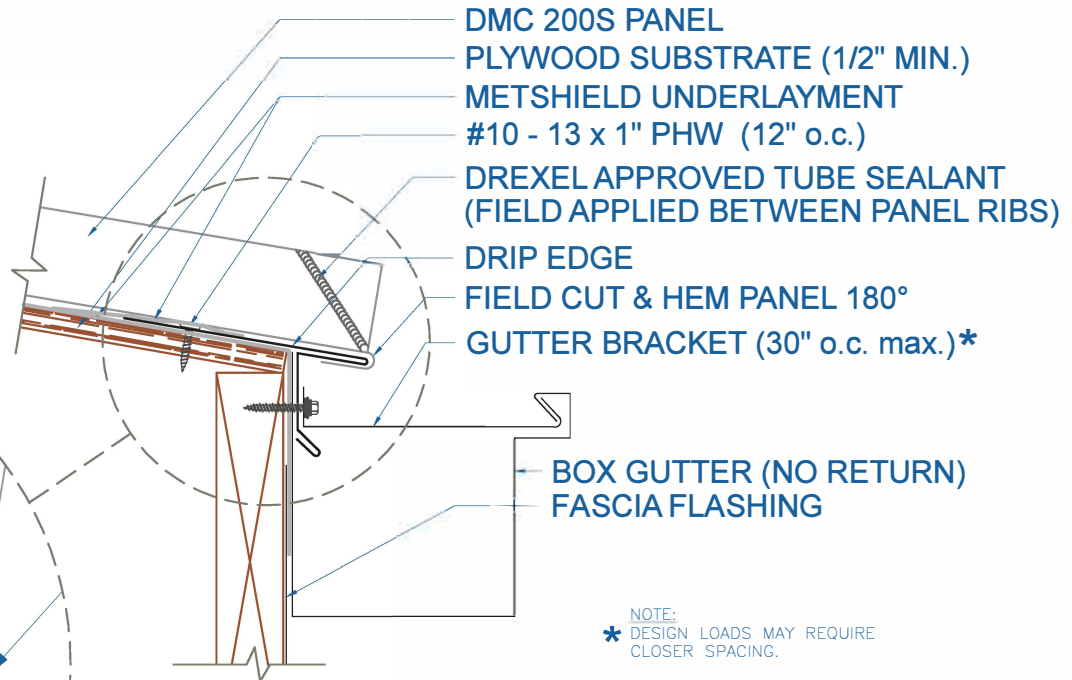

## BOX GUTTER w/DRIP EDGE

SCALE: 3" = 1'-0"

EFFECTIVE DATE: 01-04-13  
SUBJECT TO CHANGE WITHOUT NOTICE



# DMC 200S - PLYWOOD

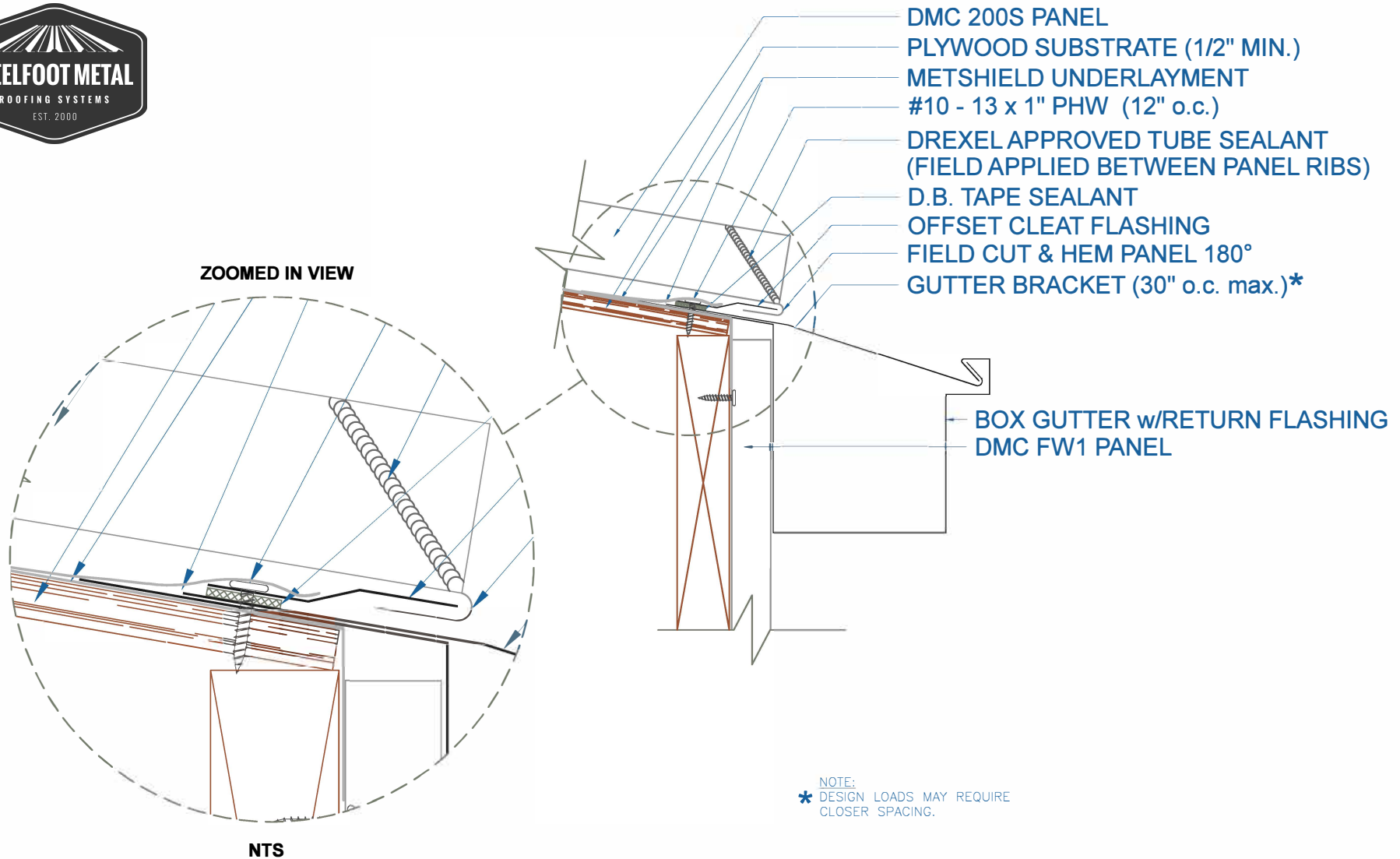

NOTE:  
\* DESIGN LOADS MAY REQUIRE  
CLOSER SPACING.

## BOX GUTTER w/RETURN

SCALE: 3" = 1'-0"

EFFECTIVE DATE: 4-18-13  
SUBJECT TO CHANGE WITHOUT NOTICE



# DMC 200S - PLYWOOD

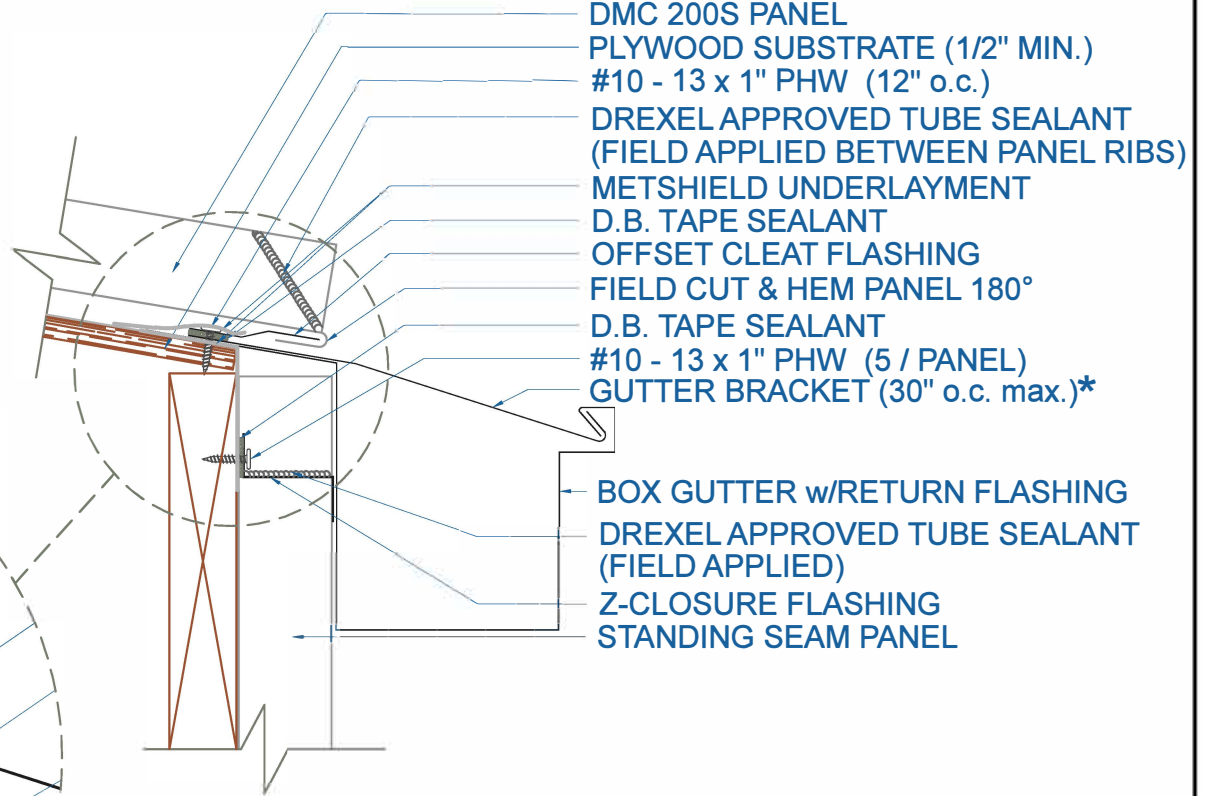
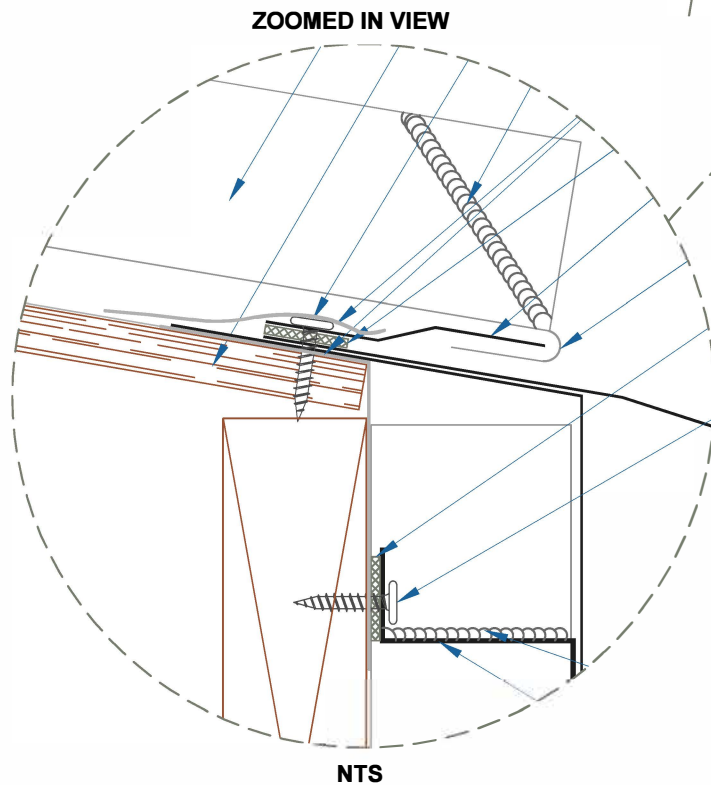

NOTE:  
 \* DESIGN LOADS MAY REQUIRE  
 CLOSER SPACING.

## BOX GUTTER w/RETURN w/STANDING SEAM PANEL

SCALE: 3" = 1'-0"

EFFECTIVE DATE: 12-07-12  
 SUBJECT TO CHANGE WITHOUT NOTICE





## DMC 200S - PLYWOOD

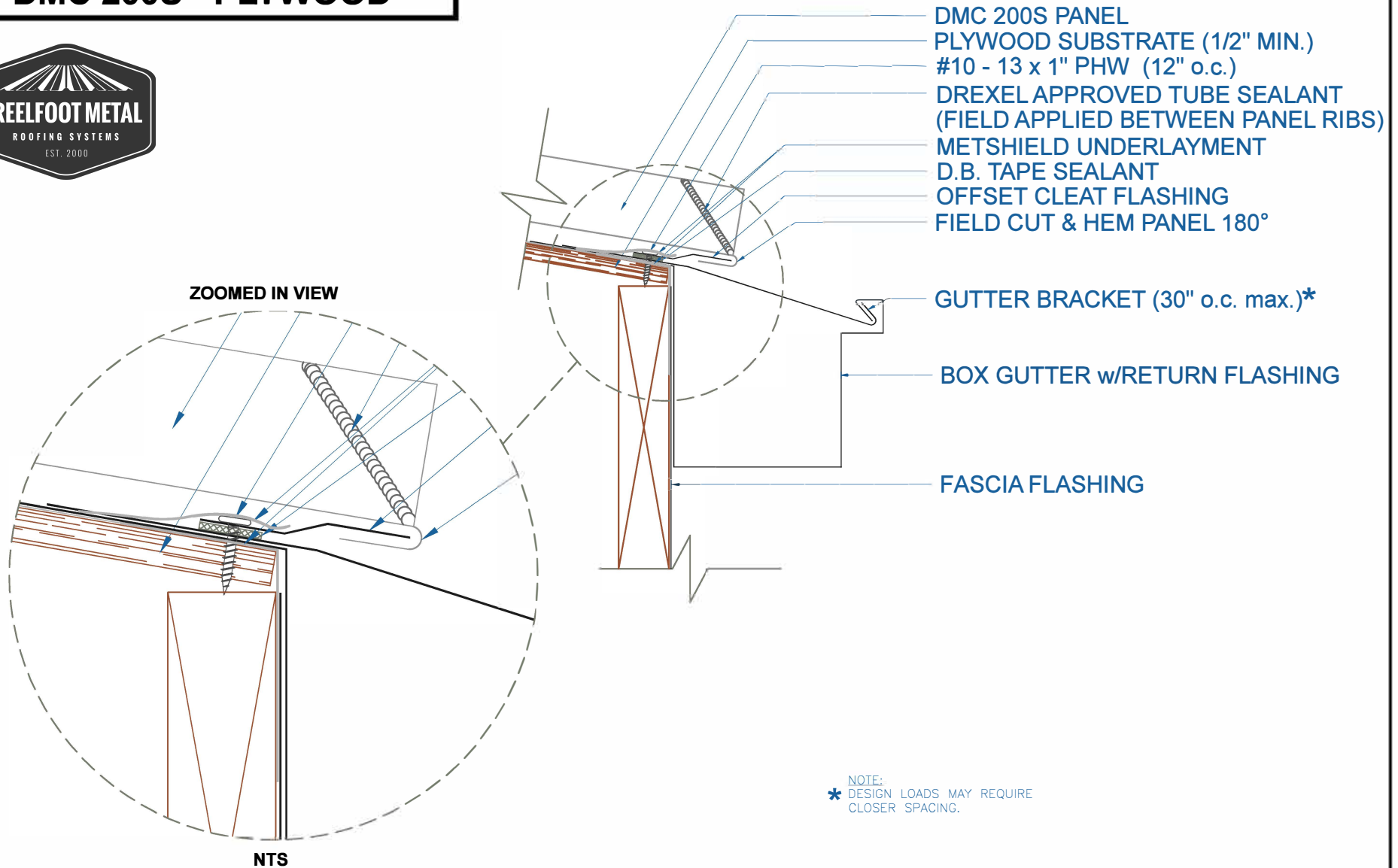

\* NOTE:  
DESIGN LOADS MAY REQUIRE  
CLOSER SPACING.

## BOX GUTTER w/RETURN

SCALE: 3" = 1'-0"

EFFECTIVE DATE: 12-07-12  
SUBJECT TO CHANGE WITHOUT NOTICE

**Drexel Metals**  
Roofing Systems + Custom Fabrication



## DMC 200S - PLYWOOD

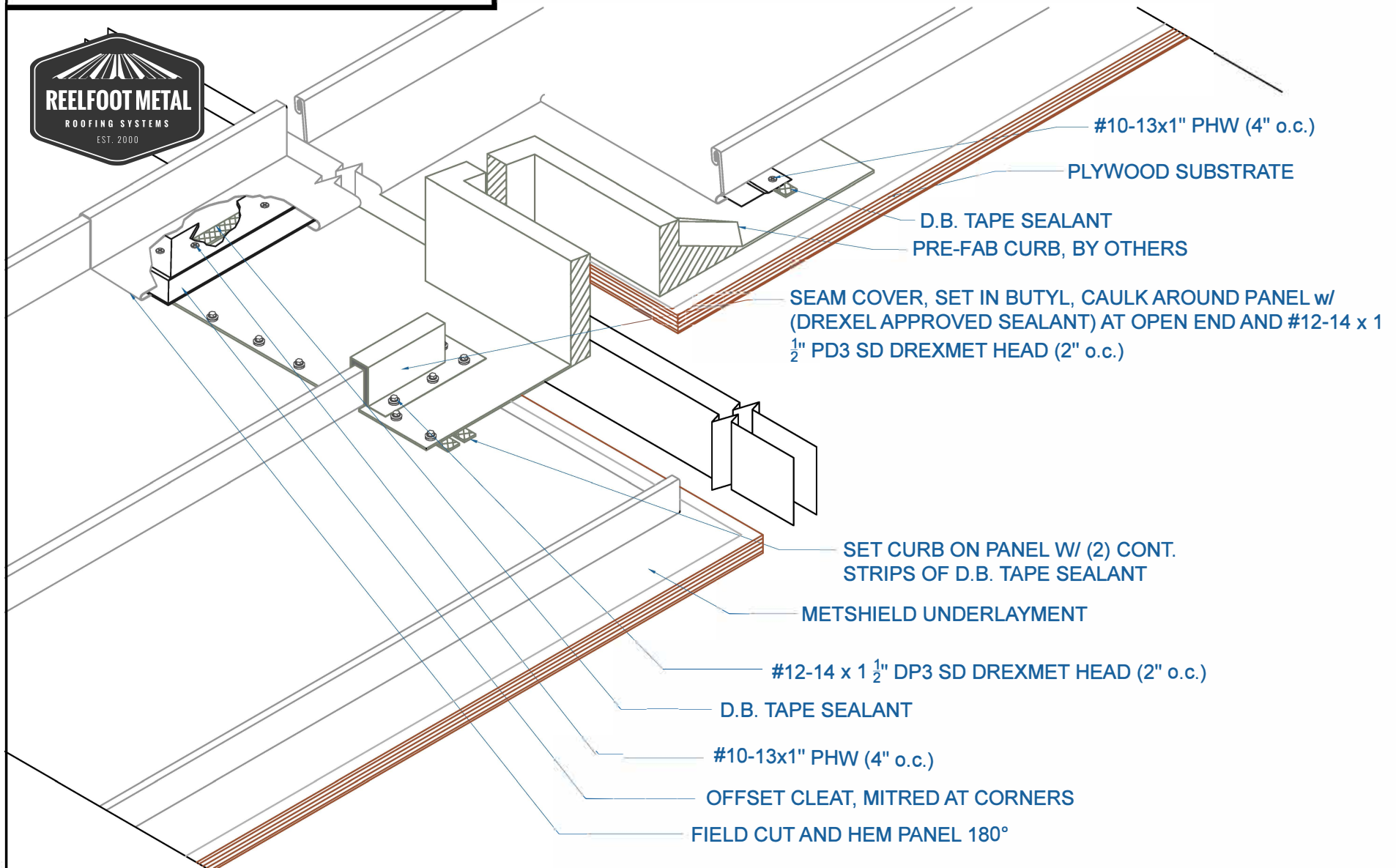

EFFECTIVE DATE: 01-18-2013  
SUBJECT TO CHANGE WITHOUT NOTICE

## CURB DETAIL

SCALE: NTS

**Drexel Metals**  
Roofing Systems + Custom Fabrication



# DMC 200S - PLYWOOD

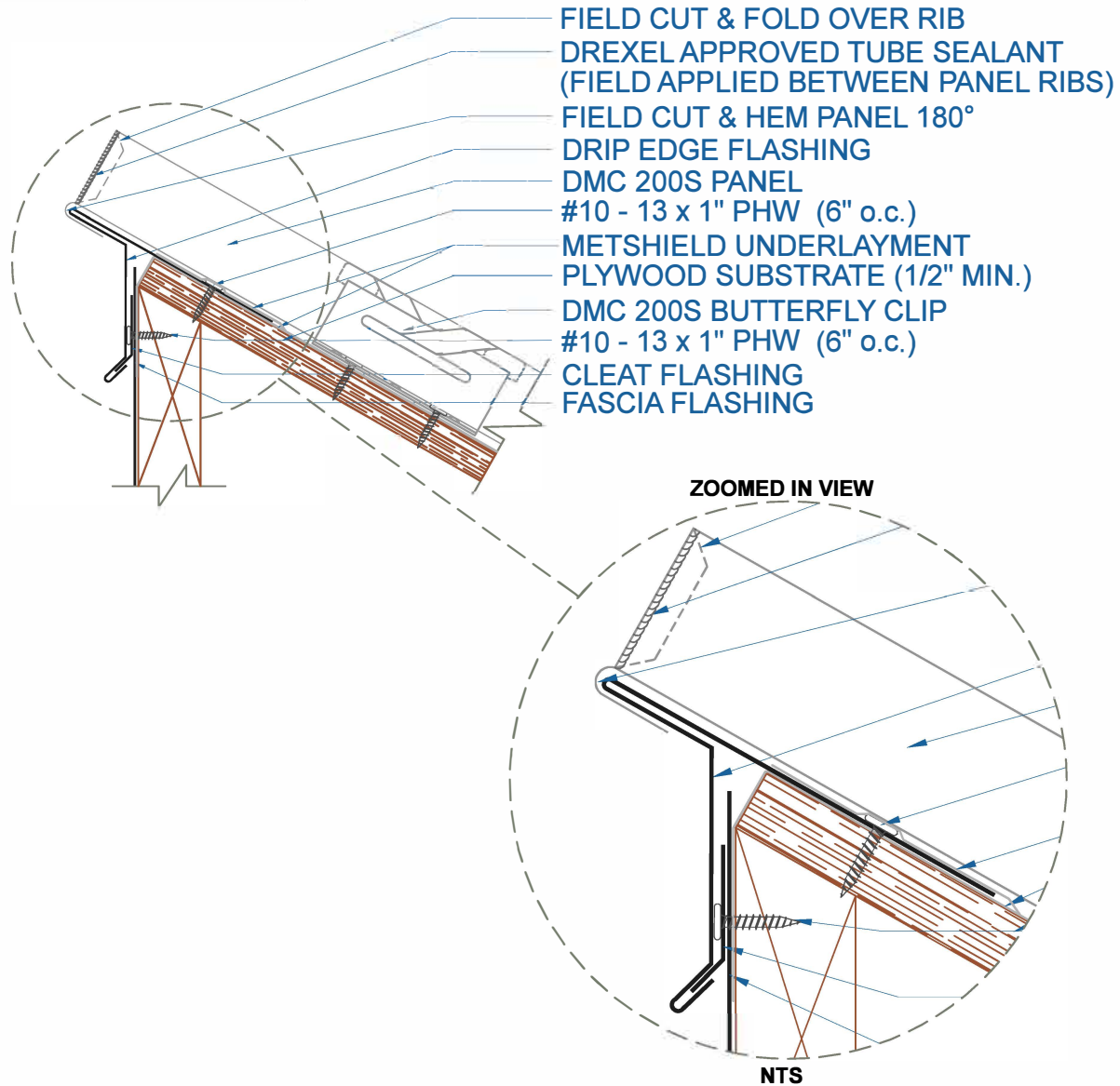

EFFECTIVE DATE: 12-07-12  
SUBJECT TO CHANGE WITHOUT NOTICE

## PEAK w/DRIP EDGE

SCALE: 3" = 1'-0"

**DrexelMetals**  
Roofing Systems + Custom Fabrication



# DMC 200S - PLYWOOD

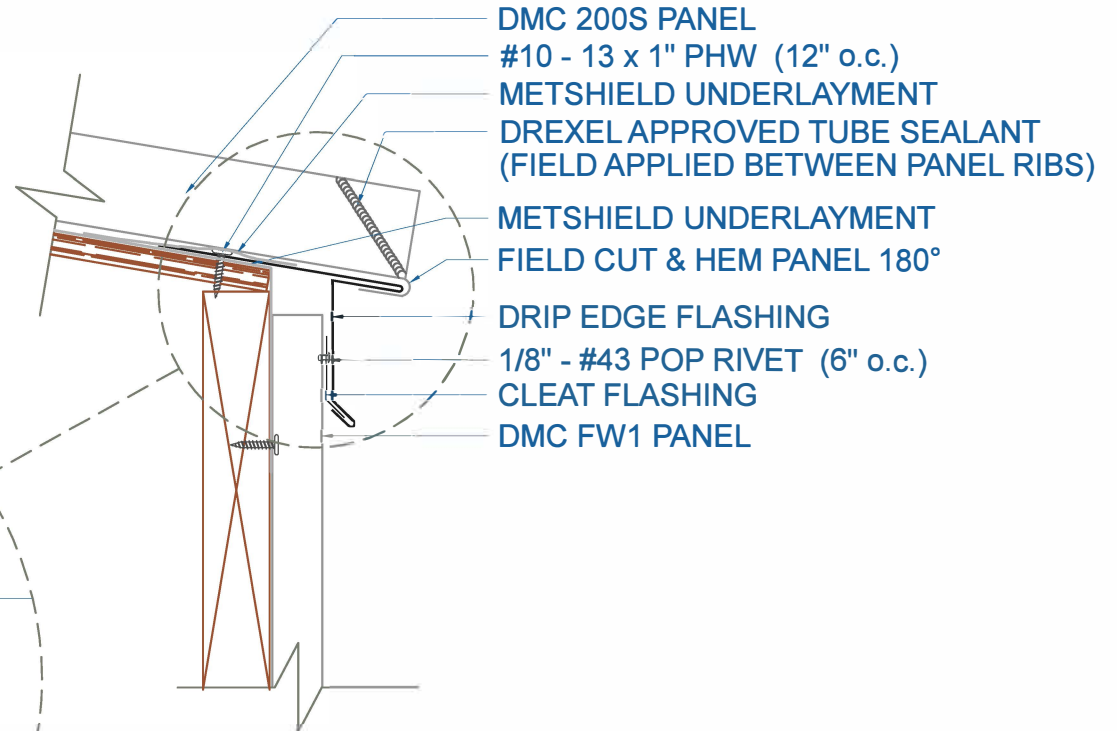
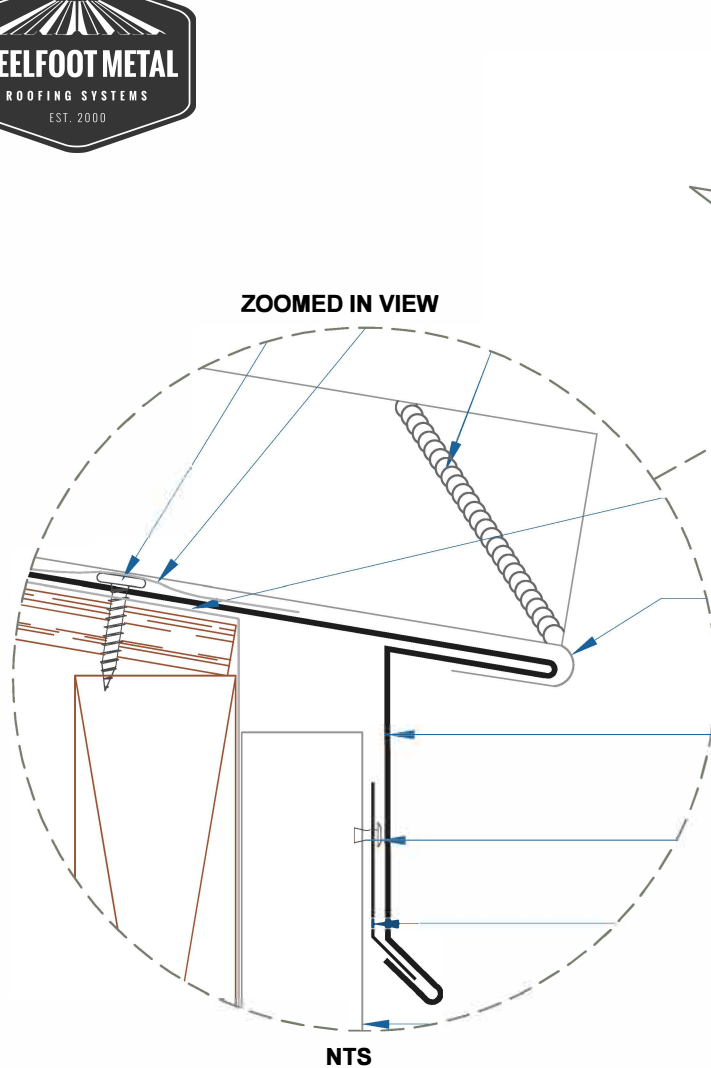

## DRIP EDGE w/FLUSH PANEL

SCALE: 3" = 1'-0"

EFFECTIVE DATE: 12-11-12  
SUBJECT TO CHANGE WITHOUT NOTICE

**DrexelMetals**  
Roofing Systems + Custom Fabrication



## DMC 200S - PLYWOOD

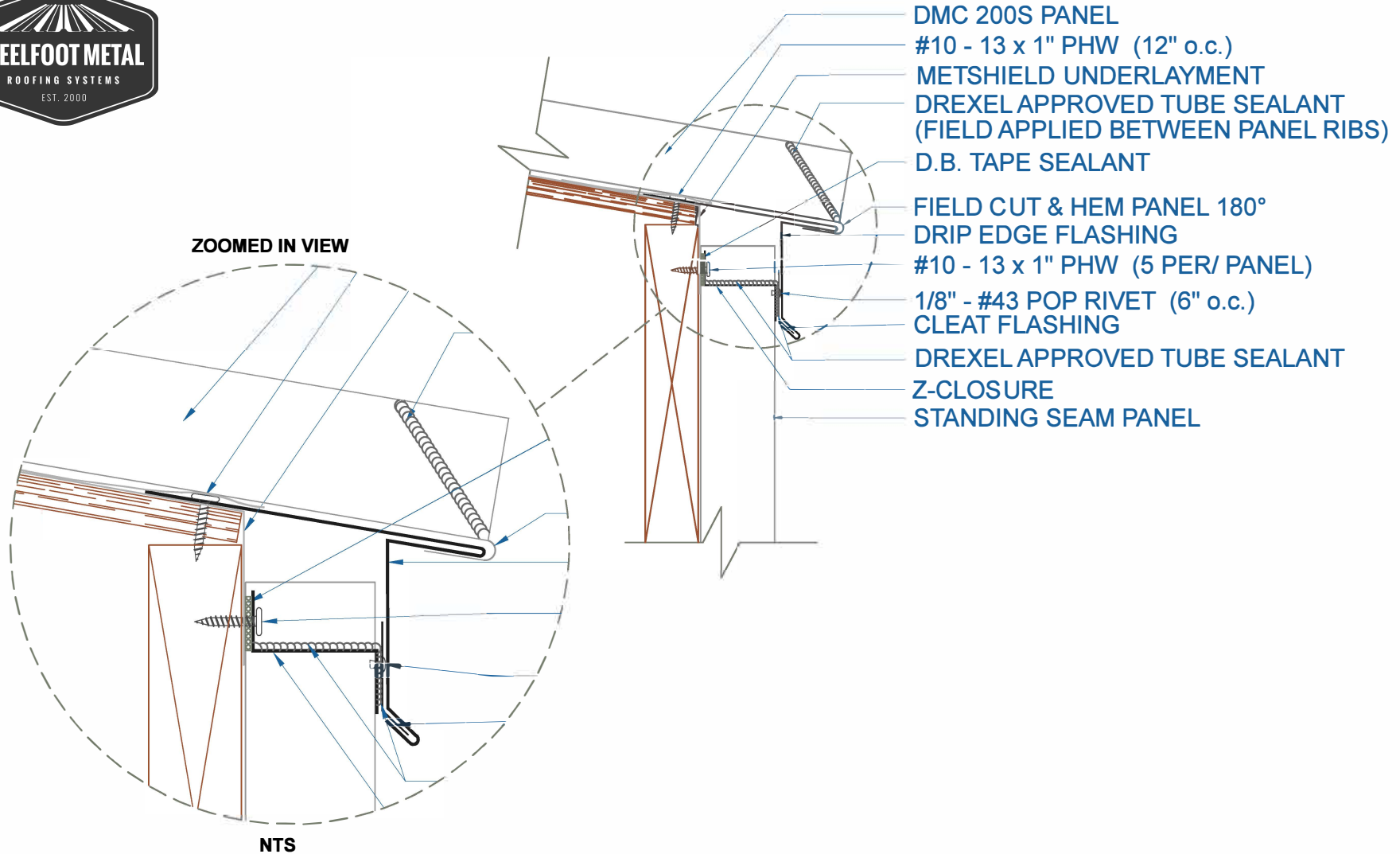

## DRIP EDGE w/STANDING SEAM PANEL

EFFECTIVE DATE: 12-07-12  
SUBJECT TO CHANGE WITHOUT NOTICE

SCALE: 3" = 1'-0"

**Drexel Metals**  
Roofing Systems + Custom Fabrication



# DMC 200S - PLYWOOD

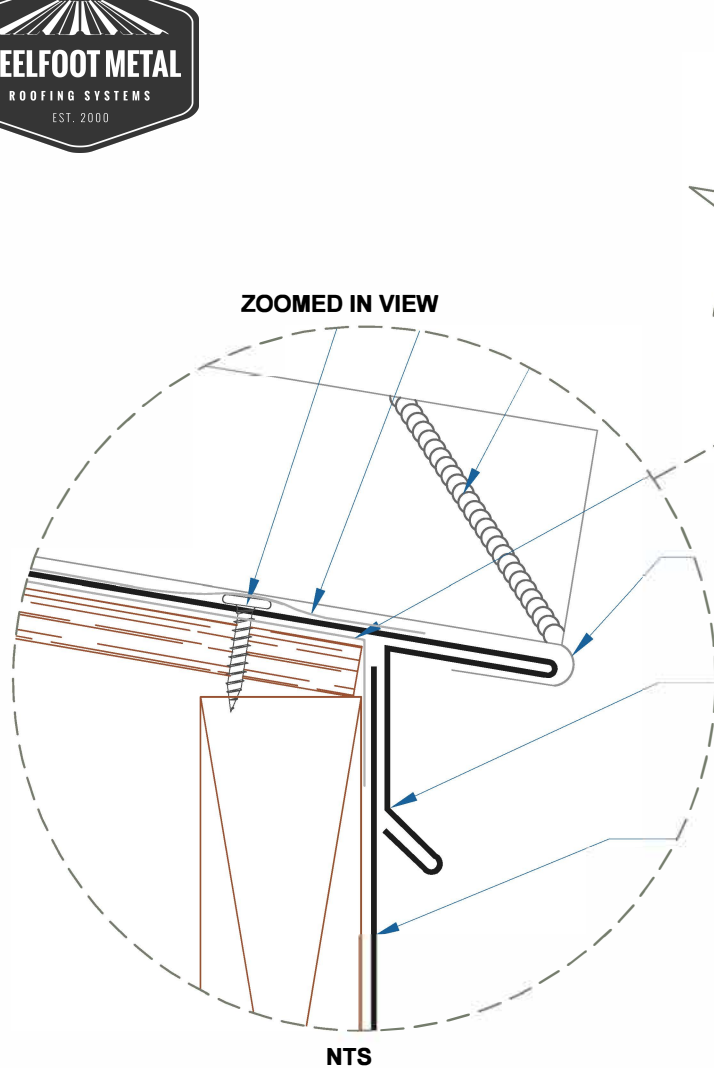

- DMC 200S PANEL
- #10 - 13 x 1" PHW (12" o.c.)
- METSHIELD UNDERLAYMENT
- DREXEL APPROVED TUBE SEALANT (FIELD APPLIED BETWEEN PANEL RIBS)
- METSHIELD UNDERLAYMENT
- FIELD CUT & HEM PANEL 180°
- DRIP EDGE FLASHING
- FASCIA FLASHING

EFFECTIVE DATE: 01-04-13  
SUBJECT TO CHANGE WITHOUT NOTICE

## DRIP EDGE

SCALE: 3" = 1'-0"





# DMC 200S - PLYWOOD



ZOOMED IN VIEW

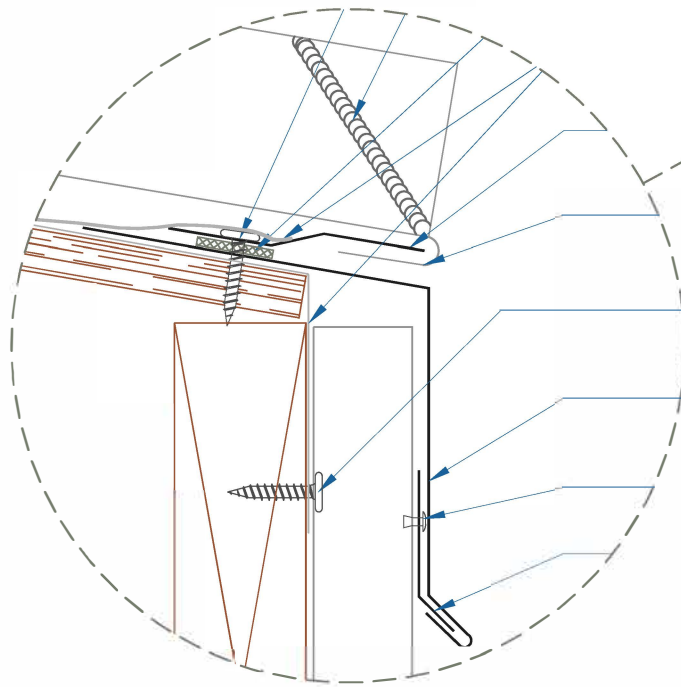

NTS

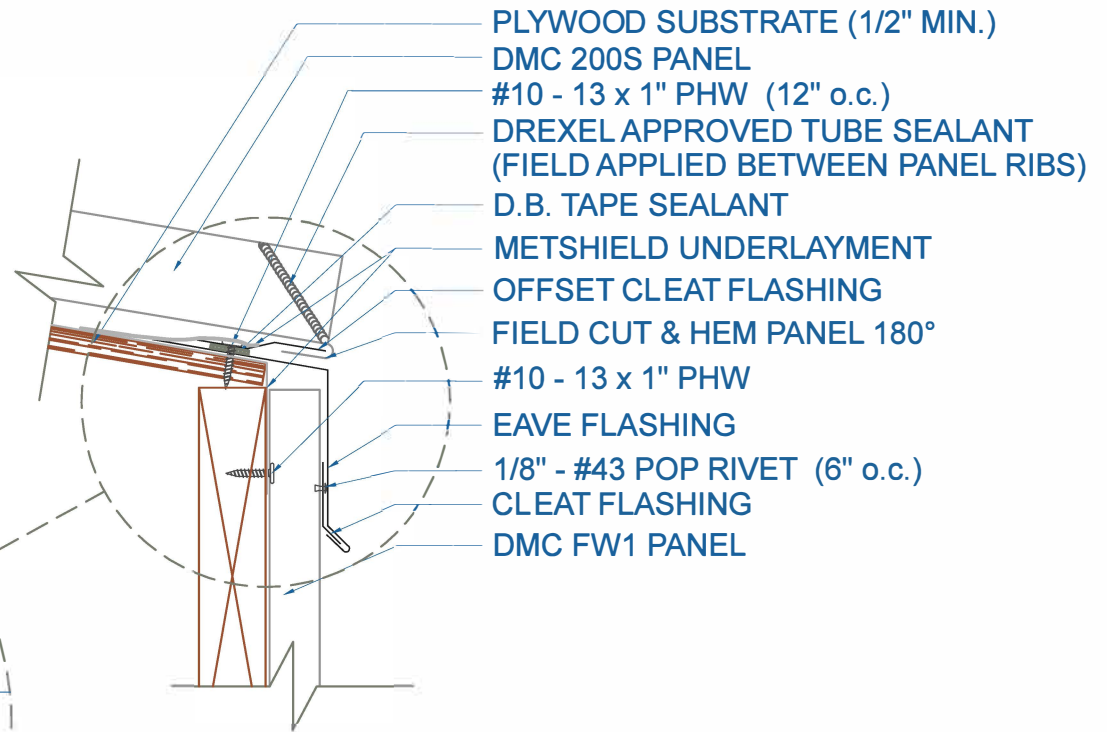

- PLYWOOD SUBSTRATE (1/2" MIN.)
- DMC 200S PANEL
- #10 - 13 x 1" PHW (12" o.c.)
- DREXEL APPROVED TUBE SEALANT (FIELD APPLIED BETWEEN PANEL RIBS)
- D.B. TAPE SEALANT
- METSHIELD UNDERLAYMENT
- OFFSET CLEAT FLASHING
- FIELD CUT & HEM PANEL 180°
- #10 - 13 x 1" PHW
- EAVE FLASHING
- 1/8" - #43 POP RIVET (6" o.c.)
- CLEAT FLASHING
- DMC FW1 PANEL

EFFECTIVE DATE:12-07-12  
SUBJECT TO CHANGE WITHOUT NOTICE

## EAVE w/FLUSH PANEL

SCALE: 3" = 1'-0"

**Drexel Metals**  
Roofing Systems + Custom Fabrication





# DMC 200S - PLYWOOD

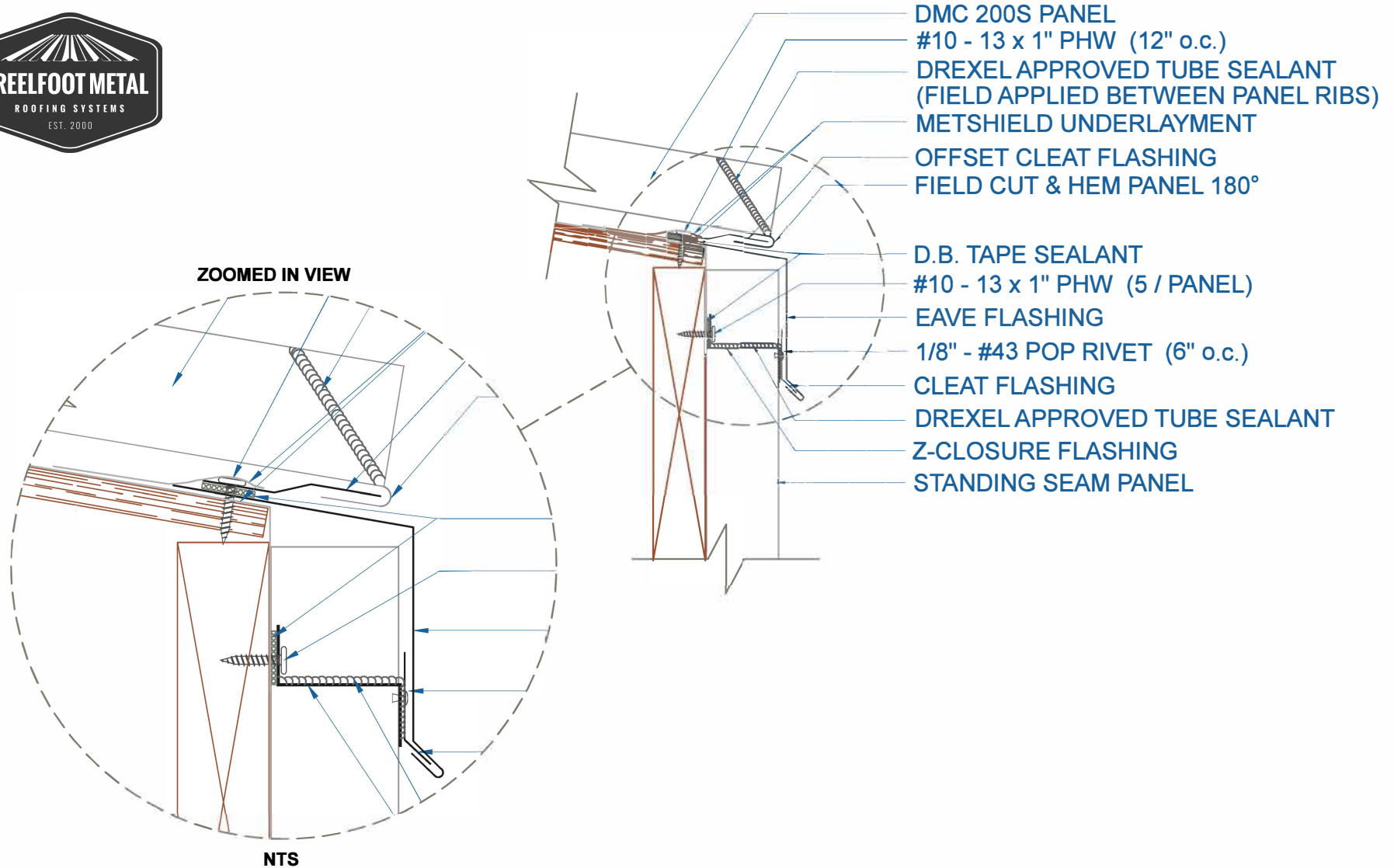

## EAVE w/STANDING SEAM PANEL

EFFECTIVE DATE: 12-07-12  
SUBJECT TO CHANGE WITHOUT NOTICE

SCALE: 3" = 1'-0"



# DMC 200S - PLYWOOD



- #10 - 13 x 1" PHW (12" o.c.)
- METSHIELD UNDERLAYMENT
- PLYWOOD SUBSTRATE (1/2" MIN.)
- DMC 200S PANEL (FIELD CUT AND BEND)
- #10 - 13 x 1" PHW (12" o.c.)
- DRIP EDGE FLASHING
- CLEAT FLASHING
- FASCIA FLASHING

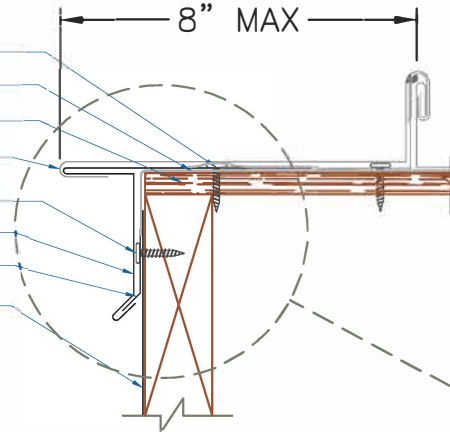

ZOOMED IN VIEW

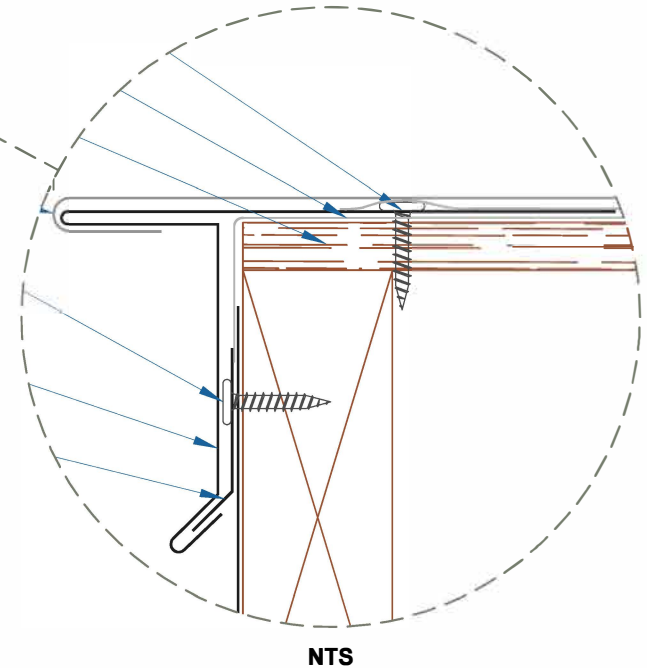

**GABLE**  
**w/DRIP EDGE**

SCALE: 3" = 1'-0"

EFFECTIVE DATE: 12-11-12  
SUBJECT TO CHANGE WITHOUT NOTICE

**Drexel Metals**  
Roofing Systems + Custom Fabrication



# DMC 200S - PLYWOOD



- 1/8" - #43 POP RIVET (18" o.c.)
- Z-CLOSURE FLASHING
- DMC 200S PANEL (FIELD CUT AND BEND)
- #10 - 13 x 1" PHW (12" o.c.)
- D.B. TAPE SEALANT
- METSHIELD UNDERLAYMENT
- PLYWOOD SUBSTRATE (1/2" MIN.)
- GABLE FLASHING
- #10 - 13 x 1" PHW (12" o.c.)
- GABLE CLEAT FLASHING
- FASCIA FLASHING

ZOOMED IN VIEW

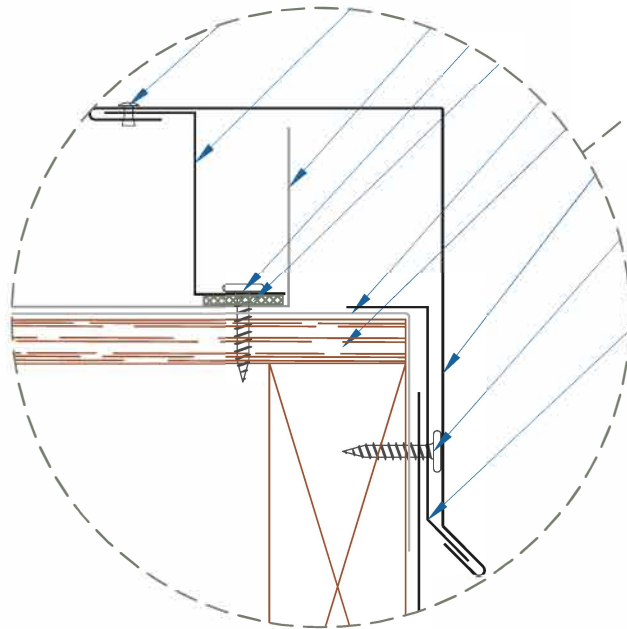

NTS

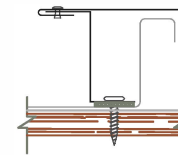

ON MODULE

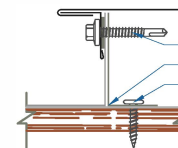

- #12 - 14 x 1 1/2" DP3 SD DREXMET HEAD (12" o.c.)
- FLOATING RAKE ANGLE
- #10 - 13 x 1" PHW (12" o.c.)
- NOT TO BE TIGHTENED

FLOATING GABLE

EFFECTIVE DATE: 12-11-12  
SUBJECT TO CHANGE WITHOUT NOTICE

**GABLE**  
SCALE: 3" = 1'-0"

**Drexel Metals**  
Roofing Systems + Custom Fabrication



# DMC 200S - PLYWOOD

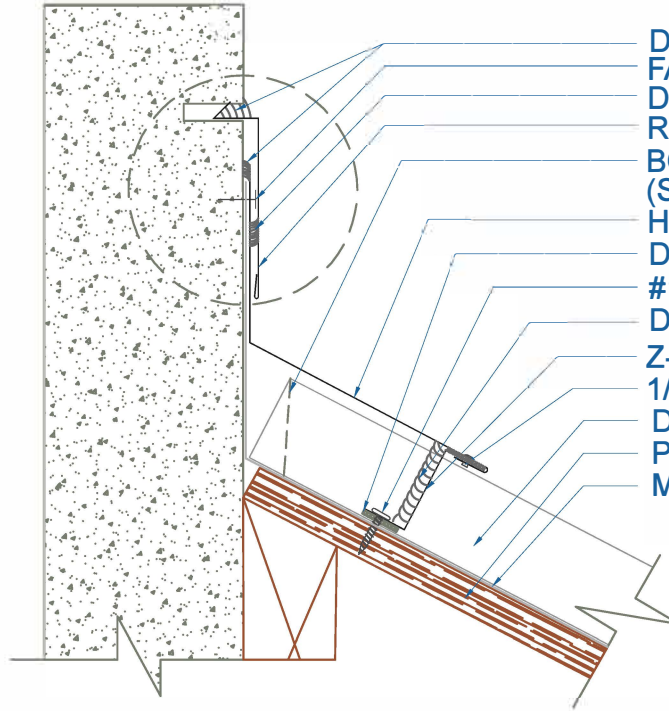

DREXEL APPROVED TUBE SEALANT  
 FASTENERS (BY OTHERS)  
 DREXEL APPROVED TUBE SEALANT  
 REGLET FLASHING  
 BOX END OF PANEL  
 (SEE ZEE CLOSURE OPTIONS DETAIL)  
 HEADWALL FLASHING  
 D.B. TAPE SEALANT  
 #10 - 13 x 1" PHW (5 PER PANEL)  
 DREXEL APPROVED TUBE SEALANT  
 Z-CLOSURE FLASHING  
 1/8" - #43 POP RIVET (18" o.c.)  
 DMC 200S PANEL  
 PLYWOOD SUBSTRATE (1/2" MIN.)  
 METSHIELD UNDERLAYMENT

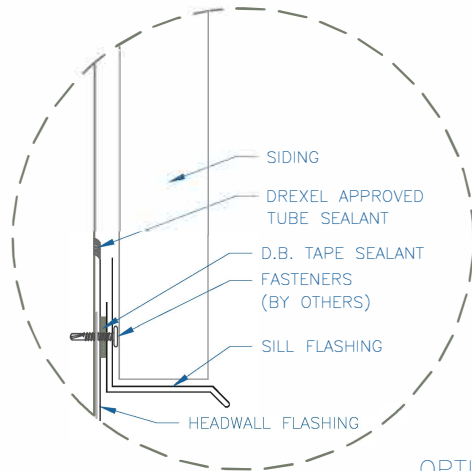

OPTION 1

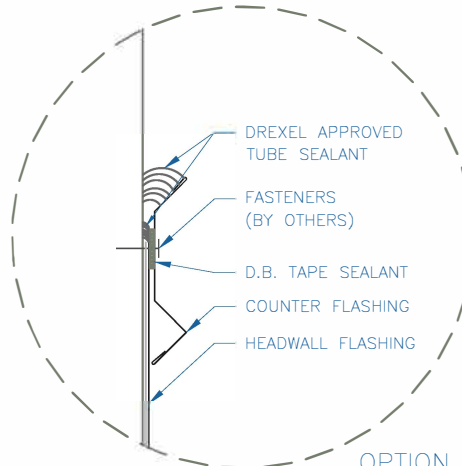

OPTION 2

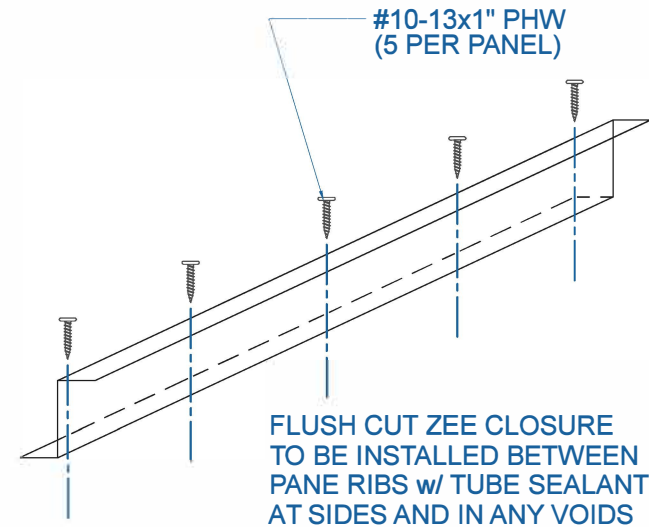

FLUSH CUT ZEE CLOSURE  
 TO BE INSTALLED BETWEEN  
 PANE RIBS w/ TUBE SEALANT  
 AT SIDES AND IN ANY VOIDS

EFFECTIVE DATE: 12-11-12  
 SUBJECT TO CHANGE WITHOUT NOTICE

**HEADWALL**  
 SCALE: 3" = 1'-0"

# DMC 200S - PLYWOOD

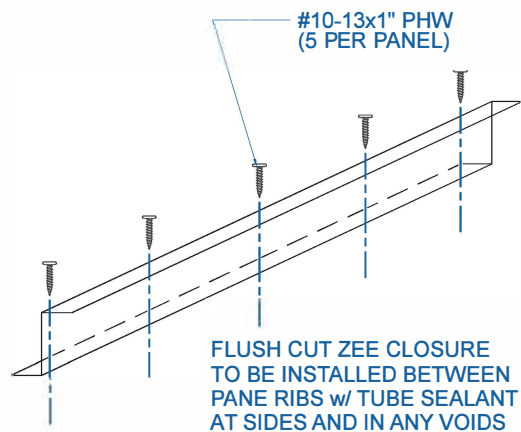
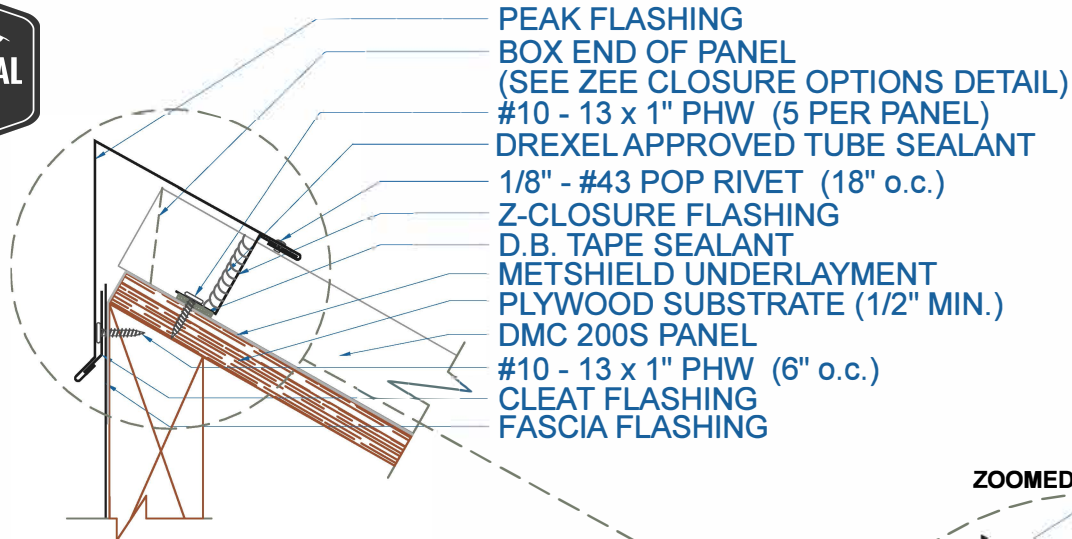

ZOOMED IN VIEW

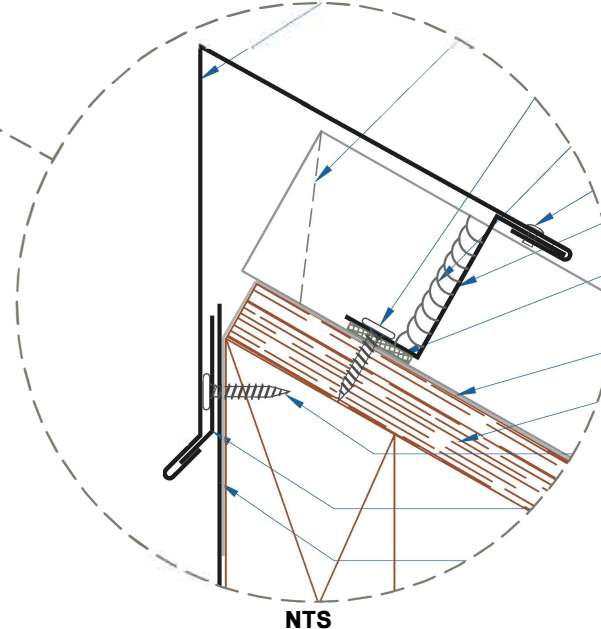

EFFECTIVE DATE: 12-11-12  
 SUBJECT TO CHANGE WITHOUT NOTICE

**PEAK**  
 SCALE: 3" = 1'-0"

**Drexel Metals**  
 Roofing Systems + Custom Fabrication



# DMC 200S - PLYWOOD

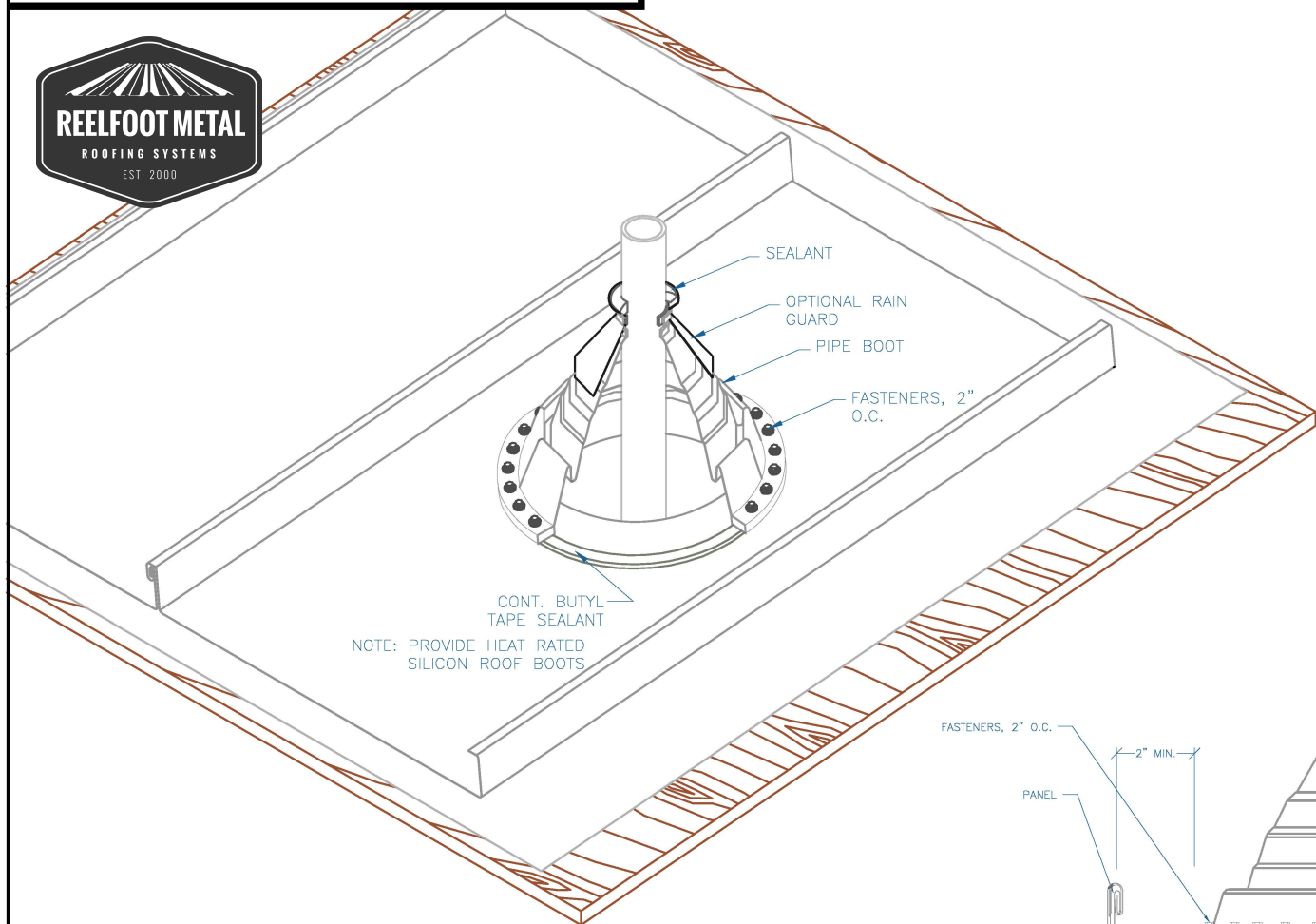

CONT. BUTYL  
TAPE SEALANT  
NOTE: PROVIDE HEAT RATED  
SILICON ROOF BOOTS

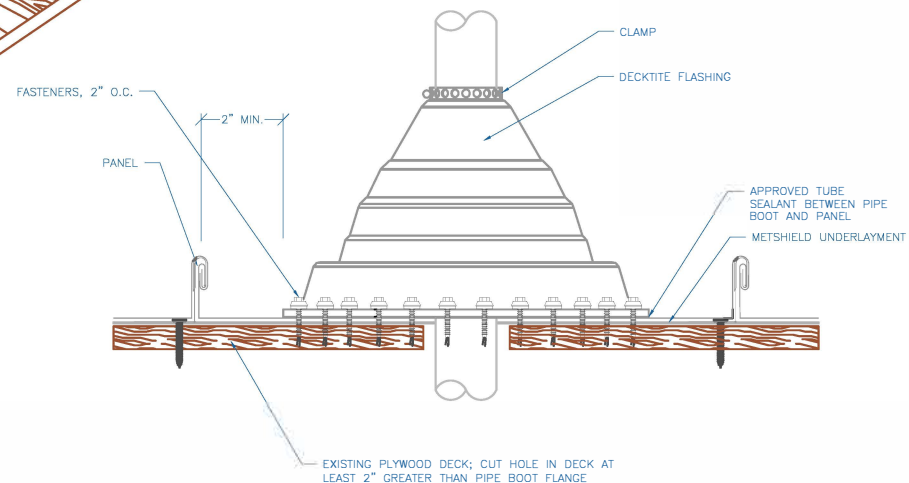

## PIPE FLASHING DETAIL

SCALE: NTS

**DrexelMetals**  
Roofing Systems + Custom Fabrication



EFFECTIVE DATE: 11-09-12  
SUBJECT TO CHANGE WITHOUT NOTICE



# DMC 200S - PLYWOOD

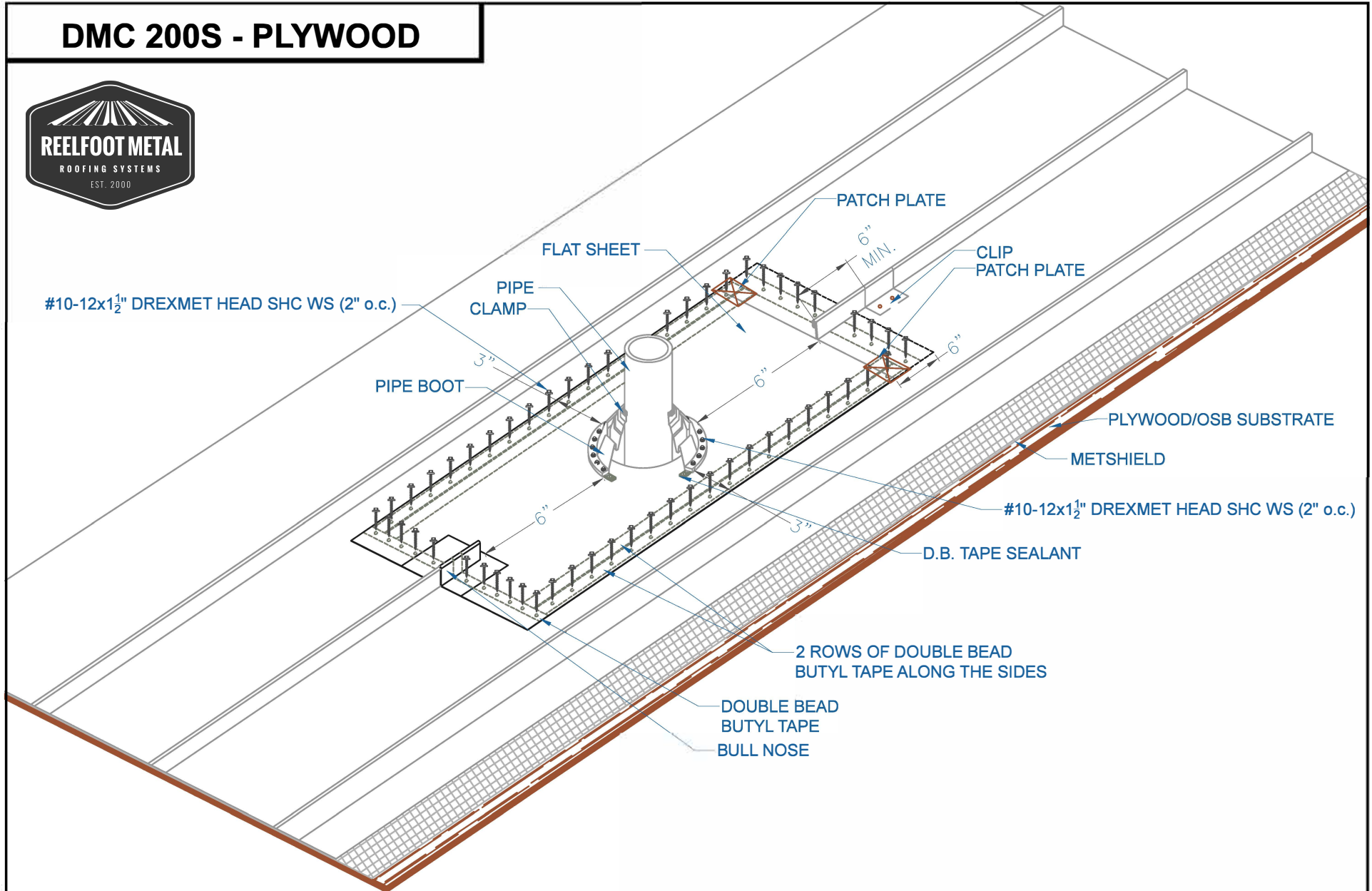

## PIPE FLASHING PAN DETAIL

EFFECTIVE DATE: 12-13-12  
SUBJECT TO CHANGE WITHOUT NOTICE

SCALE: NTS





# DMC 200S - PLYWOOD



ZOOMED IN VIEW

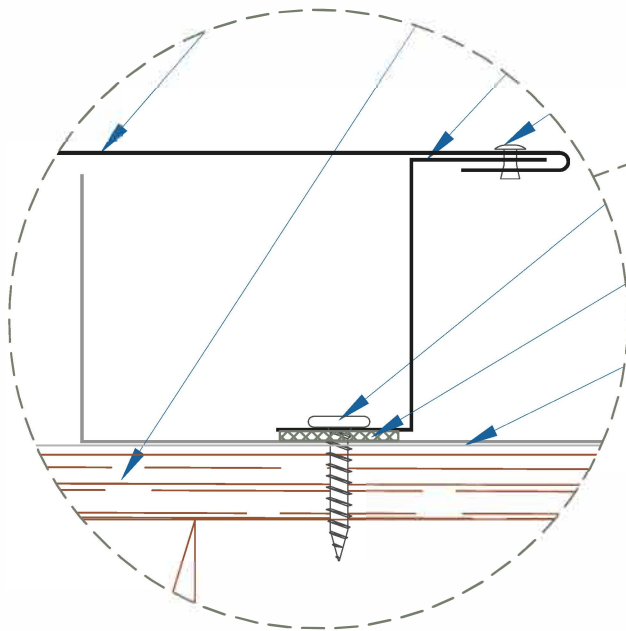

NTS

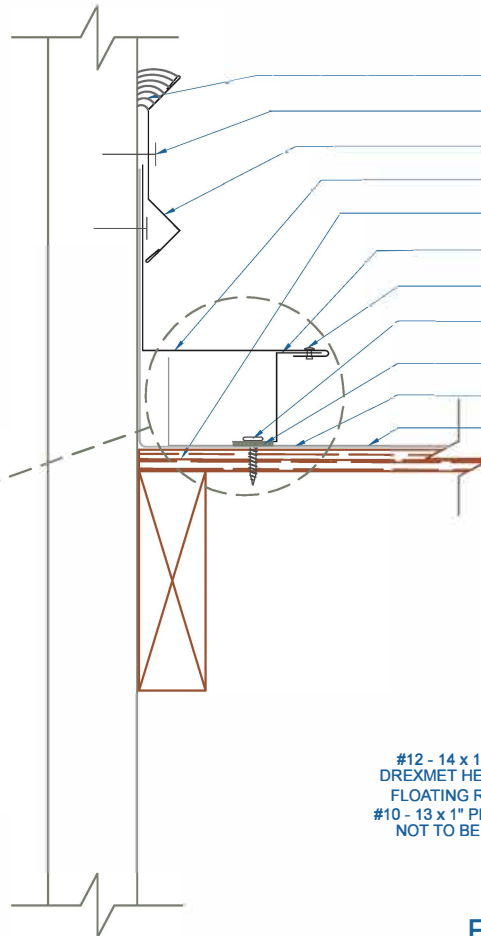

- DREXEL APPROVED TUBE SEALANT
- FASTENERS (BY OTHERS)
- COUNTER FLASHING
- RAKEWALL FLASHING
- PLYWOOD SUBSTRATE (1/2" MIN.)
- Z-CLOSURE FLASHING
- 1/8" - #43 POP RIVET (18" o.c.)
- #10 - 13 x 1" PHW (12" o.c.)
- D.B. TAPE SEALANT
- METSHIELD UNDERLAYMENT
- DMC 200S PANEL (FIELD CUT AND BEND)

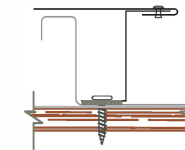

ON MODULE

- #12 - 14 x 1 1/2" DP3 SD DREXMET HEAD (12" o.c.)
- FLOATING RAKE ANGLE
- #10 - 13 x 1" PHW (12" o.c.)
- NOT TO BE TIGHTENED

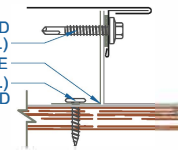

FLOATING RAKEWALL

EFFECTIVE DATE: 12-07-12  
SUBJECT TO CHANGE WITHOUT NOTICE

## RAKEWALL

SCALE: 3" = 1'-0"

**Drexel Metals**  
Roofing Systems + Custom Fabrication



# DMC 200S - PLYWOOD

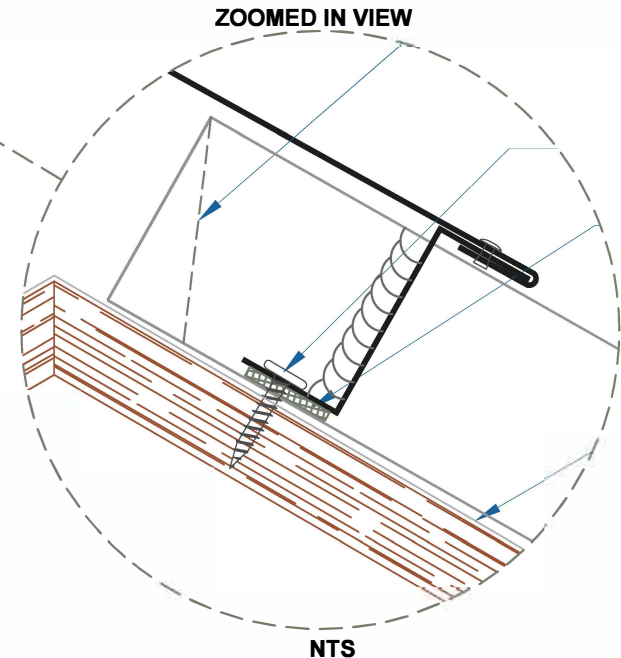
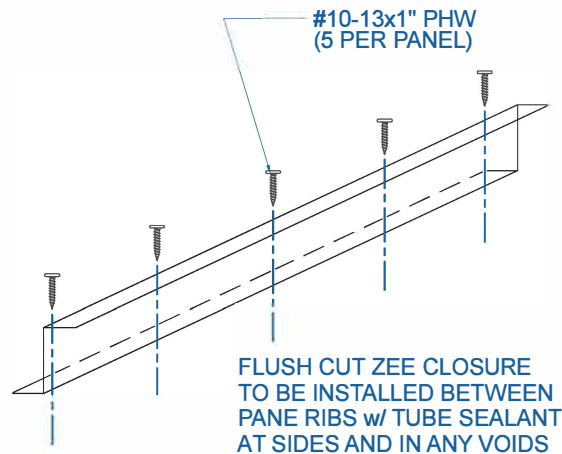
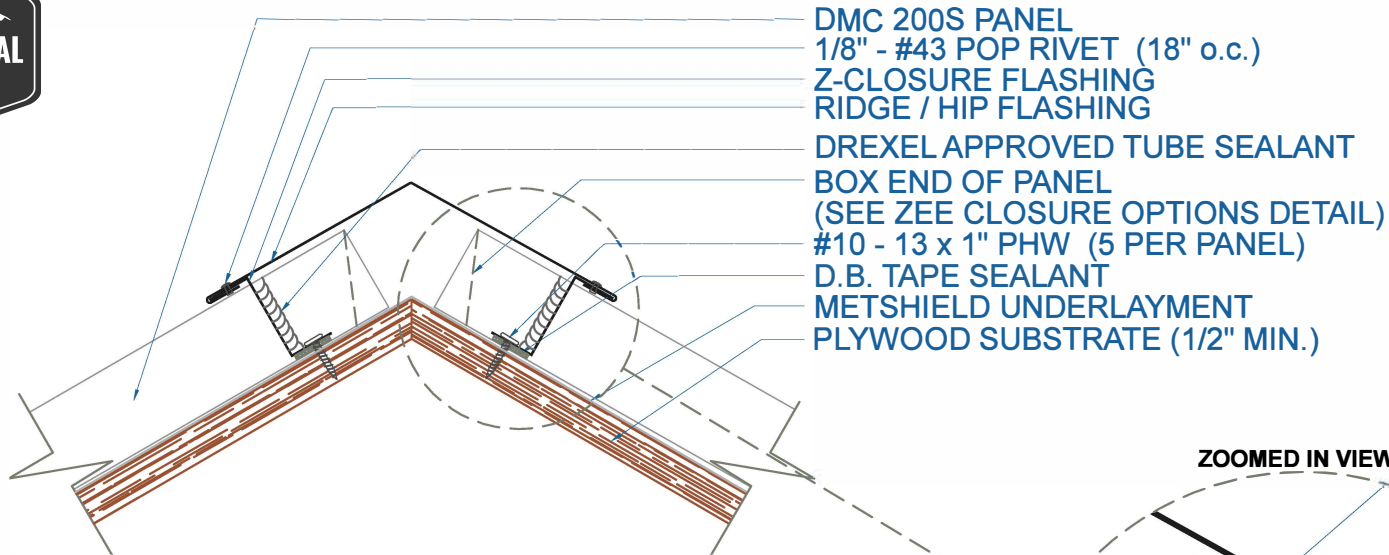

EFFECTIVE DATE: 12-11-12  
 SUBJECT TO CHANGE WITHOUT NOTICE

**RIDGE / HIP**  
 SCALE: 3" = 1'-0"

**Drexel Metals**  
 Roofing Systems + Custom Fabrication

# DMC 200S - PLYWOOD



- DMC 200S PANEL
- #10 - 13 x 1" PHW (12" o.c.)
- D.B. TAPE SEALANT
- OFFSET CLEAT FLASHING
- FIELD CUT & HEM PANEL 180°
- BOX END OF PANEL  
(SEE ZEE CLOSURE OPTIONS DETAIL)
- TRANSITION FLASHING
- 1/8" - #43 POP RIVET (18" o.c.)
- Z-CLOSURE
- #10 - 13 x 1" PHW (5 PER PANEL)
- D.B. TAPE SEALANT
- PLYWOOD SUBSTRATE (1/2" MIN.)
- DMC 200S PANEL
- METSHIELD UNDERLAYMENT

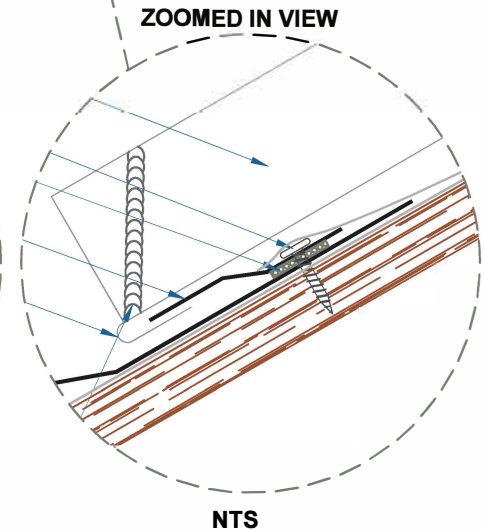
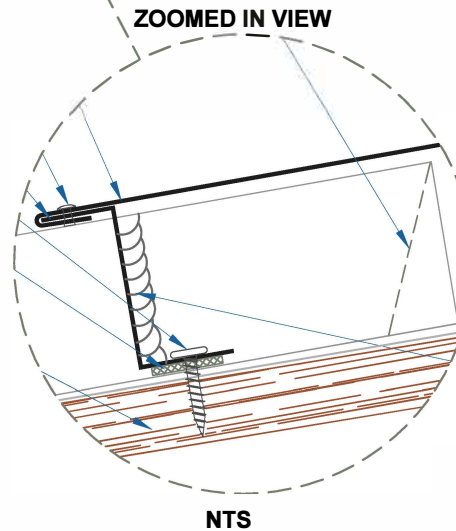
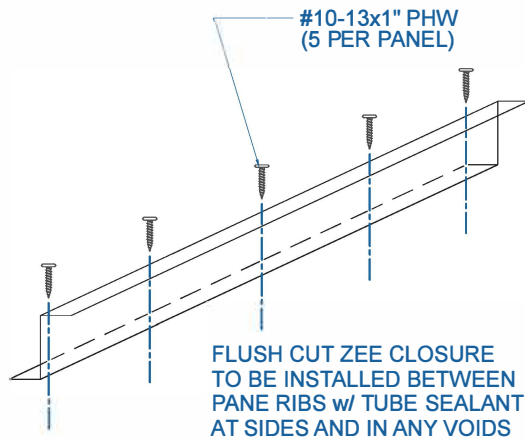
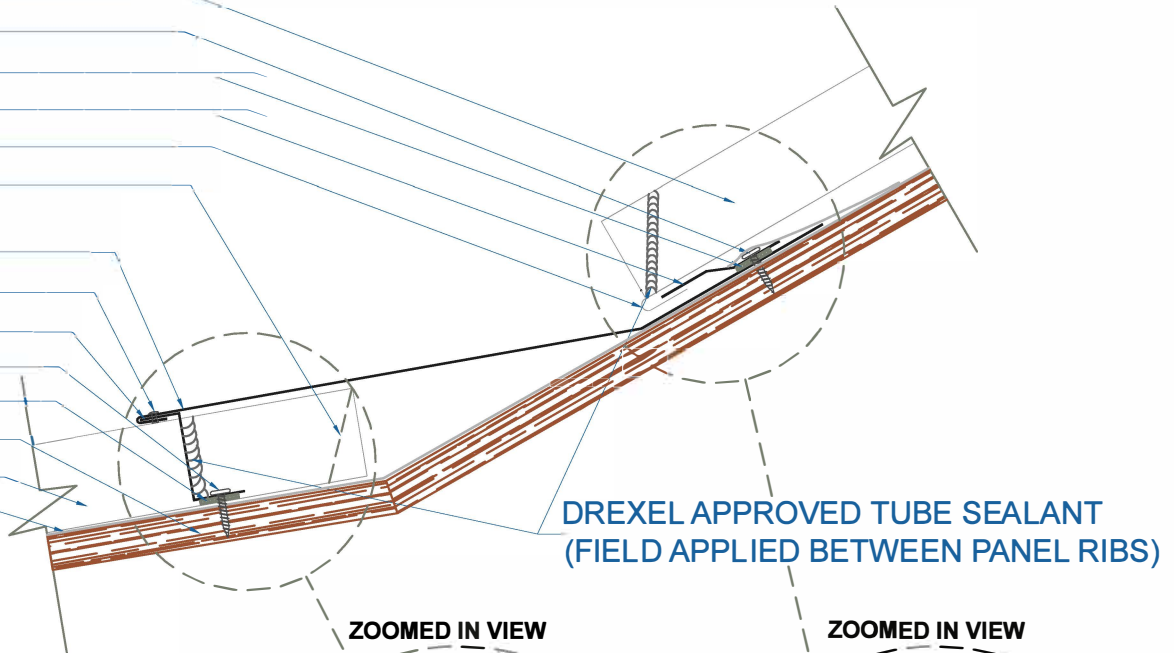

## TRANSITION

SCALE: 3" = 1'-0"

EFFECTIVE DATE: 12-11-12  
SUBJECT TO CHANGE WITHOUT NOTICE

**Drexel Metals**  
Roofing Systems + Custom Fabrication



# DMC 200S - PLYWOOD



ZOOMED IN VIEW

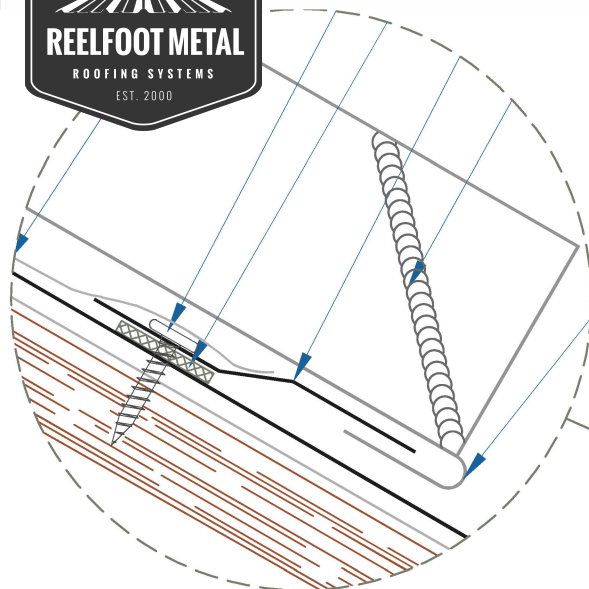

NTS

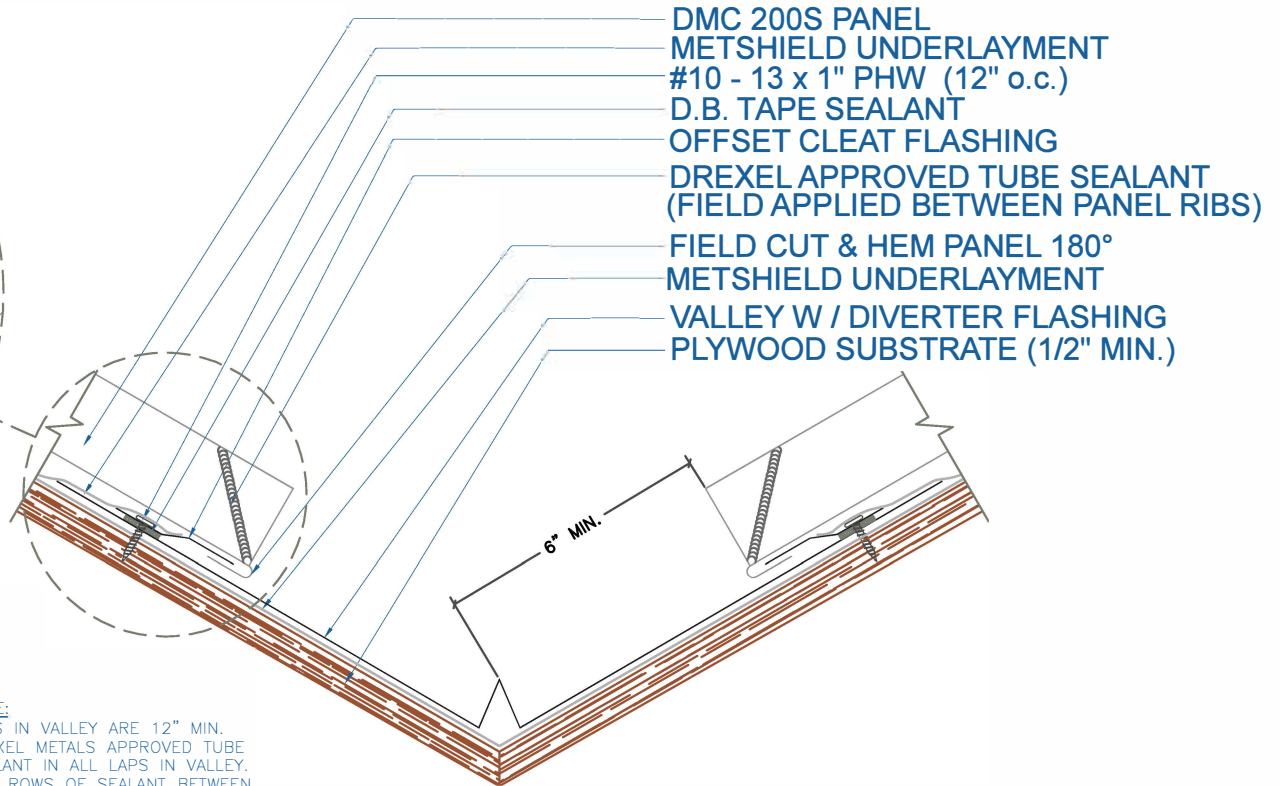

NOTE:

- 1.) LAPS IN VALLEY ARE 12" MIN.  
DREXEL METALS APPROVED TUBE SEALANT IN ALL LAPS IN VALLEY.  
TWO ROWS OF SEALANT BETWEEN VALLEY LAPS, 4" UP FROM LAP.
- 2.) LARGE ROOF AREAS MAY REQUIRE A LARGER GAP BETWEEN PANEL AND DIVERTER TO ALLOW FOR STORM WATER RUN OFF.

EFFECTIVE DATE: 12-11-12  
SUBJECT TO CHANGE WITHOUT NOTICE

## VALLEY W / DIVERTER

SCALE: 3" = 1'-0"

**Drexel Metals**  
Roofing Systems + Custom Fabrication



# DMC 200S - PLYWOOD



ZOOMED IN VIEW

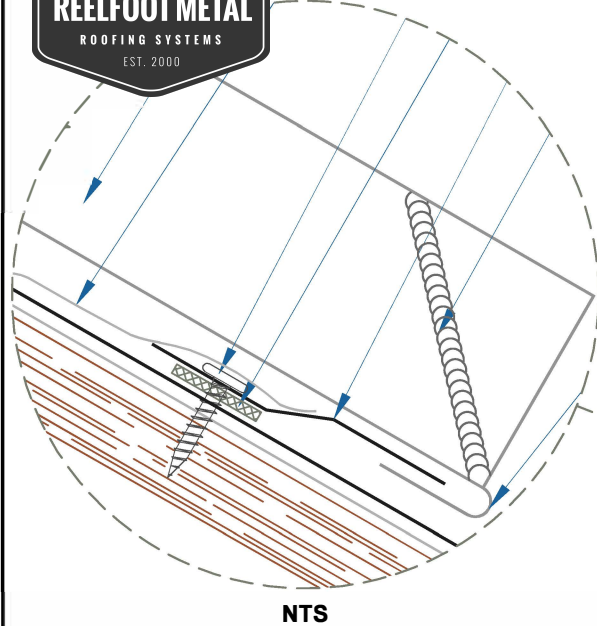

NTS

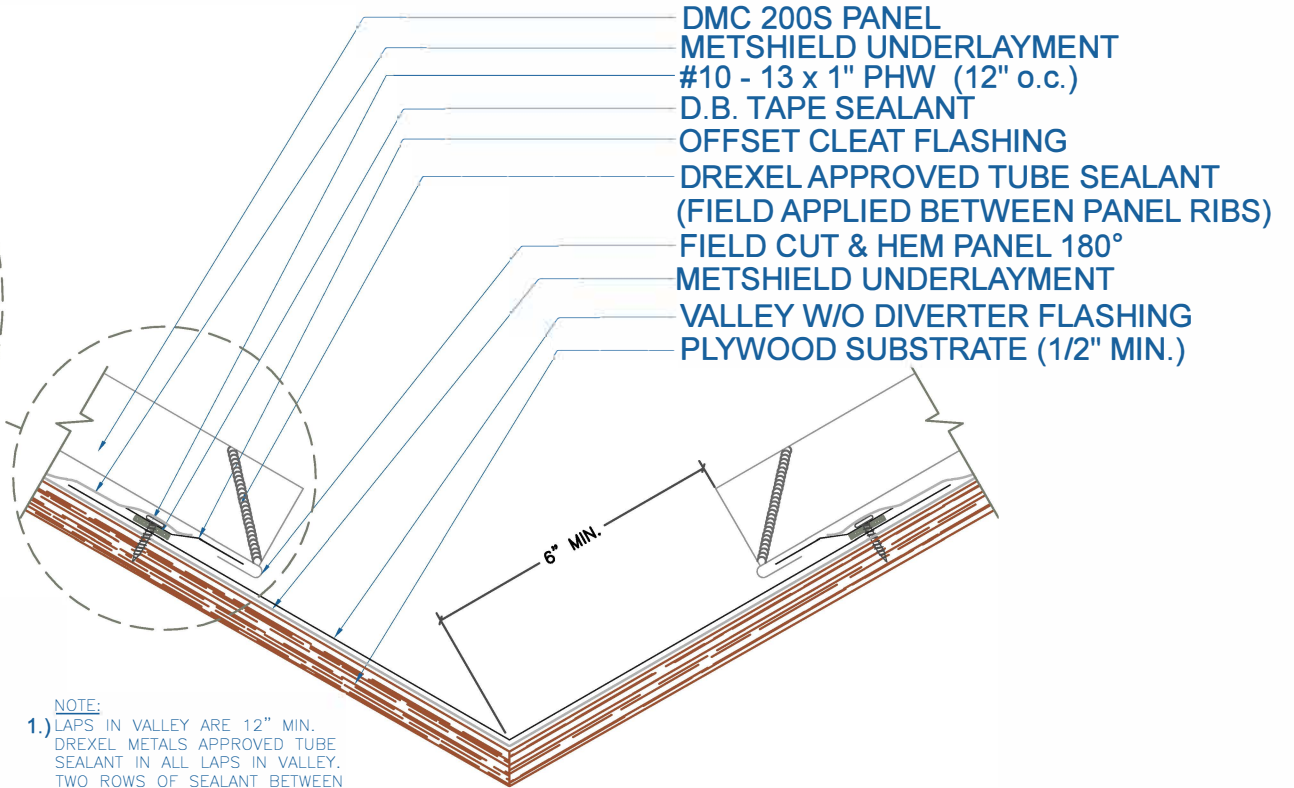

NOTE:

- 1.) LAPS IN VALLEY ARE 12" MIN.  
DREXEL METALS APPROVED TUBE SEALANT IN ALL LAPS IN VALLEY.  
TWO ROWS OF SEALANT BETWEEN VALLEY LAPS, 4" UP FROM LAP.
- 2.) LARGE ROOF AREAS MAY REQUIRE A LARGER GAP BETWEEN PANEL AND DIVERTER TO ALLOW FOR STORM WATER RUN OFF.

## VALLEY W/O DIVERTER

SCALE: 3" = 1'-0"

EFFECTIVE DATE: 12-11-12  
SUBJECT TO CHANGE WITHOUT NOTICE

**Drexel Metals**  
Roofing Systems + Custom Fabrication





# DMC 200S - PLYWOOD



NOTE:

- 1.) LAPS IN VALLEYWALL ARE 12" MIN. DREXEL METALS APPROVED SEALANT IN ALL LAPS IN VALLEY. TWO ROWS OF SEALANT BETWEEN VALLEYWALL LAPS, 4" UP FROM LAP.
- 2.) LARGE ROOF AREAS MAY REQUIRE A LARGER GAP BETWEEN PANEL AND WALL TO ALLOW FOR STORM WATER RUN OFF.

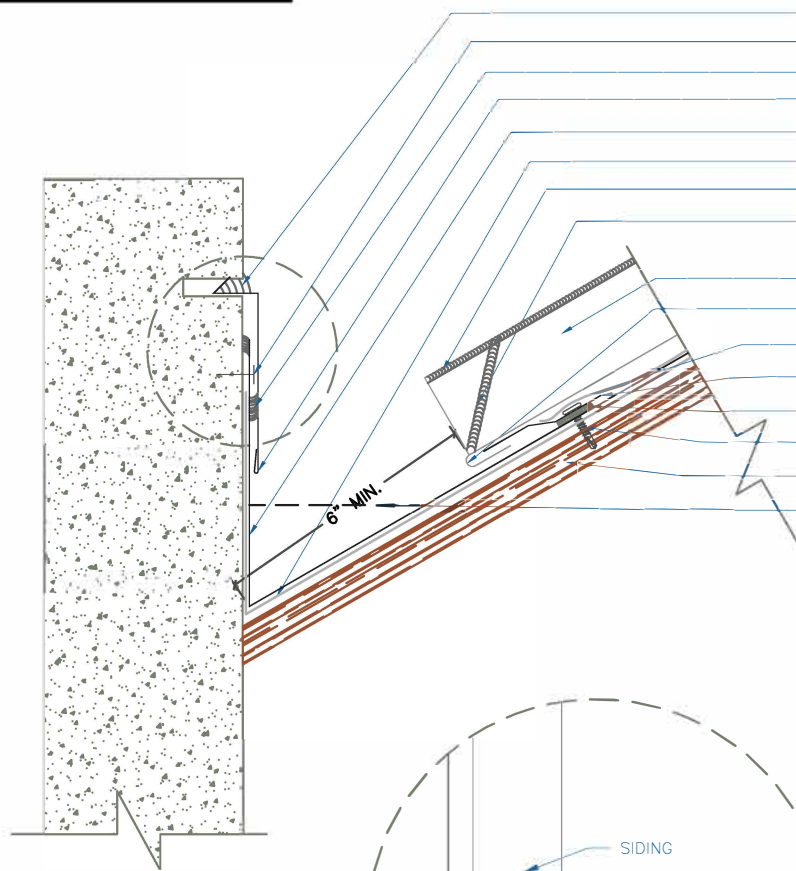

DREXEL APPROVED TUBE SEALANT  
 FASTENERS (BY OTHERS)  
 DREXEL APPROVED TUBE SEALANT  
 REGLET FLASHING  
 VALLEYWALL FLASHING  
 METSHIELD UNDERLAYMENT  
 SEAM SEALANT (3'-0" UP FROM RIB END)  
 DREXEL APPROVED TUBE SEALANT  
 (FIELD APPLIED BETWEEN PANEL RIBS)  
 DMC 200S PANEL  
 FIELD CUT & HEM PANEL 180°  
 METSHIELD UNDERLAYMENT  
 OFFSET CLEAT FLASHING  
 D.B. TAPE SEALANT  
 #10 - 13 x 1" PHW (12" o.c.)  
 PLYWOOD SUBSTRATE (1/2" MIN.)  
 CRICKET BEYOND

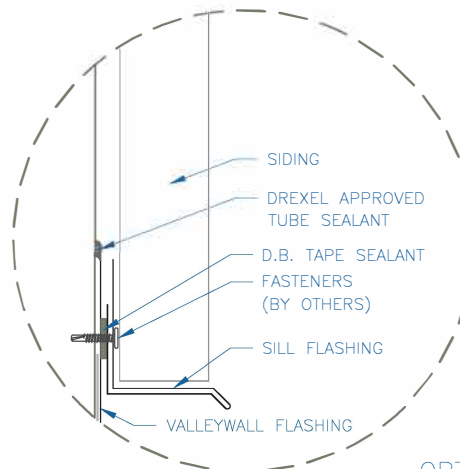

OPTION 1

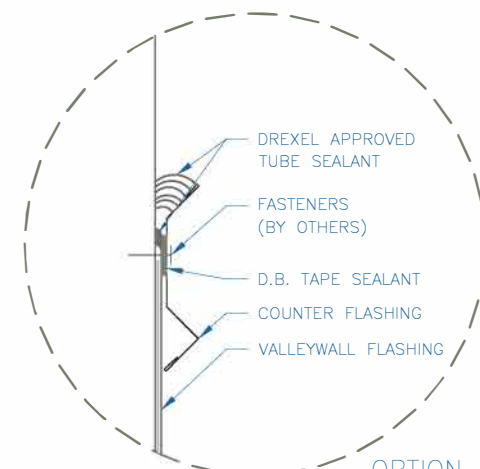

OPTION 2

EFFECTIVE DATE: 12-11-12  
 SUBJECT TO CHANGE WITHOUT NOTICE

**VALLEYWALL**  
 SCALE: 3" = 1'-0"

**Drexel Metals**  
 Roofing Systems + Custom Fabrication



# DMC 200S - PLYWOOD

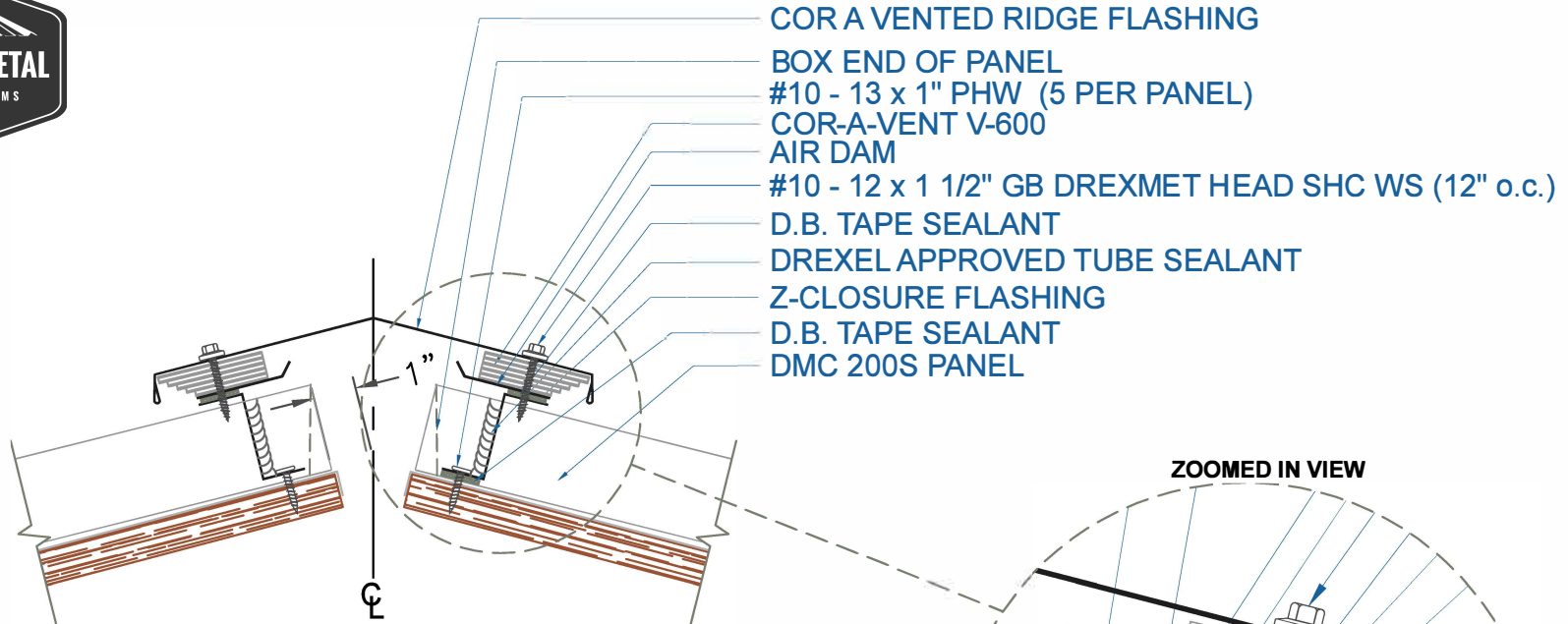

NOTE:  
1.) NET FREE AREA = 20 SQ IN/FT

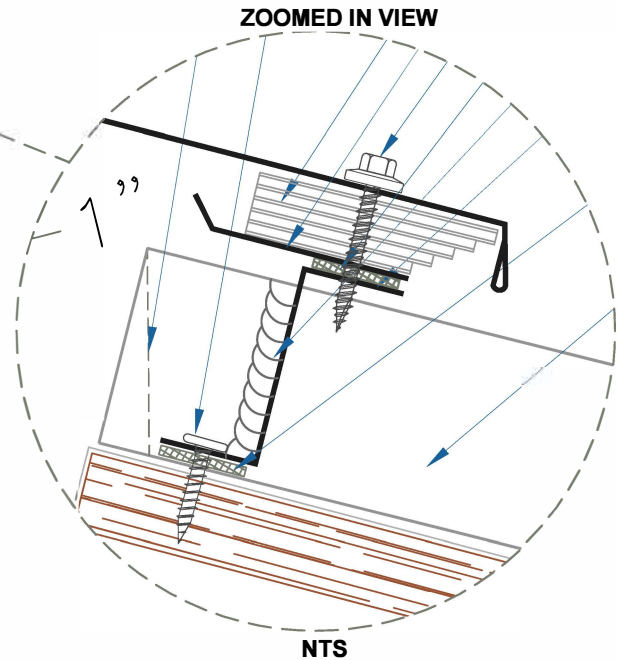
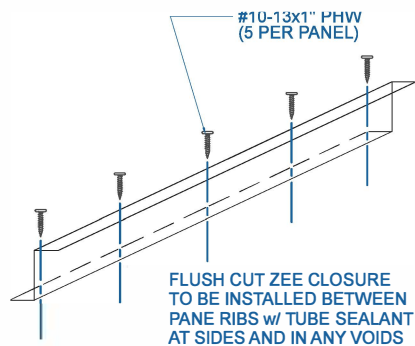

## COR-A-VENTED RIDGE / HIP

SCALE: 3" = 1'-0"

EFFECTIVE DATE: 1-9-13  
SUBJECT TO CHANGE WITHOUT NOTICE

**Drexel Metals**  
Roofing Systems + Custom Fabrication





# DMC 200S - PLYWOOD

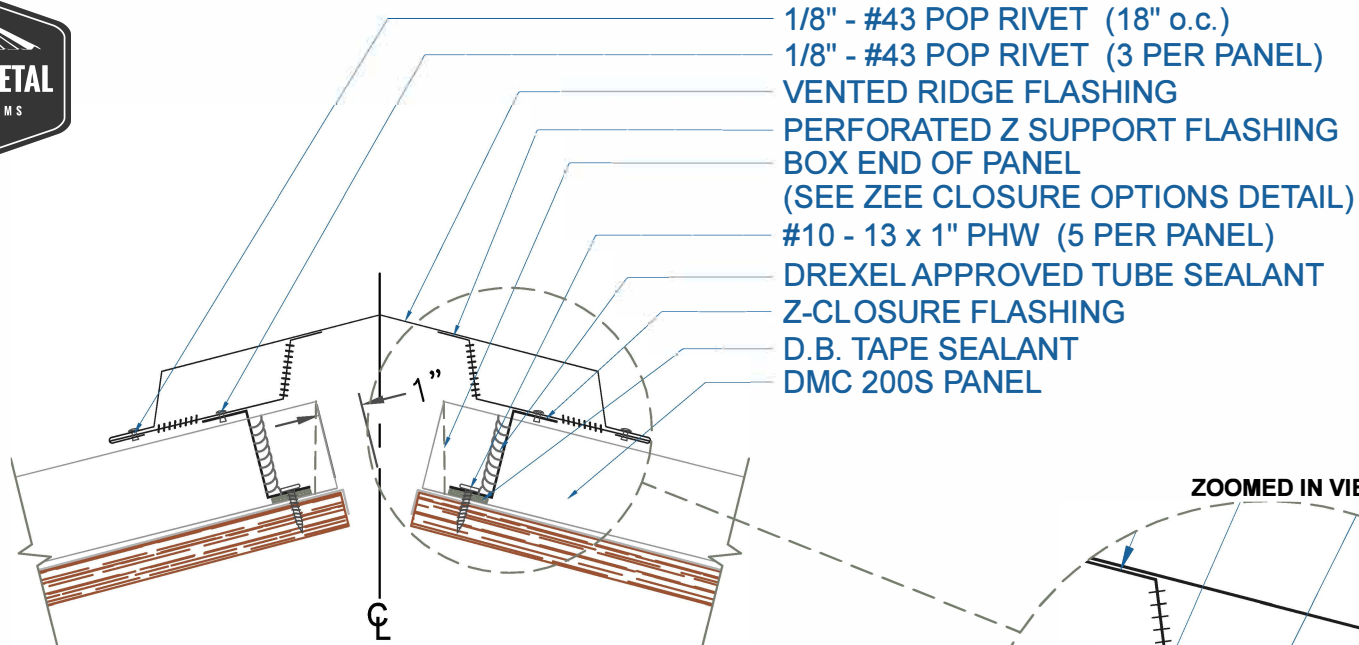

- 1/8" - #43 POP RIVET (18" o.c.)
- 1/8" - #43 POP RIVET (3 PER PANEL)
- VENTED RIDGE FLASHING
- PERFORATED Z SUPPORT FLASHING
- BOX END OF PANEL  
(SEE ZEE CLOSURE OPTIONS DETAIL)
- #10 - 13 x 1" PHW (5 PER PANEL)
- DREXEL APPROVED TUBE SEALANT
- Z-CLOSURE FLASHING
- D.B. TAPE SEALANT
- DMC 200S PANEL

NOTE:  
1.) NET FREE AREA = 6.16 SQ IN/FT

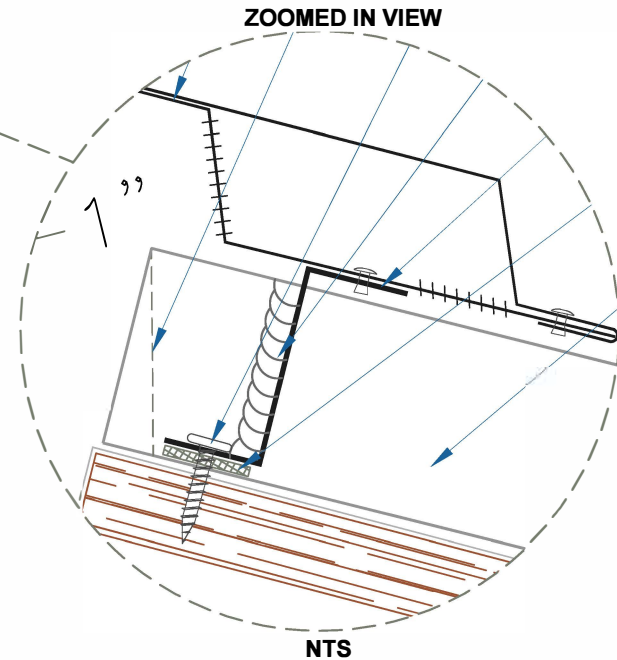
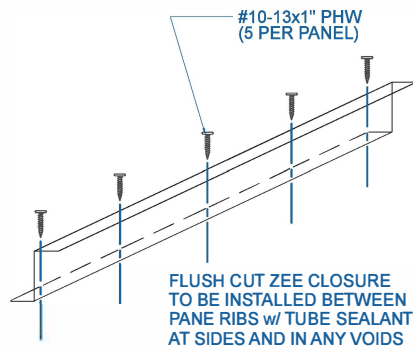

EFFECTIVE DATE: 12-11-12  
SUBJECT TO CHANGE WITHOUT NOTICE

## VENTED RIDGE / HIP

SCALE: 3" = 1'-0"

**Drexel Metals**  
Roofing Systems + Custom Fabrication

