

DMC 175S - PLYWOOD

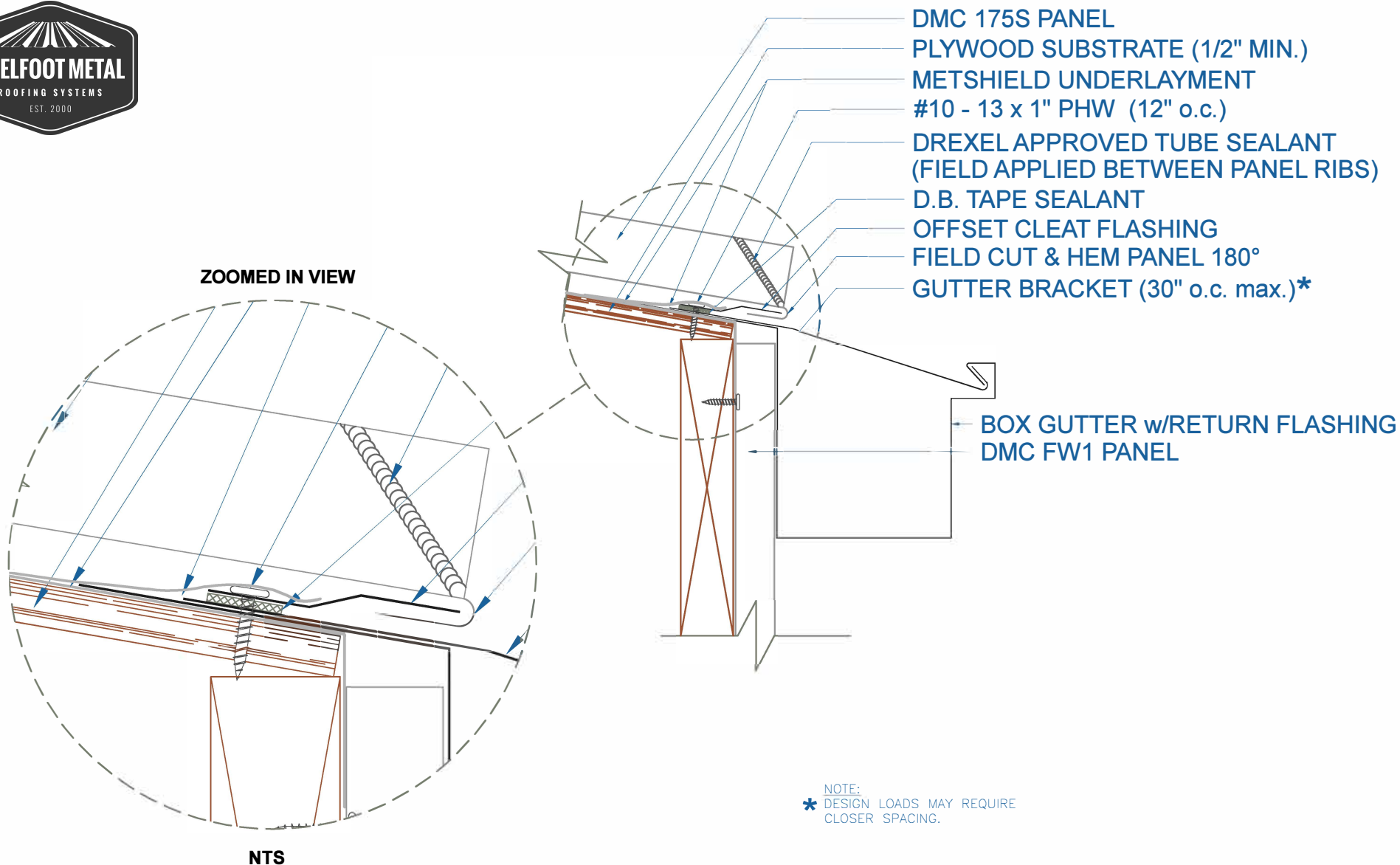

BOX GUTTER - w/RETURN w/FLUSH PANEL

EFFECTIVE DATE: 12-11-2012
SUBJECT TO CHANGE WITHOUT NOTICE

SCALE: 3" = 1'-0"

DrexelMetals
Roofing Systems + Custom Fabrication



DMC 175S - PLYWOOD

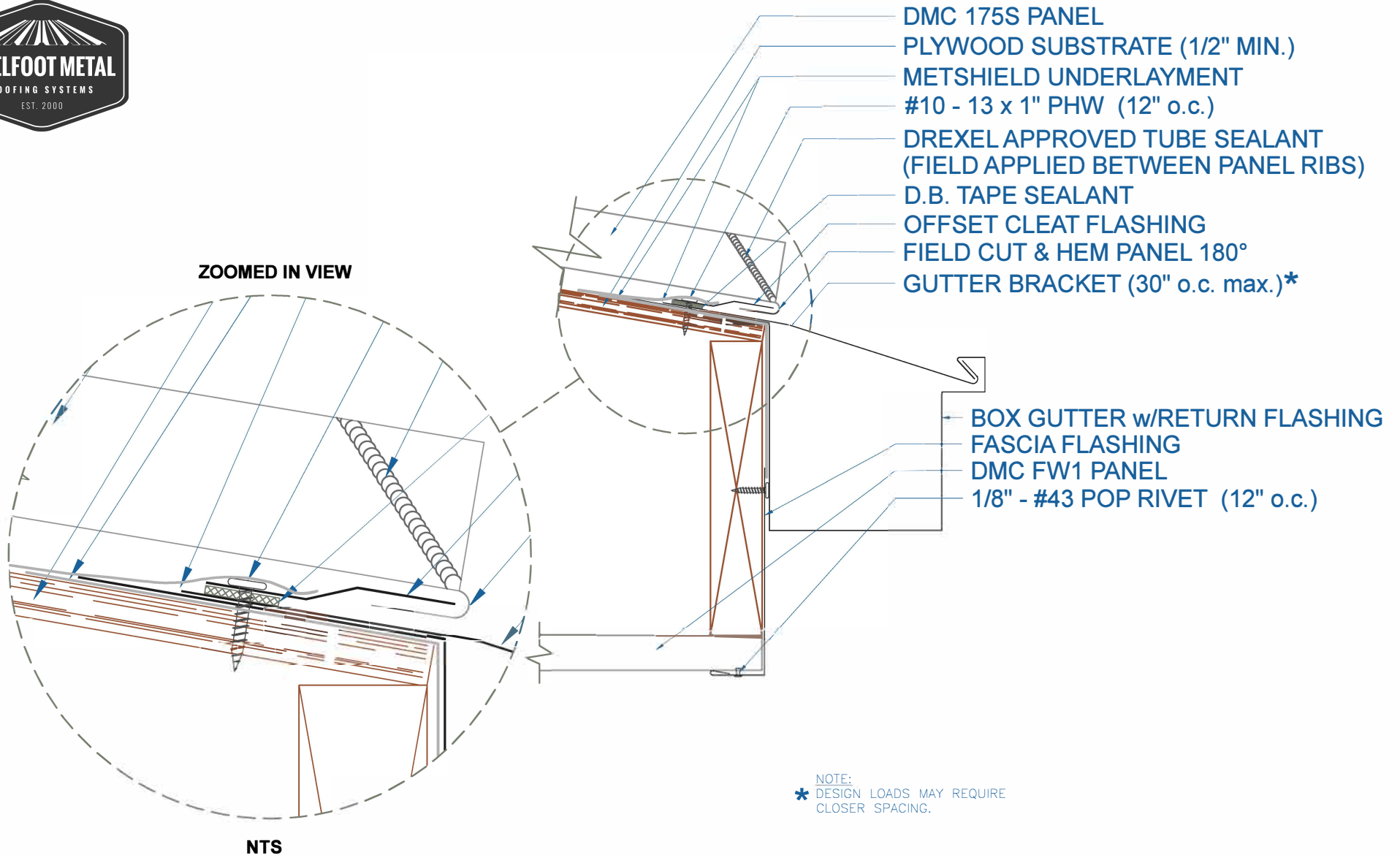

NOTE:
* DESIGN LOADS MAY REQUIRE
CLOSER SPACING.

BOX GUTTER - w/RETURN w/SOFFIT

EFFECTIVE DATE: 12-13-12
SUBJECT TO CHANGE WITHOUT NOTICE

SCALE: 3" = 1'-0"

DrexelMetals
Roofing Systems + Custom Fabrication



DMC 175S - PLYWOOD

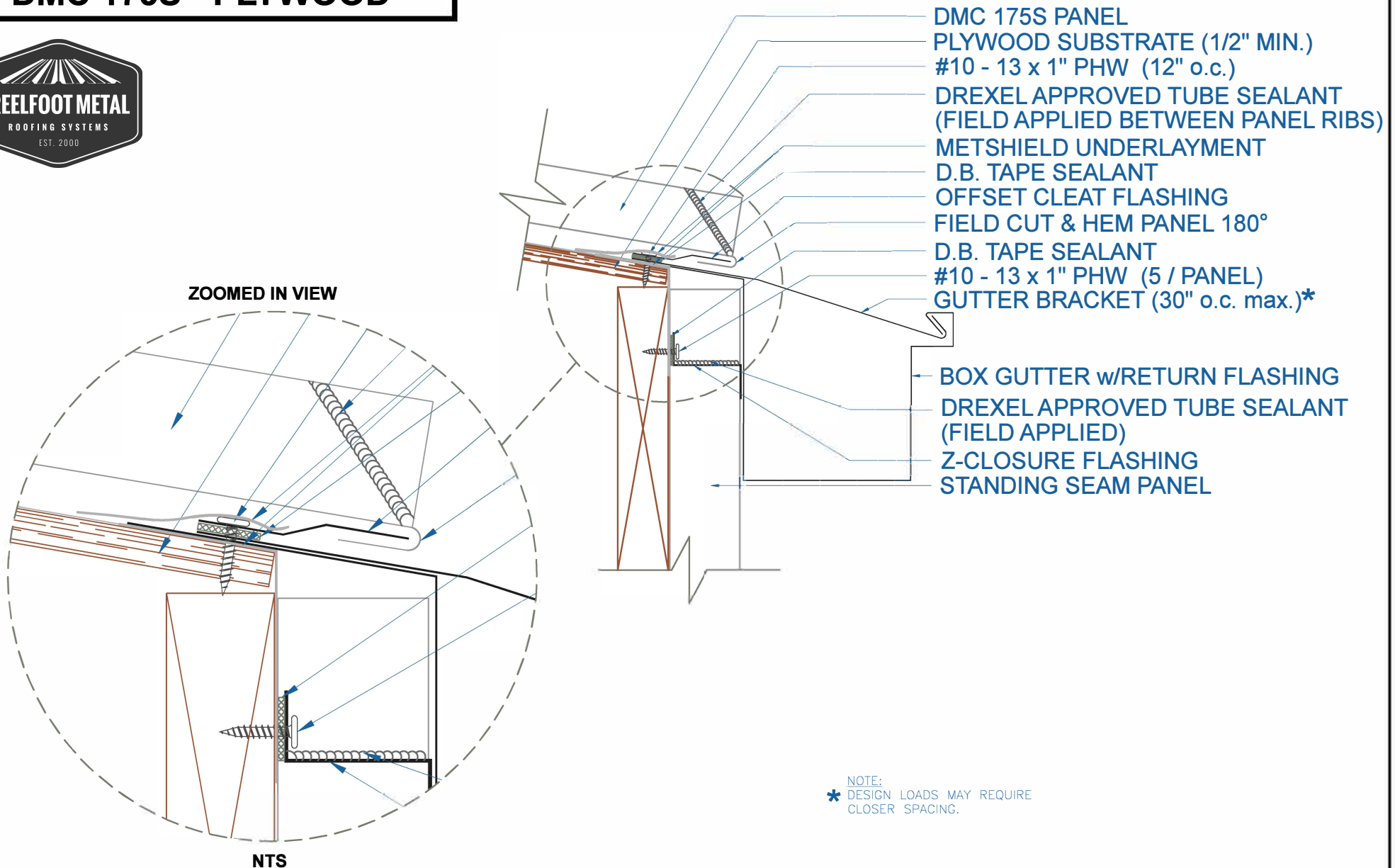

BOX GUTTER w/RETURN w/STANDING SEAM PANEL

SCALE: 3" = 1'-0"

EFFECTIVE DATE: 12-11-12
SUBJECT TO CHANGE WITHOUT NOTICE

DrexelMetals
Roofing Systems + Custom Fabrication



DMC 175S - PLYWOOD

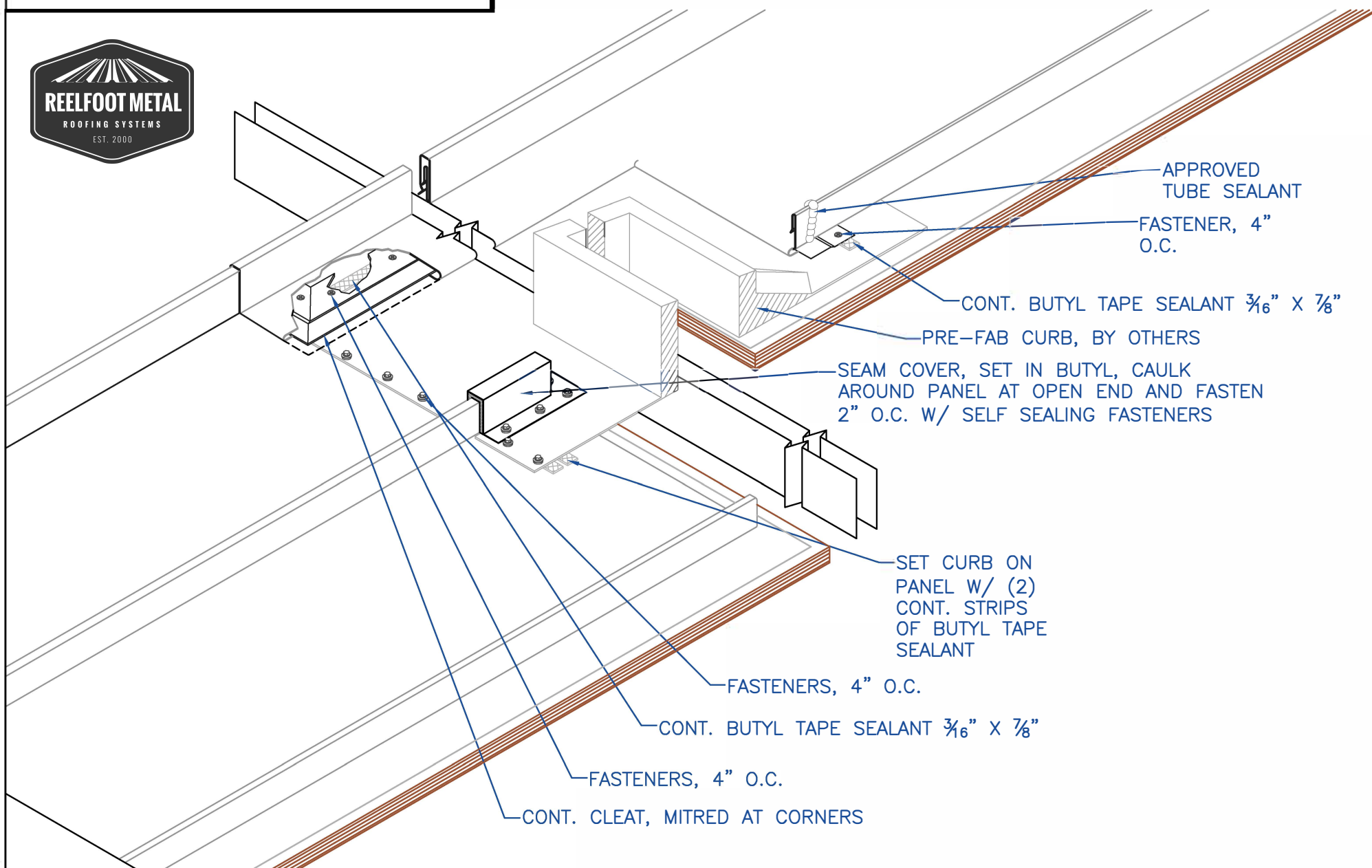

CURB DETAIL

SCALE: NTS

EFFECTIVE DATE: 12-11-2012
SUBJECT TO CHANGE WITHOUT NOTICE



DMC 175S - PLYWOOD

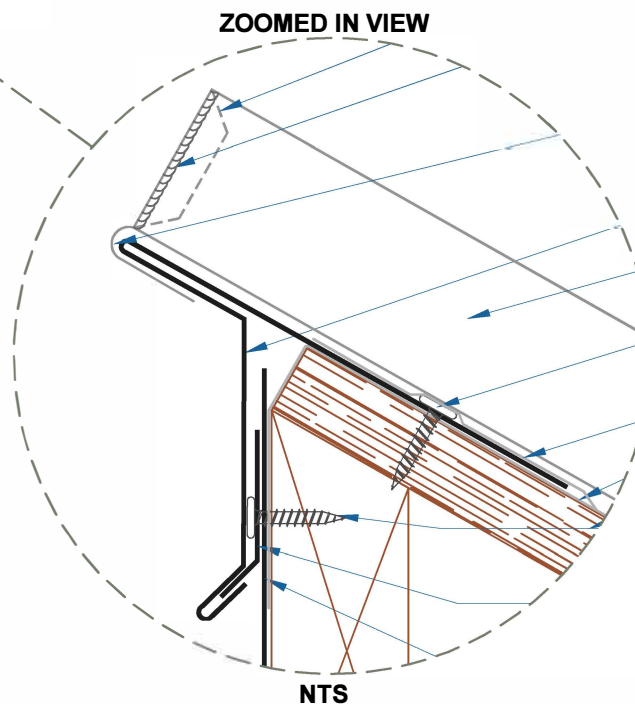
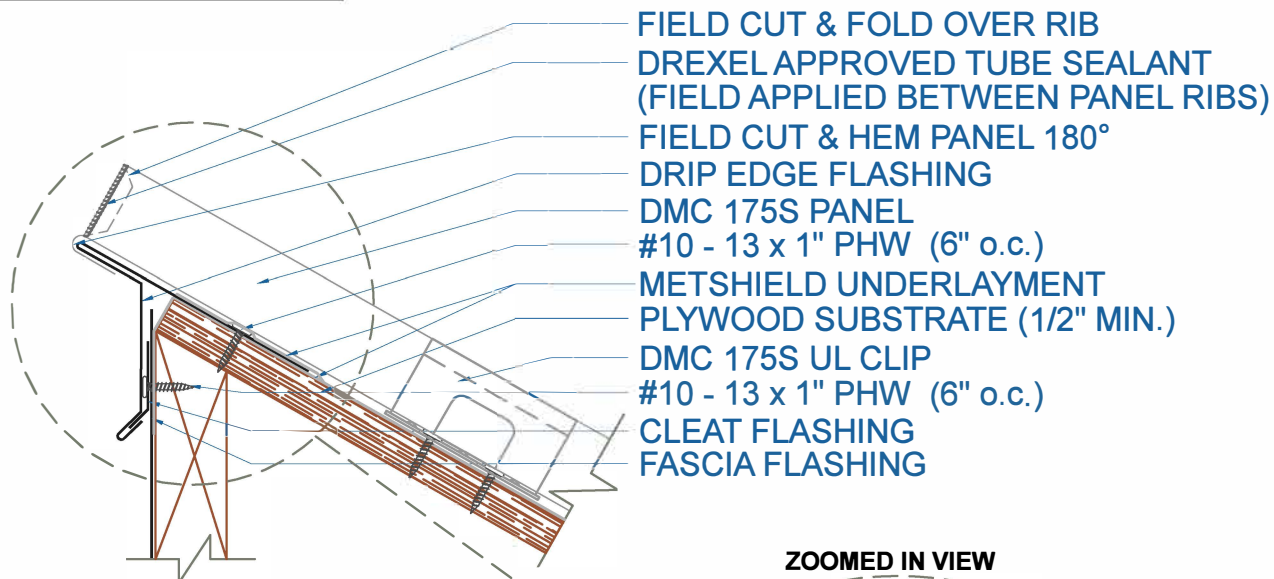

EFFECTIVE DATE: 12-12-12
SUBJECT TO CHANGE WITHOUT NOTICE

DRIP EDGE PEAK

SCALE: 3" = 1'-0"



DMC 175S - PLYWOOD

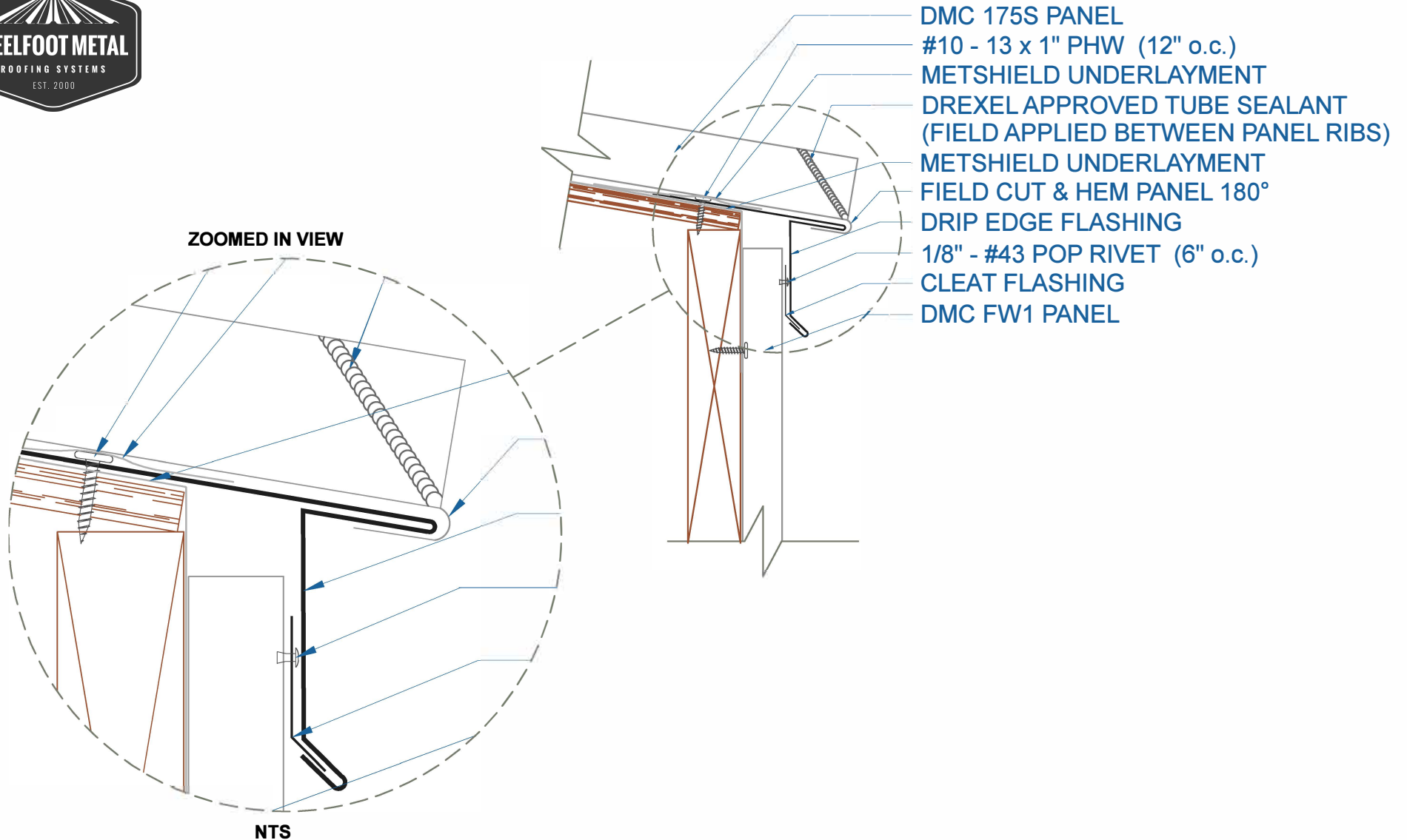

DRIP EDGE w/FLUSH PANEL

SCALE: 3" = 1'-0"

EFFECTIVE DATE: 12-11-12
SUBJECT TO CHANGE WITHOUT NOTICE



DMC 175S - PLYWOOD

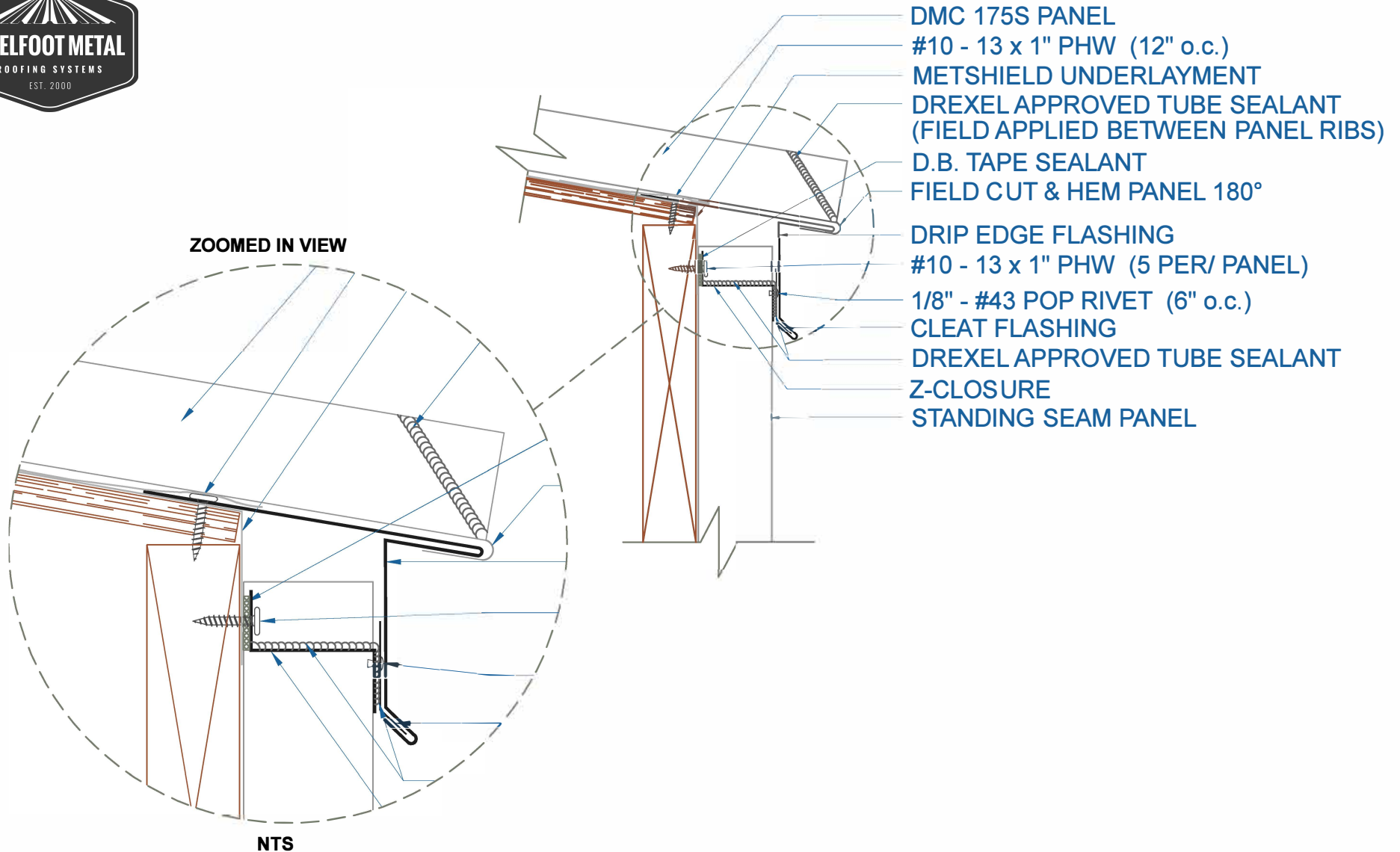

DRIP EDGE w/STANDING SEAM PANEL

EFFECTIVE DATE: 12-11-12
SUBJECT TO CHANGE WITHOUT NOTICE

SCALE: 3" = 1'-0"



DMC 175S - PLYWOOD

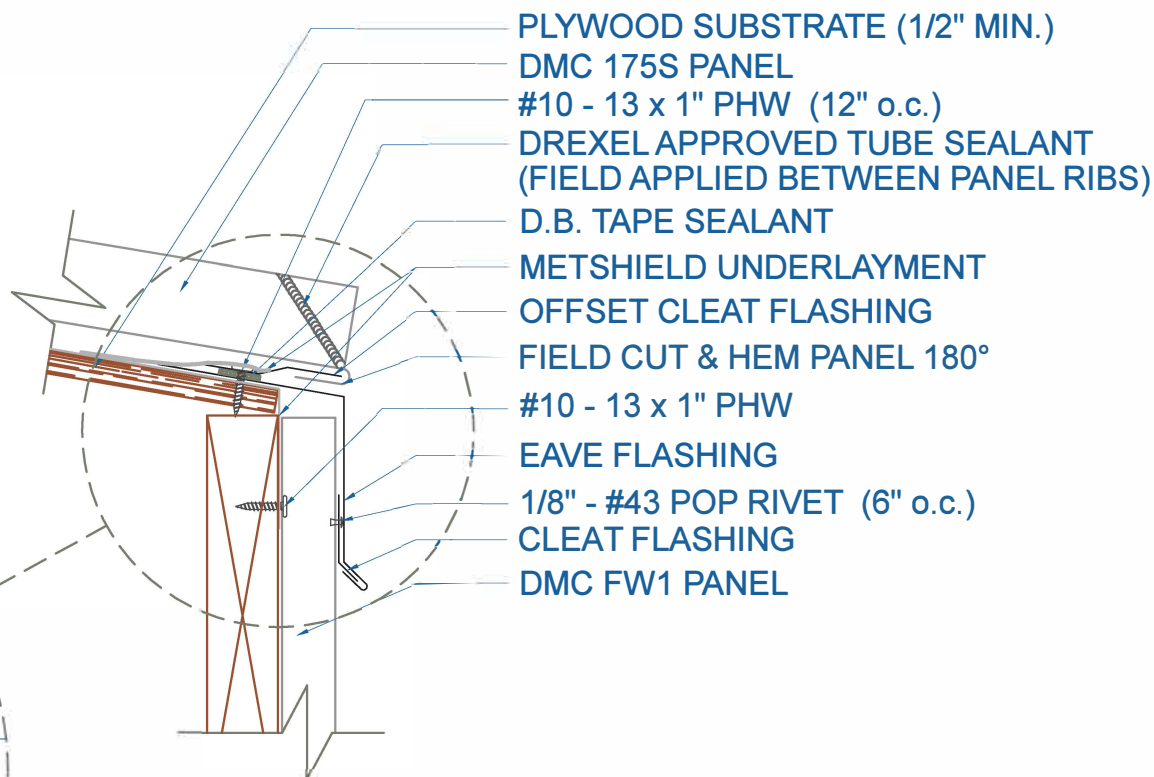
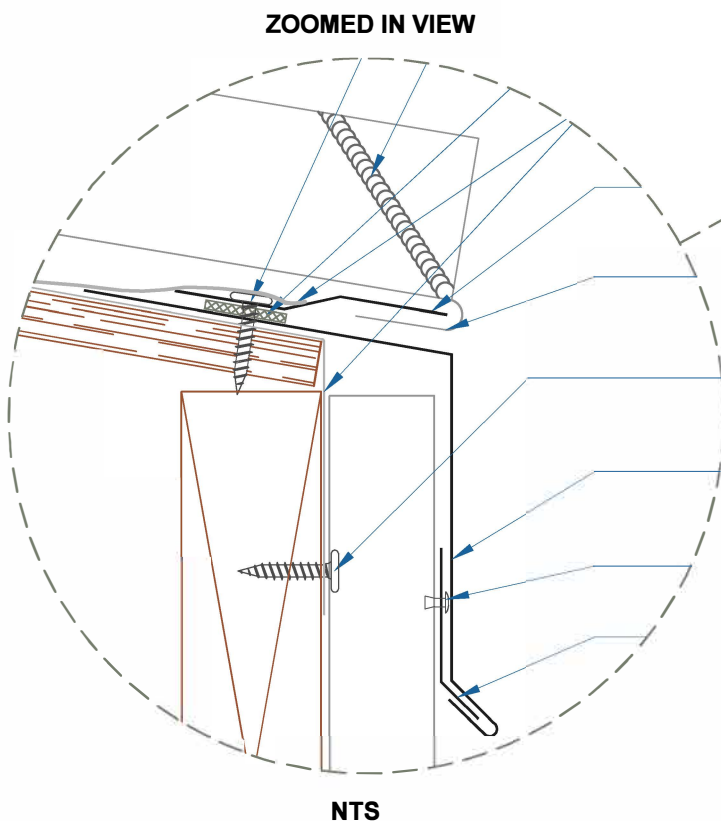

EAVE w/FLUSH PANEL

SCALE: 3" = 1'-0"

DMC 175S - PLYWOOD

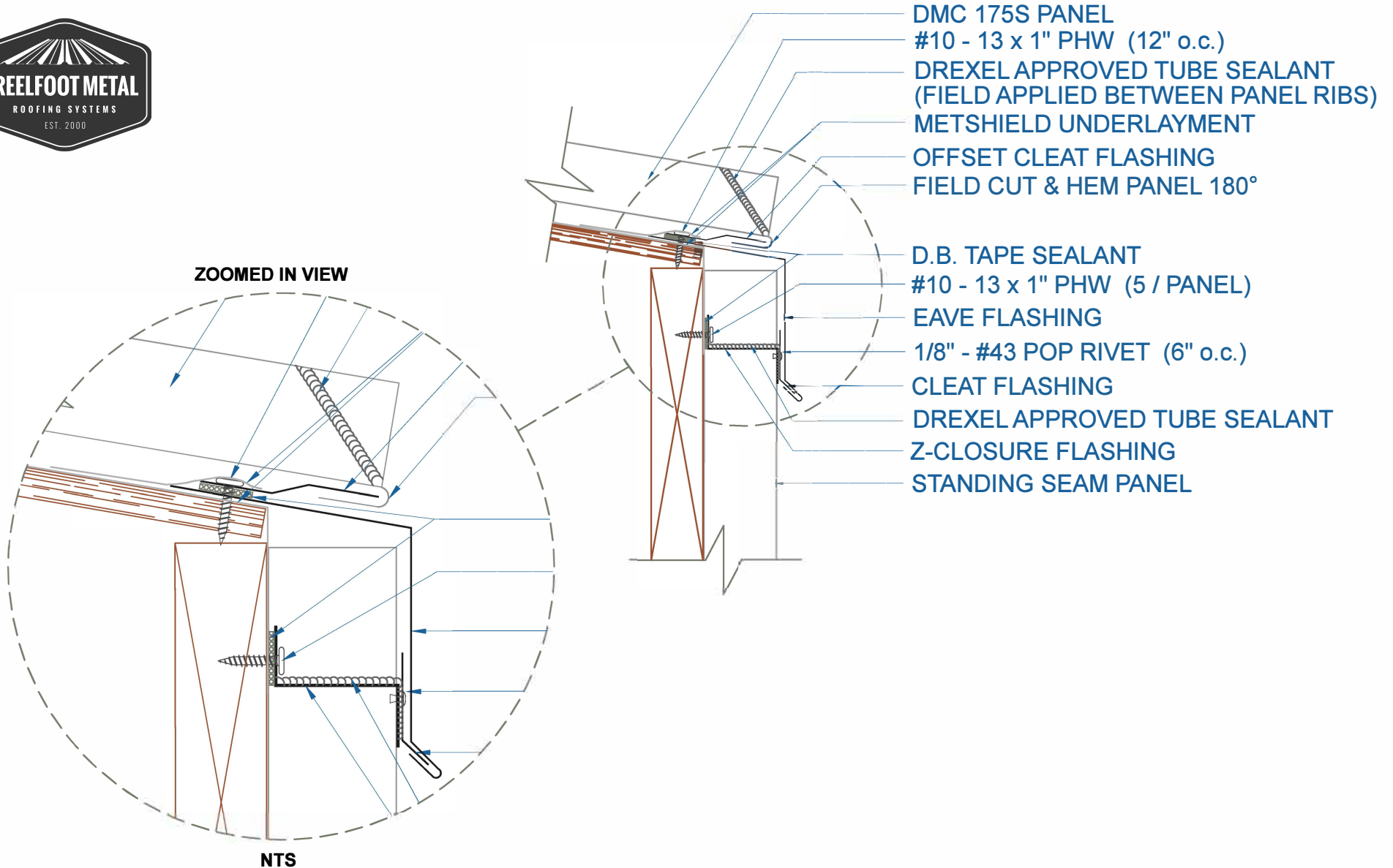

EAVE w/STANDING SEAM PANEL

EFFECTIVE DATE: 12-11-12
SUBJECT TO CHANGE WITHOUT NOTICE

SCALE: 3" = 1'-0"



DMC 175S - PLYWOOD

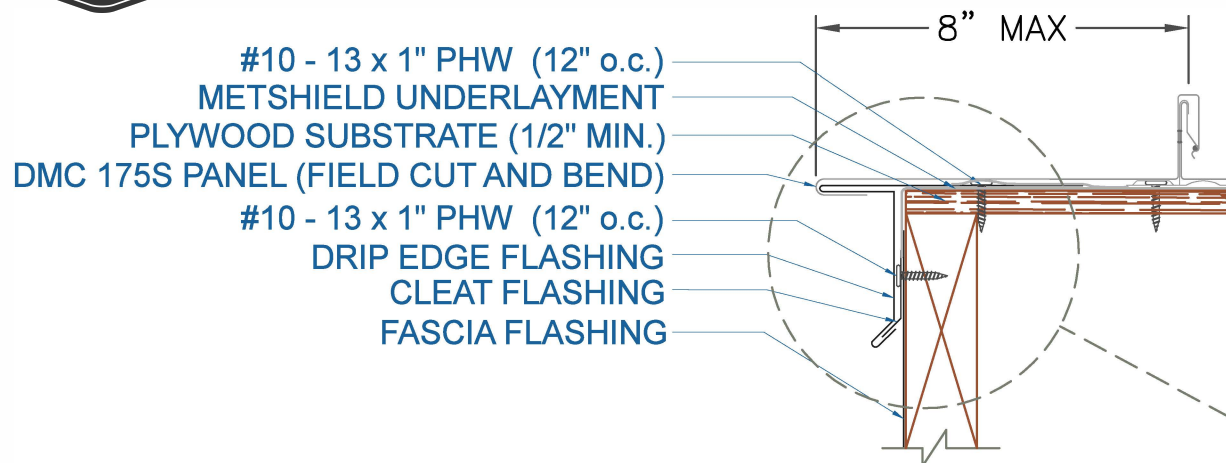

ZOOMED IN VIEW

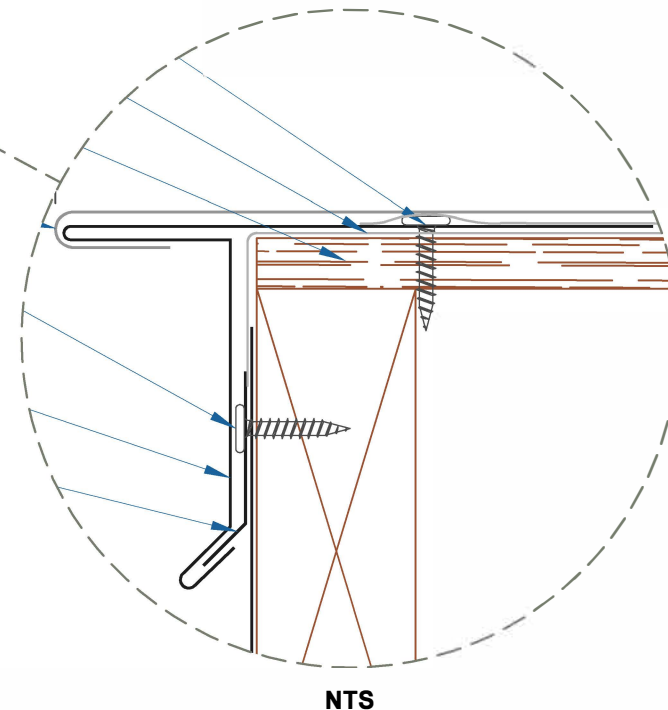

GABLE ALTERNATE / CURVED

EFFECTIVE DATE: 12- 12- 12
SUBJECT TO CHANGE WITHOUT NOTICE

SCALE: 3' = 1'-0"

DrexelMetals
Roofing Systems + Custom Fabrication



DMC 175S - PLYWOOD

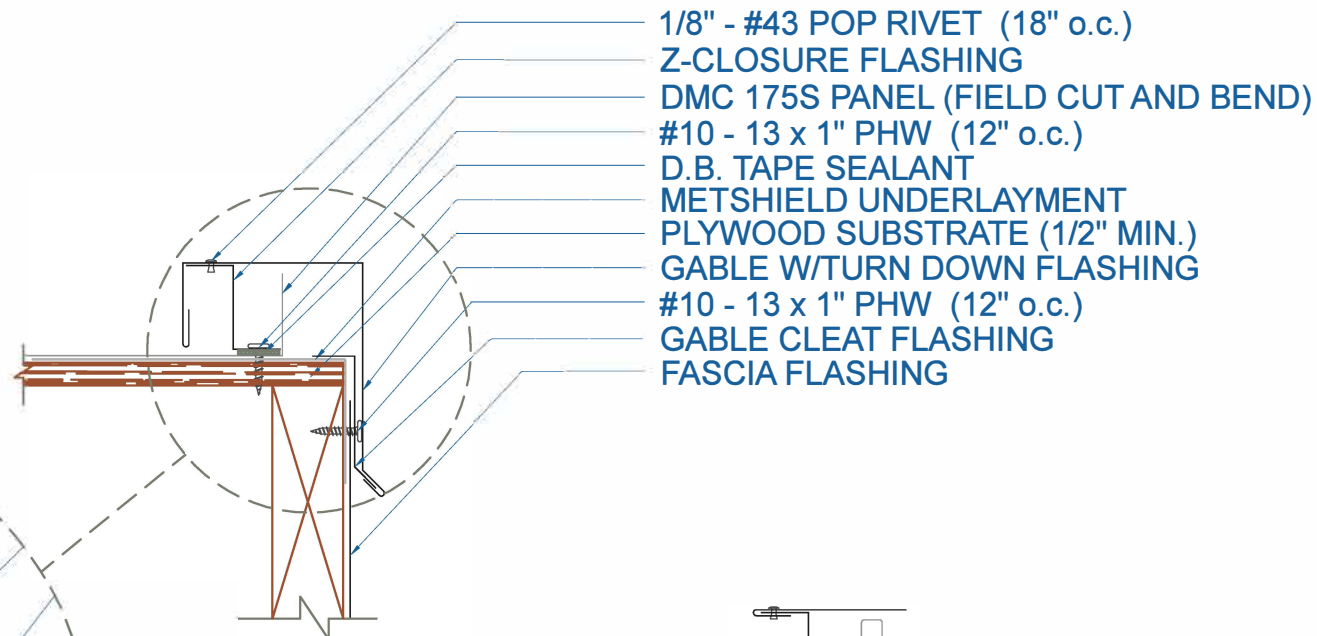

ZOOMED IN VIEW

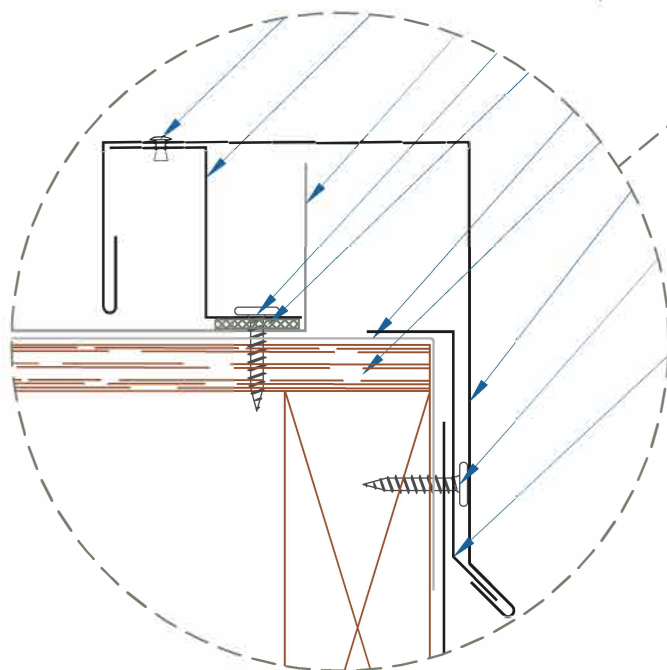

NTS

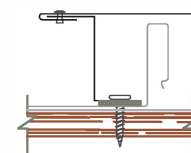

ON MODULE

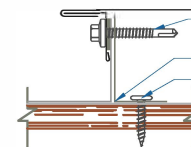

#12 - 14 x 1 1/2" DP3 SD
DREXMET HEAD (12" o.c.)
FLOATING RAKE ANGLE
#10 - 13 x 1" PHW (12" o.c.)
NOT TO BE TIGHTENED

FLOATING GABLE

GABLE w/TURN DOWN

SCALE: 3" = 1'-0"

EFFECTIVE DATE: 12-11-12
SUBJECT TO CHANGE WITHOUT NOTICE



DMC 175S - PLYWOOD

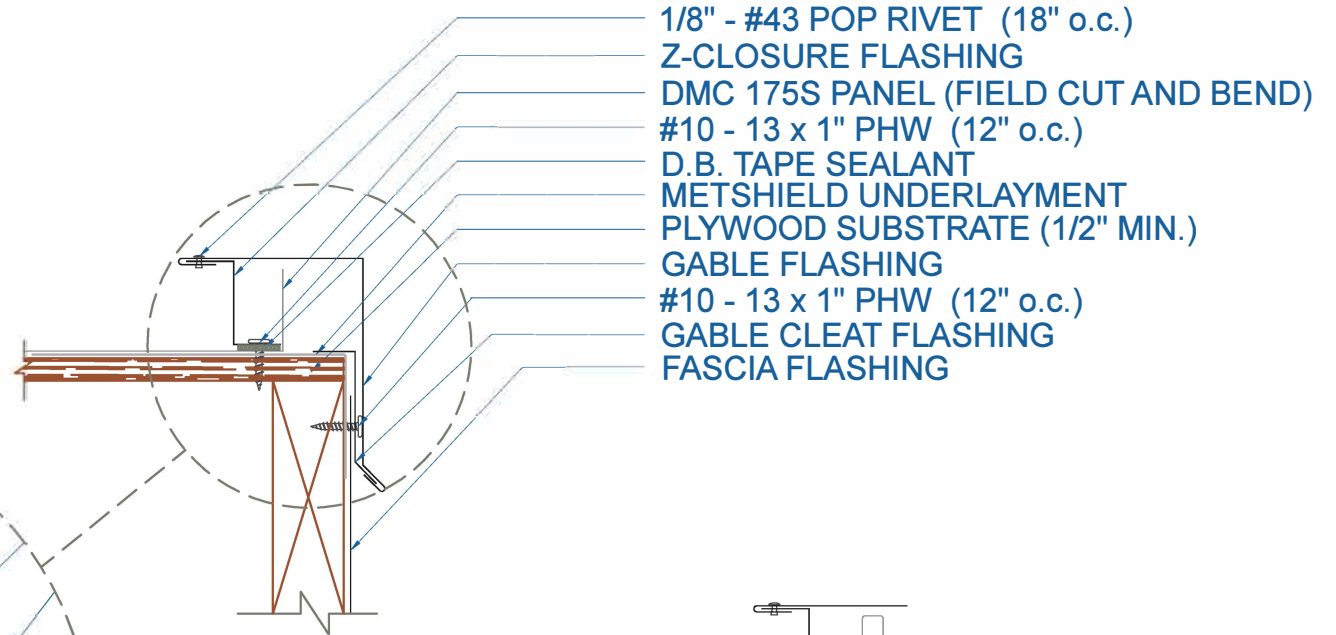

ZOOMED IN VIEW

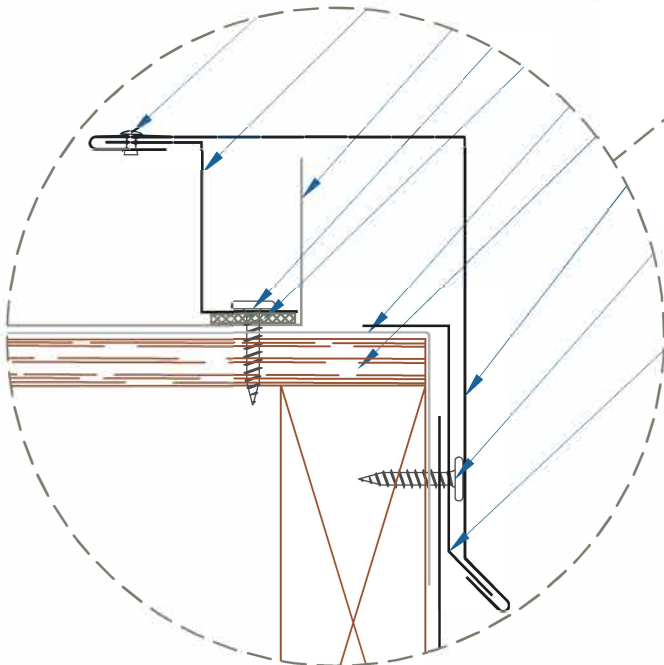

NTS

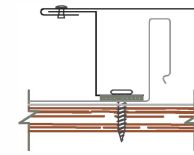

ON MODULE

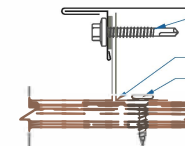

#12 - 14 x 1 1/2" DP3 SD
 DREXMET HEAD (12" o.c.)
 FLOATING RAKE ANGLE
 #10 - 13 x 1" PHW (12" o.c.)
 NOT TO BE TIGHTENED

FLOATING GABLE

EFFECTIVE DATE: 12-11-12
 SUBJECT TO CHANGE WITHOUT NOTICE

GABLE

SCALE: 3" = 1'-0"



DMC 175S - PLYWOOD

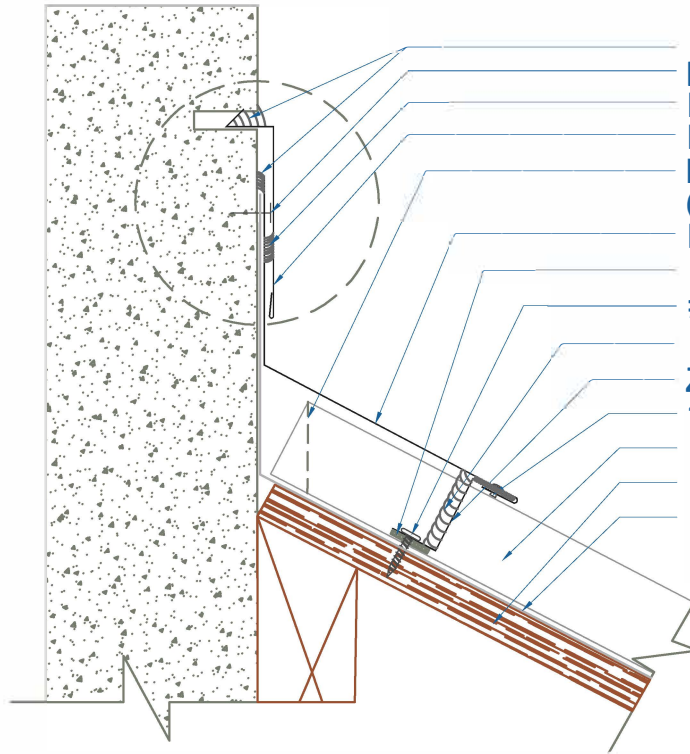

- DREXEL APPROVED TUBE SEALANT
- FASTENERS (BY OTHERS)
- DREXEL APPROVED TUBE SEALANT
- REGLET FLASHING
- BOX END OF PANEL
(SEE ZEE CLOSURE OPTIONS DETAIL)
- HEADWALL FLASHING
- D.B. TAPE SEALANT
- #10 - 13 x 1" PHW (5 PER PANEL)
- DREXEL APPROVED TUBE SEALANT
- Z-CLOSURE FLASHING
- 1/8" - #43 POP RIVET (18" o.c.)
- DMC 175S PANEL
- PLYWOOD SUBSTRATE (1/2" MIN.)
- METSHIELD UNDERLAYMENT

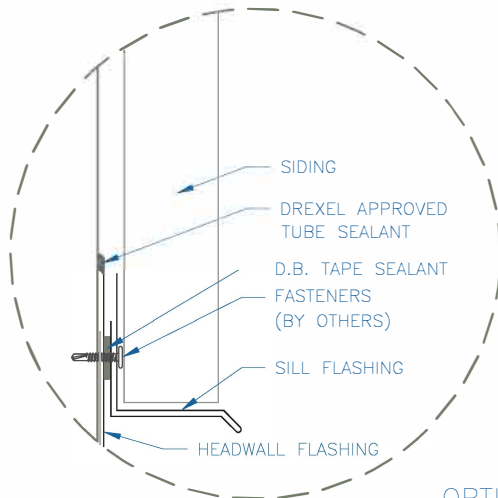

OPTION 1

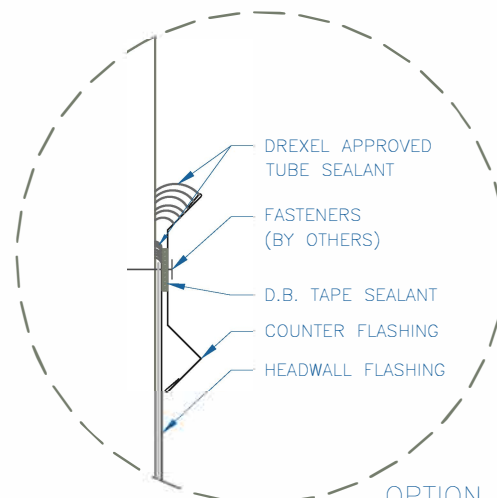

OPTION 2

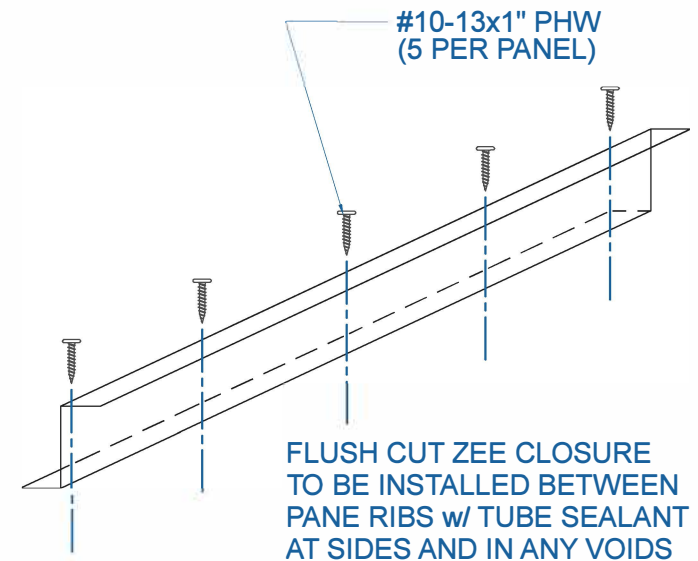

EFFECTIVE DATE: 12-11-12
SUBJECT TO CHANGE WITHOUT NOTICE

HEADWALL

SCALE: 3" = 1'-0"



DMC 175S - SOLID SUBSTRATE

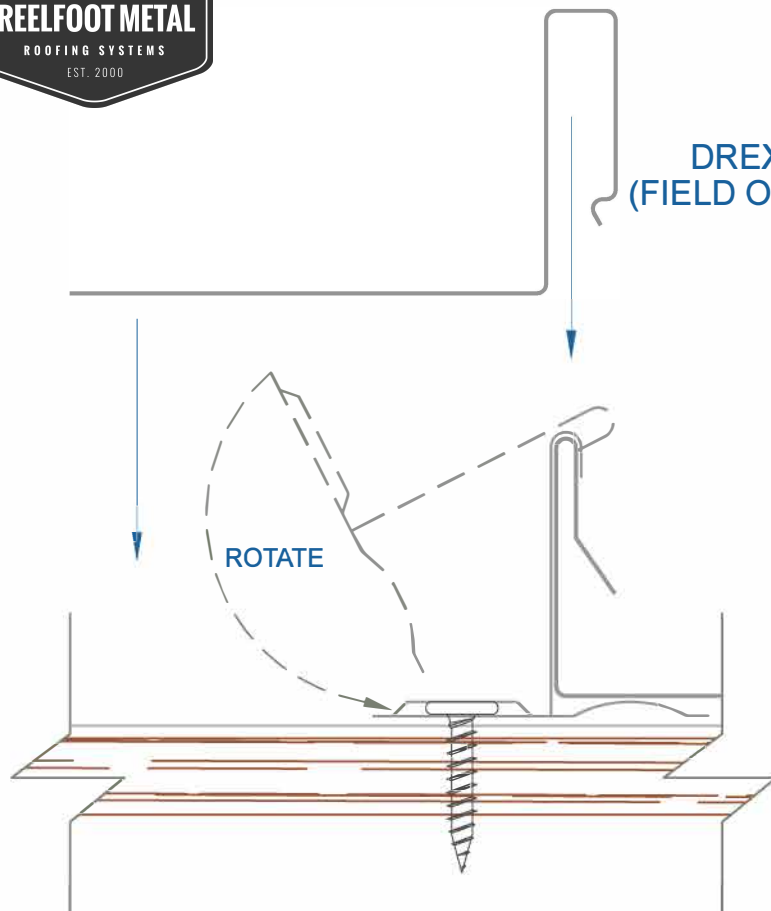

DREXEL APPROVED SEALANT (OPTIONAL)
(FIELD OR MACHINE APPLIED TUBE SEALANT)

DMC 175S PANEL

DMC 175S UL CLIP

#10 - 13 x 1" PHW (2 Per Clip)

METSHIELD UNDERLAYMENT

1/2" PLYWOOD MIN.

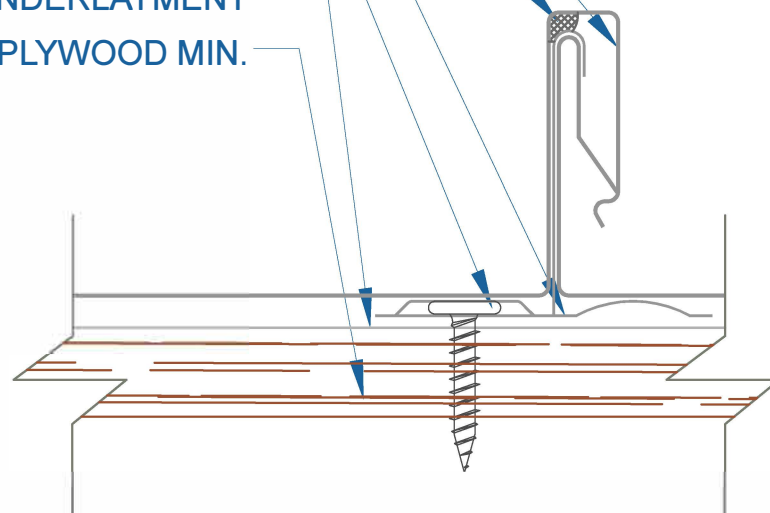

EFFECTIVE DATE: 06-13-2013
SUBJECT TO CHANGE WITHOUT NOTICE

PANEL INSTALLATION

SCALE: NTS

DrexelMetals
Roofing Systems + Custom Fabrication



DMC 175S - PLYWOOD

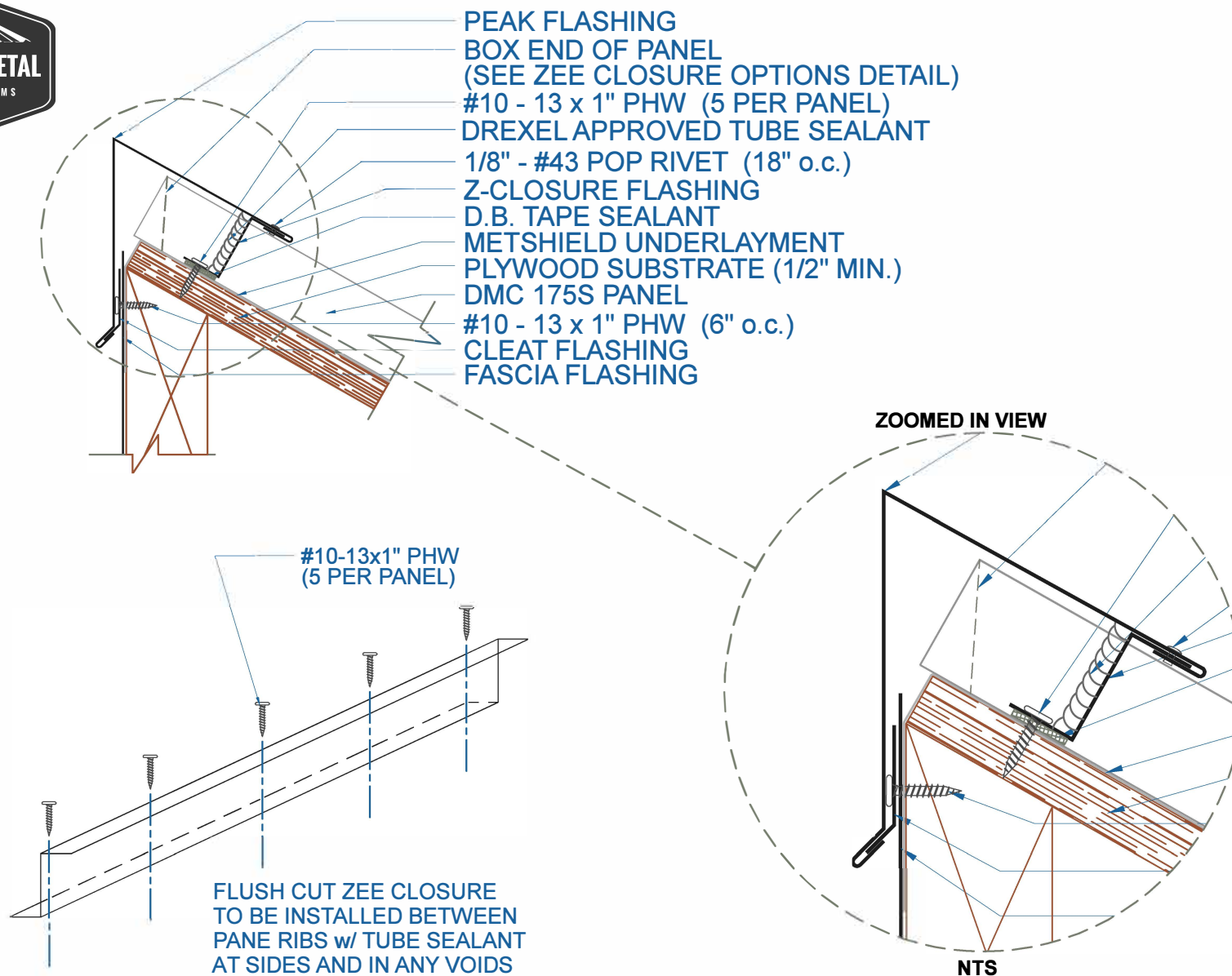

EFFECTIVE DATE: 12-11-12
 SUBJECT TO CHANGE WITHOUT NOTICE

PEAK
 SCALE: 3" = 1'-0"



DMC 175S - PLYWOOD

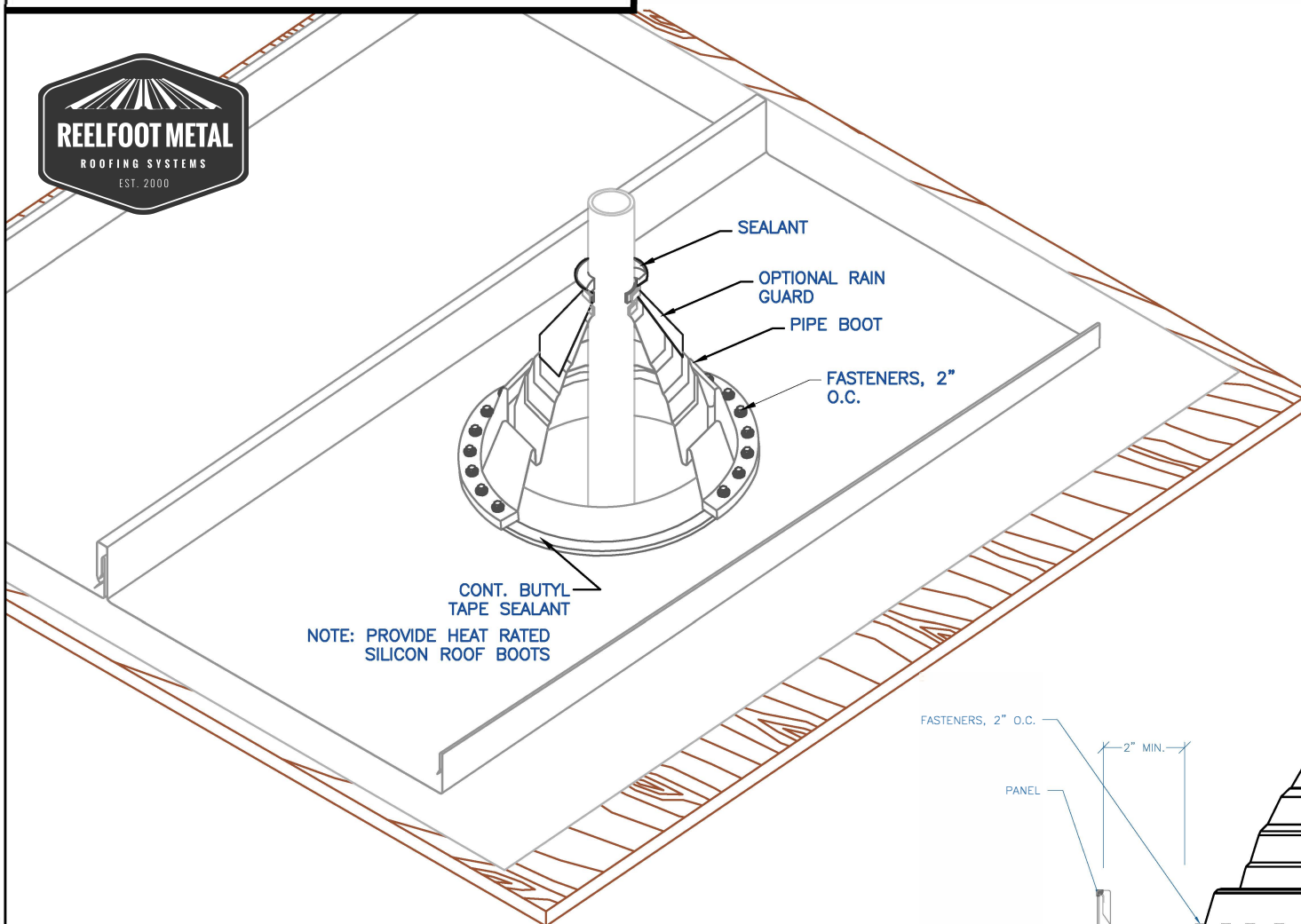

NOTE: PROVIDE HEAT RATED
SILICON ROOF BOOTS

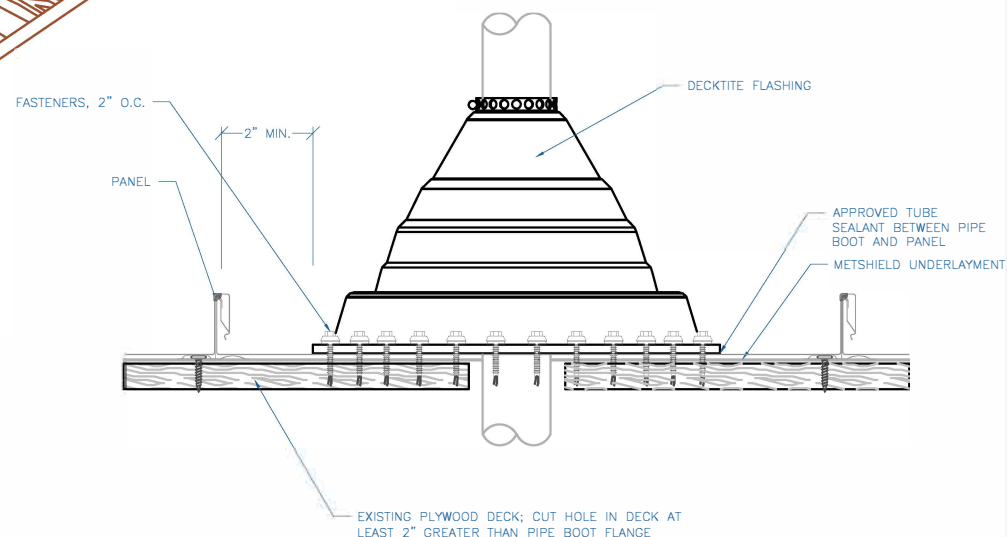

EFFECTIVE DATE: 01-18-2013
SUBJECT TO CHANGE WITHOUT NOTICE

PIPE FLASHING DETAIL

SCALE: NTS

DrexelMetals
Roofing Systems + Custom Fabrication



DMC 175S - PLYWOOD

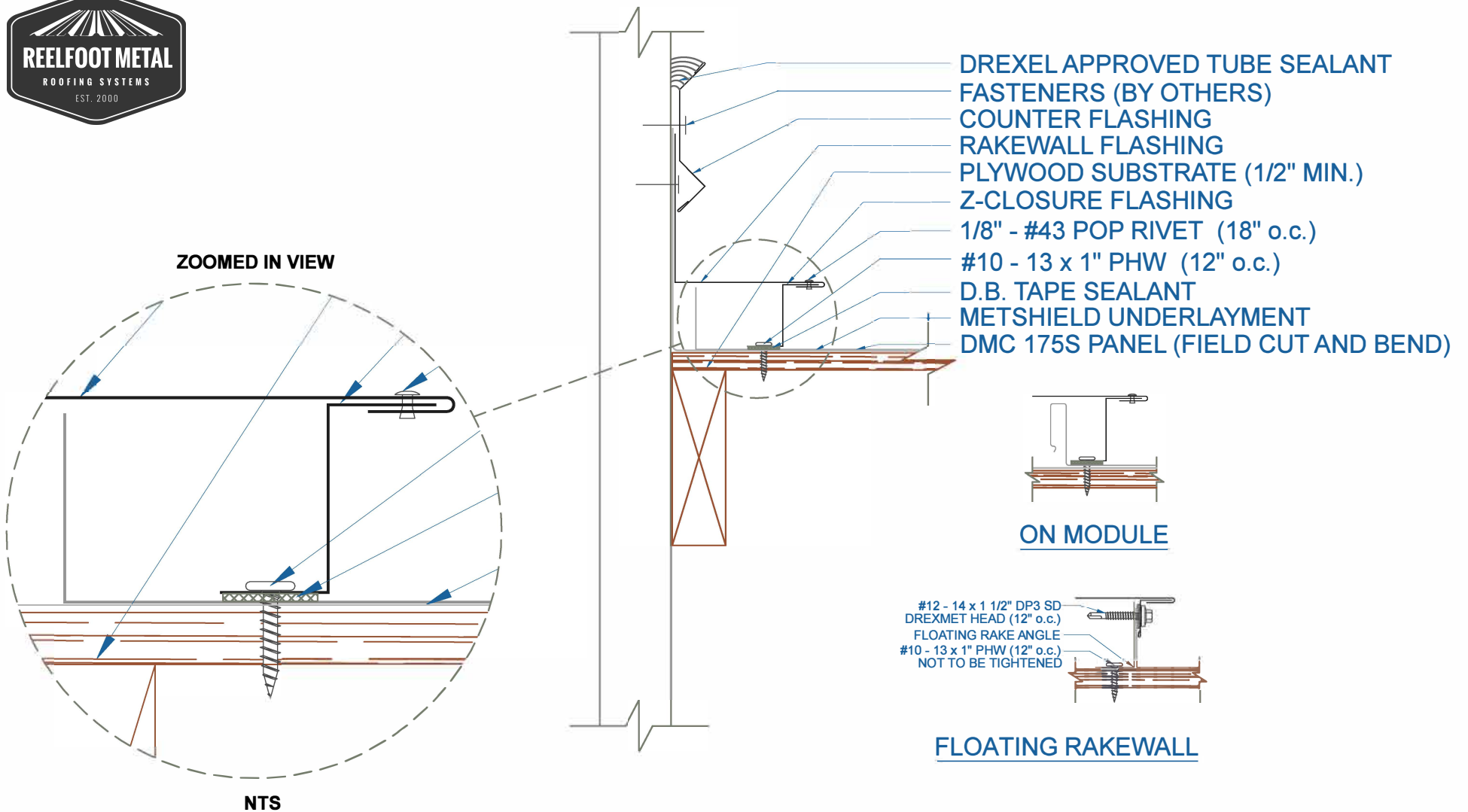

EFFECTIVE DATE: 12-11-12
SUBJECT TO CHANGE WITHOUT NOTICE

RAKEWALL
SCALE: 3" = 1'-0"

DMC 175S - PLYWOOD

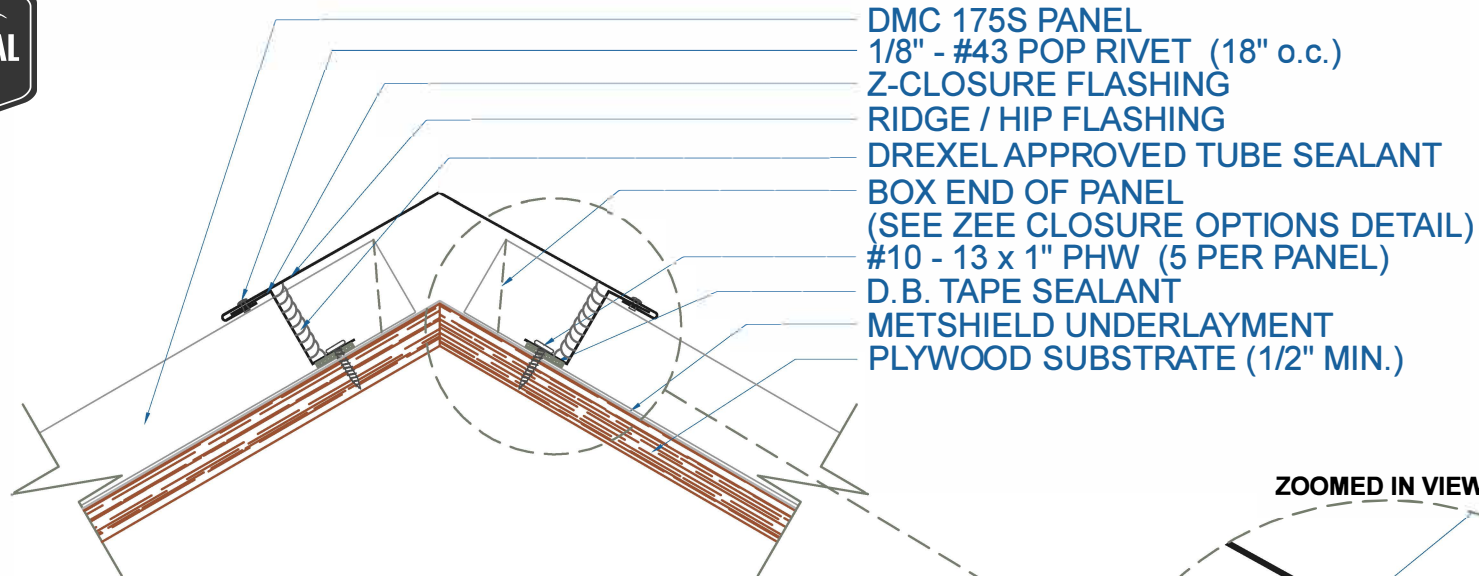

- DMC 175S PANEL
- 1/8" - #43 POP RIVET (18" o.c.)
- Z-CLOSURE FLASHING
- RIDGE / HIP FLASHING
- DREXEL APPROVED TUBE SEALANT
- BOX END OF PANEL
(SEE ZEE CLOSURE OPTIONS DETAIL)
- #10 - 13 x 1" PHW (5 PER PANEL)
- D.B. TAPE SEALANT
- METSHIELD UNDERLAYMENT
- PLYWOOD SUBSTRATE (1/2" MIN.)

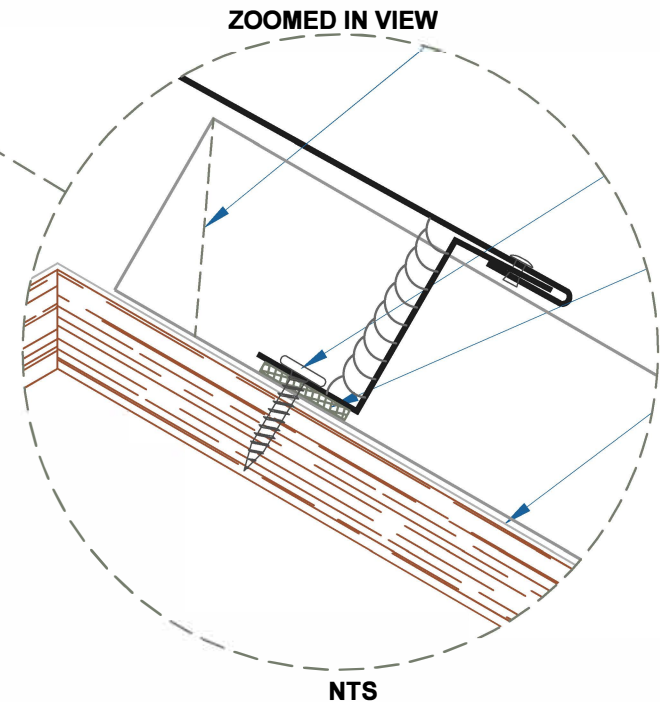
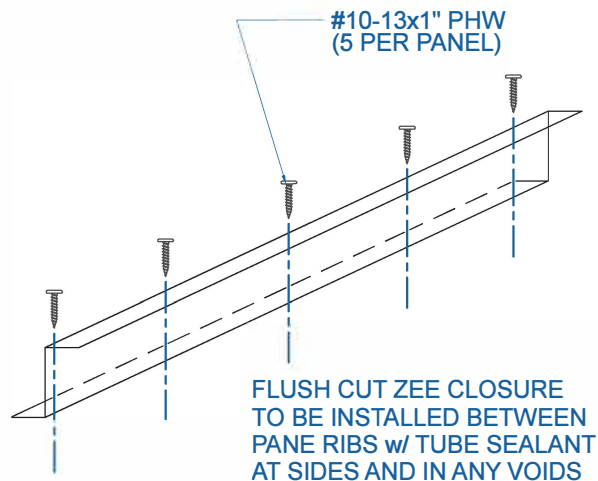

EFFECTIVE DATE: 12-11-12
SUBJECT TO CHANGE WITHOUT NOTICE

RIDGE / HIP

SCALE: 3" = 1'-0"

Drexel Metals
Roofing Systems + Custom Fabrication



DMC 175S - PLYWOOD



DMC 175S PANEL

#10 - 13 x 1" PHW (12" o.c.)

D.B. TAPE SEALANT

OFFSET CLEAT FLASHING

FIELD CUT & HEM PANEL 180°

BOX END OF PANEL

(SEE ZEE CLOSURE OPTIONS DETAIL)

TRANSITION FLASHING

1/8" - #43 POP RIVET (18" o.c.)

Z-CLOSURE

#10 - 13 x 1" PHW (5 PER PANEL)

D.B. TAPE SEALANT

PLYWOOD SUBSTRATE (1/2" MIN.)

DMC 175S PANEL

METSHIELD UNDERLAYMENT

DREXEL APPROVED TUBE SEALANT
(FIELD APPLIED BETWEEN PANEL RIBS)

ZOOMED IN VIEW

ZOOMED IN VIEW

#10-13x1" PHW
(5 PER PANEL)

FLUSH CUT ZEE CLOSURE
TO BE INSTALLED BETWEEN
PANE RIBS w/ TUBE SEALANT
AT SIDES AND IN ANY VOIDS

NTS

NTS

TRANSITION

SCALE: 3" = 1'-0"

EFFECTIVE DATE: 12-12-12
SUBJECT TO CHANGE WITHOUT NOTICE

DrexelMetals
Roofing Systems + Custom Fabrication



DMC 175S - PLYWOOD



ZOOMED IN VIEW

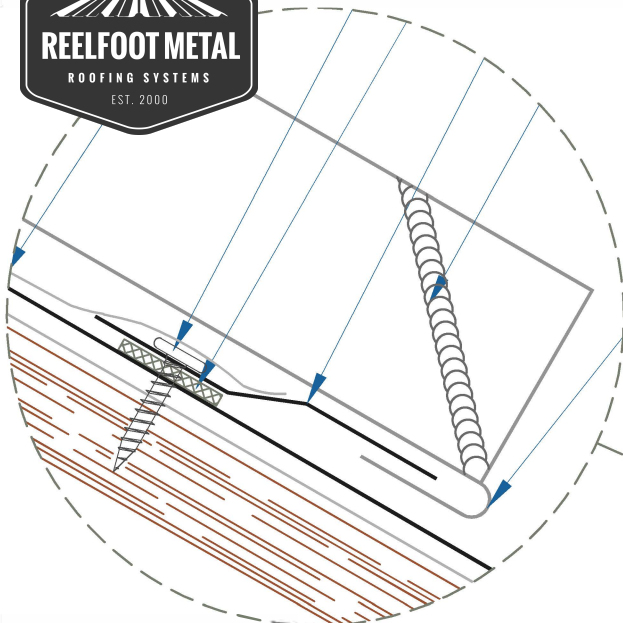

NTS

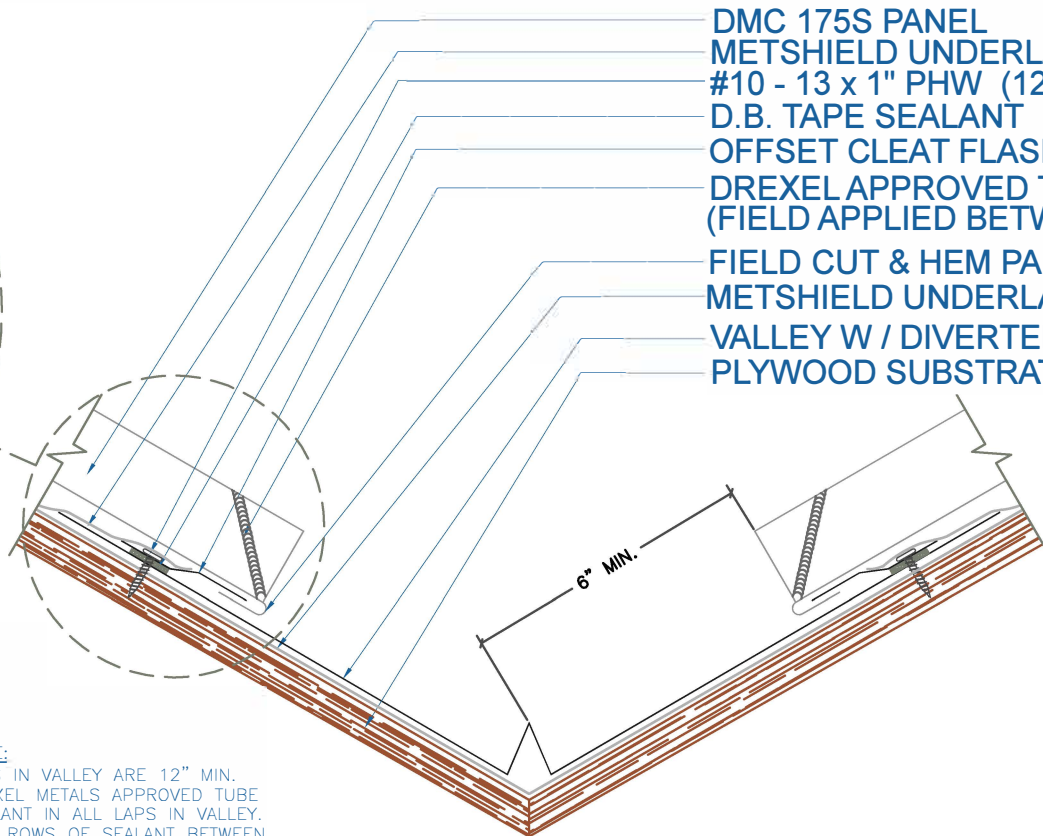

DMC 175S PANEL
 METSHIELD UNDERLAYMENT
 #10 - 13 x 1" PHW (12" o.c.)
 D.B. TAPE SEALANT
 OFFSET CLEAT FLASHING
 DREXEL APPROVED TUBE SEALANT
 (FIELD APPLIED BETWEEN PANEL RIBS)
 FIELD CUT & HEM PANEL 180°
 METSHIELD UNDERLAYMENT
 VALLEY W / DIVERTER FLASHING
 PLYWOOD SUBSTRATE (1/2" MIN.)

NOTE:

- 1.) LAPS IN VALLEY ARE 12" MIN.
 DREXEL METALS APPROVED TUBE
 SEALANT IN ALL LAPS IN VALLEY.
 TWO ROWS OF SEALANT BETWEEN
 VALLEY LAPS, 4" UP FROM LAP.
- 2.) LARGE ROOF AREAS MAY REQUIRE
 A LARGER GAP BETWEEN PANEL
 AND DIVERTER TO ALLOW FOR
 STORM WATER RUN OFF.

VALLEY W / DIVERTER

SCALE: 3" = 1'-0"

EFFECTIVE DATE: 12-12-12
 SUBJECT TO CHANGE WITHOUT NOTICE

DrexelMetals
 Roofing Systems + Custom Fabrication



DMC 175S - PLYWOOD



ZOOMED IN VIEW

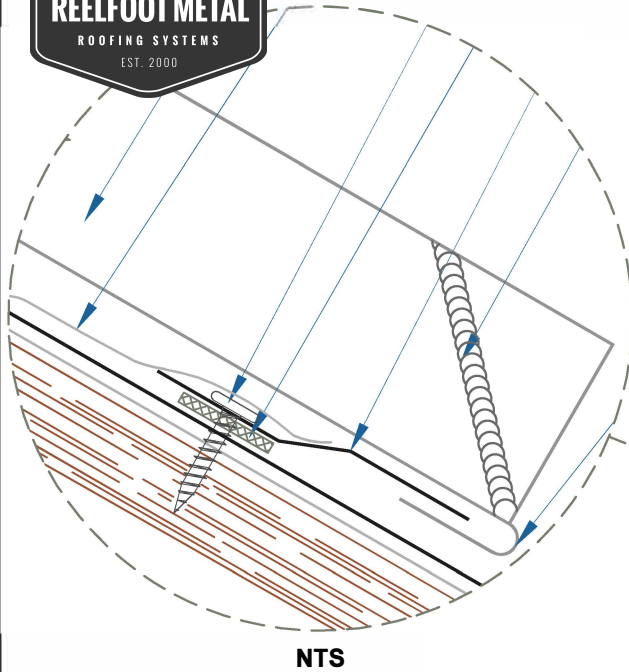

NTS

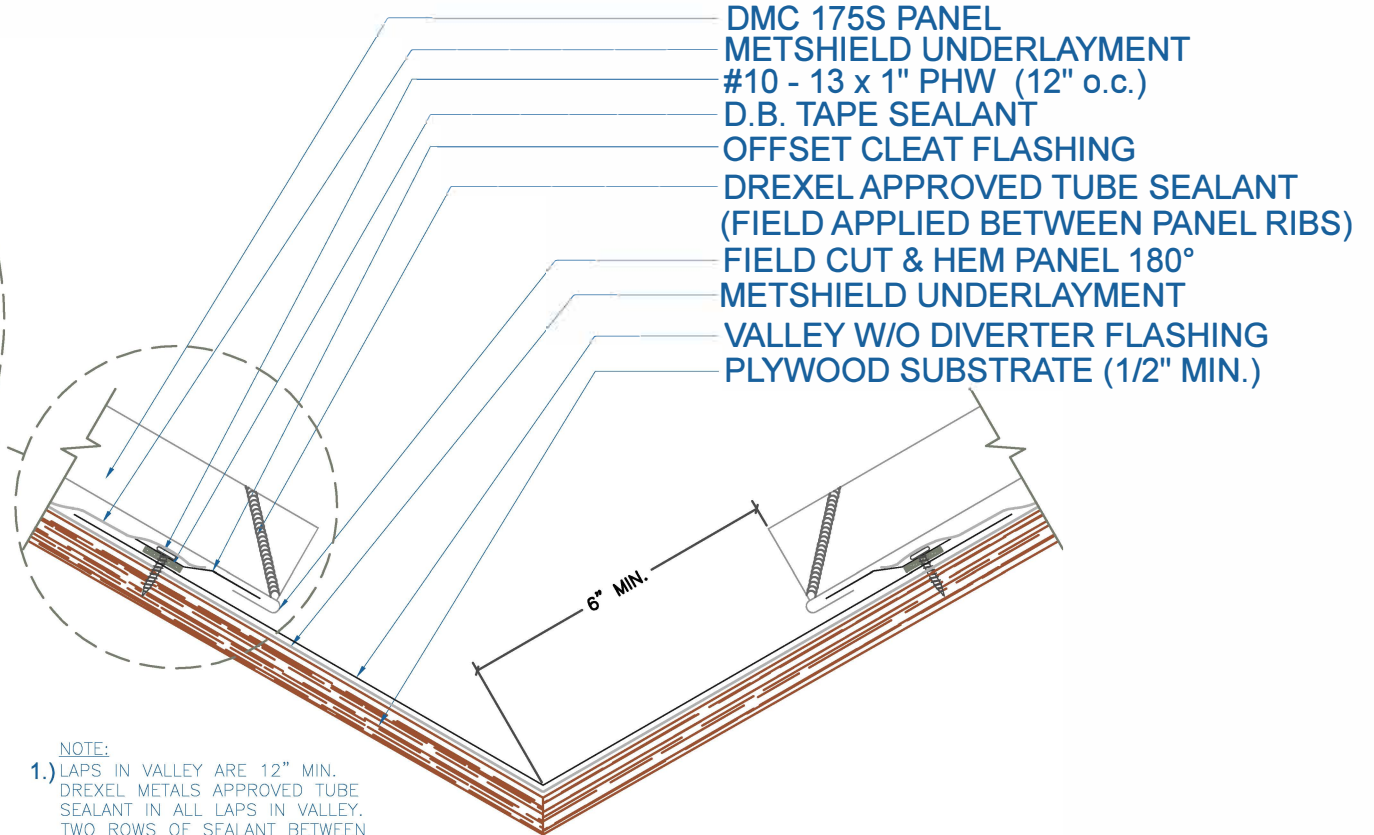

NOTE:

- 1.) LAPS IN VALLEY ARE 12" MIN.
DREXEL METALS APPROVED TUBE SEALANT IN ALL LAPS IN VALLEY.
TWO ROWS OF SEALANT BETWEEN VALLEY LAPS, 4" UP FROM LAP.
- 2.) LARGE ROOF AREAS MAY REQUIRE A LARGER GAP BETWEEN PANEL AND DIVERTER TO ALLOW FOR STORM WATER RUN OFF.

VALLEY W/O DIVERTER

SCALE: 3" = 1'-0"

Drexel Metals
Roofing Systems + Custom Fabrication

EFFECTIVE DATE: 12-12-12
SUBJECT TO CHANGE WITHOUT NOTICE

DMC 175S - PLYWOOD



NOTE:

- 1.) LAPS IN VALLEYWALL ARE 12" MIN. DREXEL METALS APPROVED SEALANT IN ALL LAPS IN VALLEY. TWO ROWS OF SEALANT BETWEEN VALLEYWALL LAPS, 4" UP FROM LAP.
- 2.) LARGE ROOF AREAS MAY REQUIRE A LARGER GAP BETWEEN PANEL AND WALL TO ALLOW FOR STORM WATER RUN OFF.

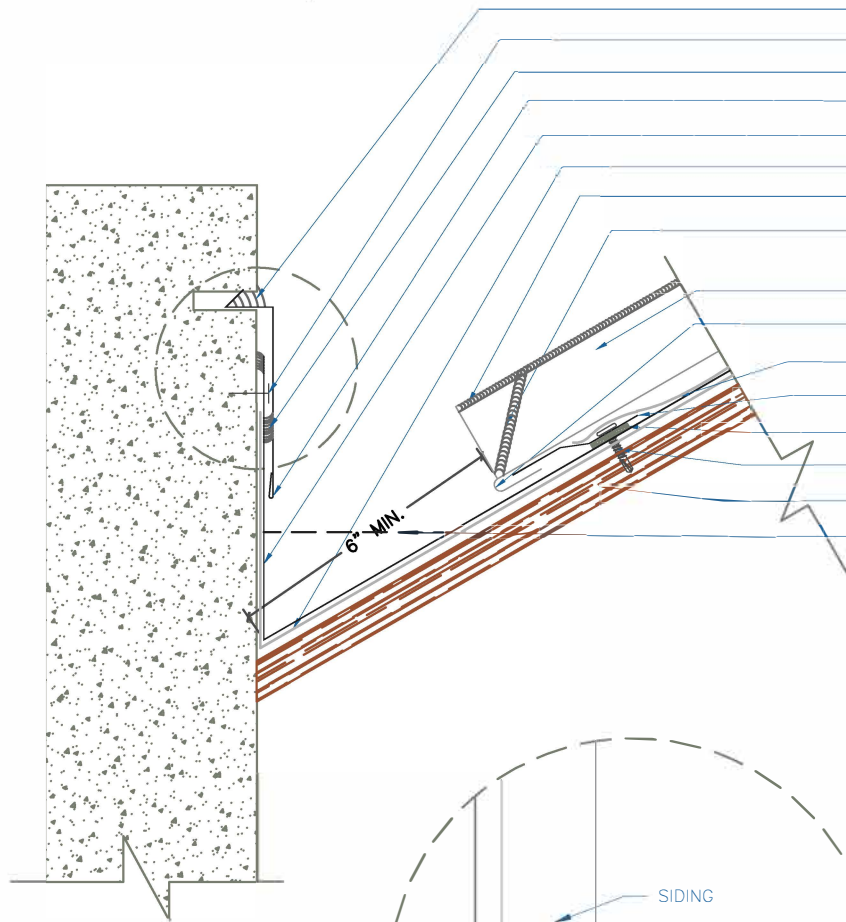

DREXEL APPROVED TUBE SEALANT
 FASTENERS (BY OTHERS)
 DREXEL APPROVED TUBE SEALANT
 REGLET FLASHING
 VALLEYWALL FLASHING
 METSHIELD UNDERLAYMENT
 SEAM SEALANT (3'-0" UP FROM RIB END)
 DREXEL APPROVED TUBE SEALANT
 (FIELD APPLIED BETWEEN PANEL RIBS)
 DMC 175S PANEL
 FIELD CUT & HEM PANEL 180°
 METSHIELD UNDERLAYMENT
 OFFSET CLEAT FLASHING
 D.B. TAPE SEALANT
 #10 - 13 x 1" PHW (12" o.c.)
 PLYWOOD SUBSTRATE (1/2" MIN.)
 CRICKET BEYOND

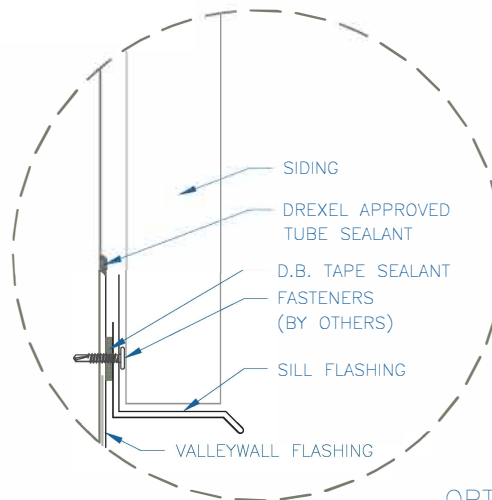

OPTION 1

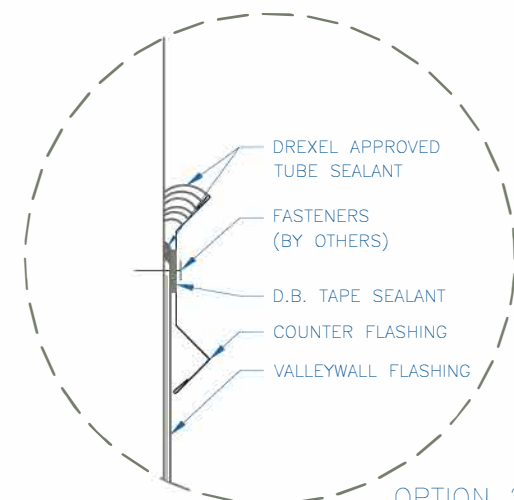

OPTION 2

VALLEYWALL

SCALE: 3" = 1'-0"

EFFECTIVE DATE: 12-12-12
SUBJECT TO CHANGE WITHOUT NOTICE

Drexel Metals
Roofing Systems + Custom Fabrication



DMC 175S - PLYWOOD

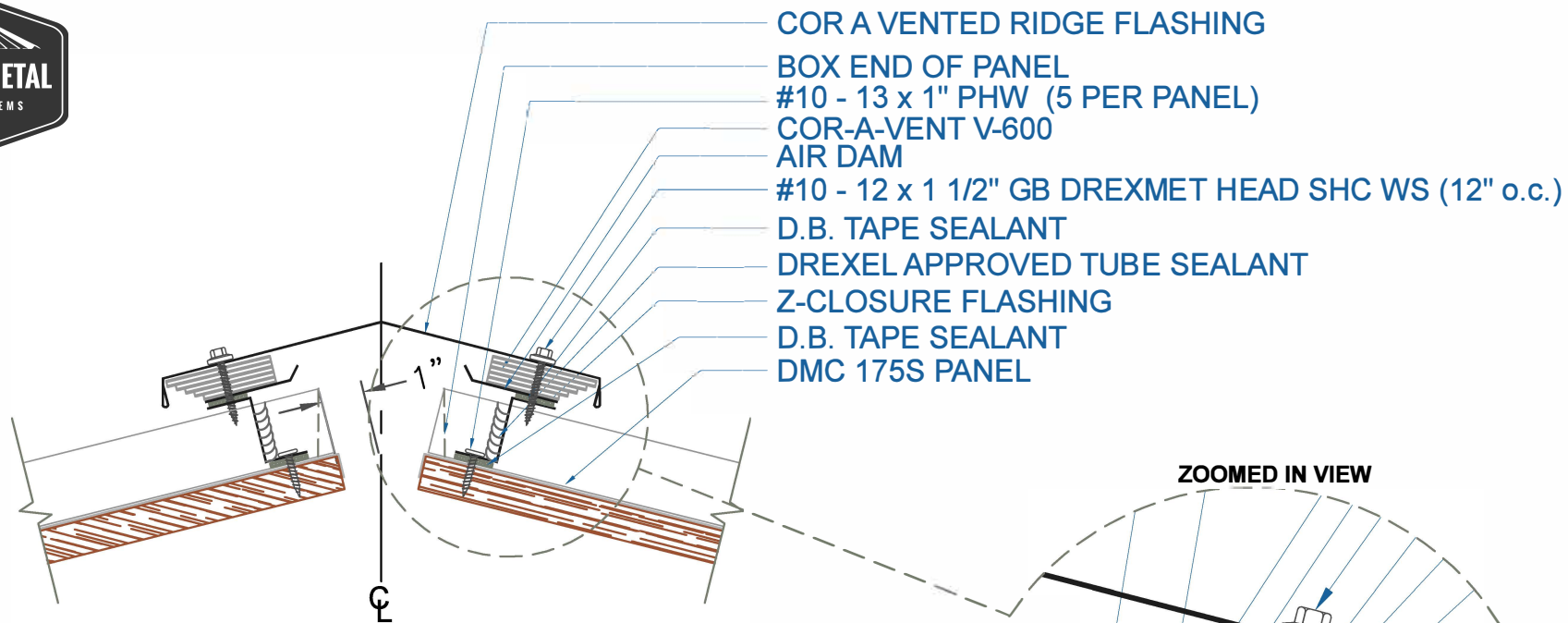

- COR A VENTED RIDGE FLASHING
- BOX END OF PANEL
- #10 - 13 x 1" PHW (5 PER PANEL)
- COR-A-VENT V-600
- AIR DAM
- #10 - 12 x 1 1/2" GB DREXMET HEAD SHC WS (12" o.c.)
- D.B. TAPE SEALANT
- DREXEL APPROVED TUBE SEALANT
- Z-CLOSURE FLASHING
- D.B. TAPE SEALANT
- DMC 175S PANEL

NOTE:
1.) NET FREE AREA = 20 SQ IN/FT

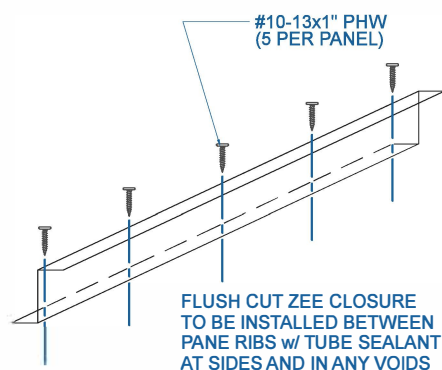

#10-13x1" PHW
(5 PER PANEL)

FLUSH CUT ZEE CLOSURE
TO BE INSTALLED BETWEEN
PANE RIBS w/ TUBE SEALANT
AT SIDES AND IN ANY VOIDS

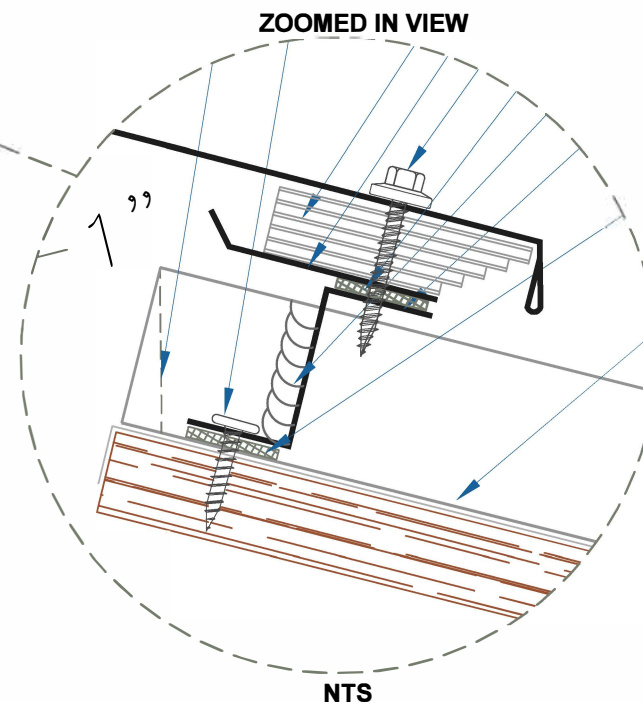

COR-A-VENTED RIDGE / HIP

SCALE: 3" = 1'-0"

EFFECTIVE DATE: 1-9-13
SUBJECT TO CHANGE WITHOUT NOTICE

DrexelMetals
Roofing Systems + Custom Fabrication



DMC 175S - PLYWOOD

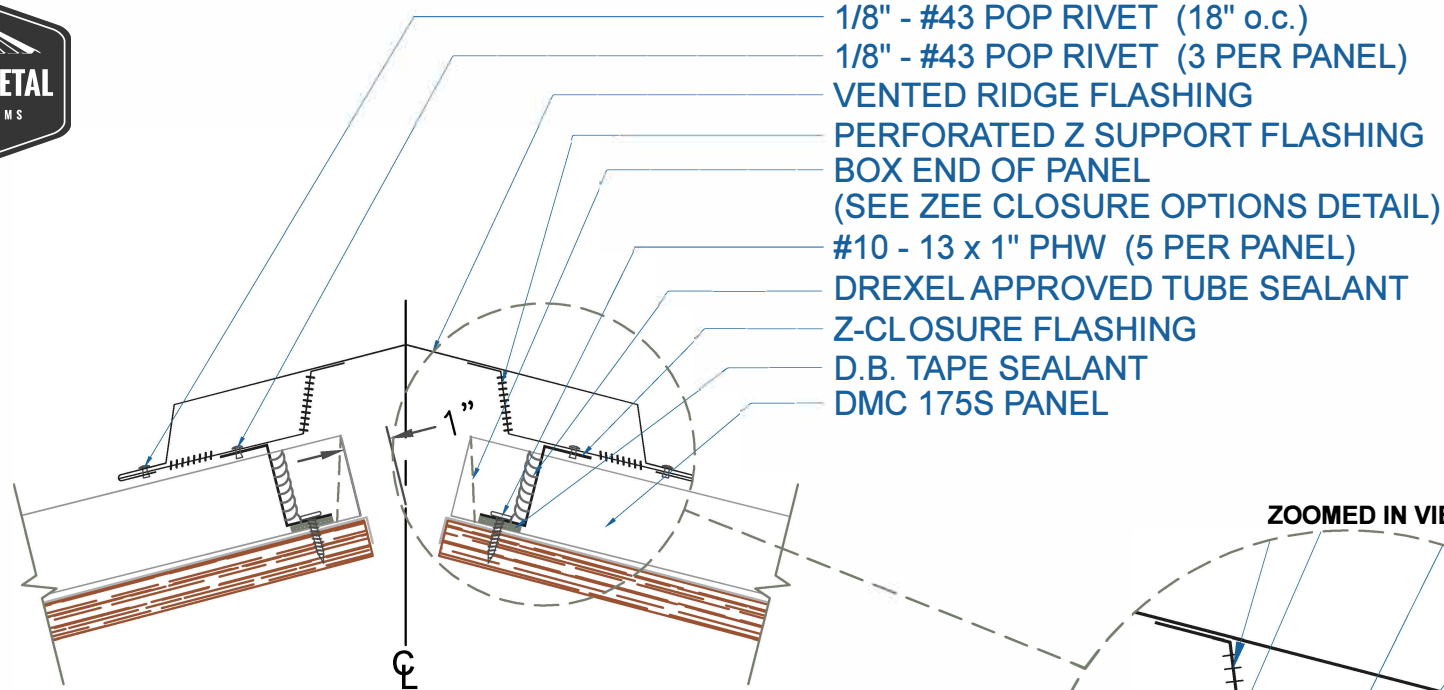

NOTE:
 1.) NET FREE AREA = 6.16 SQ IN/FT

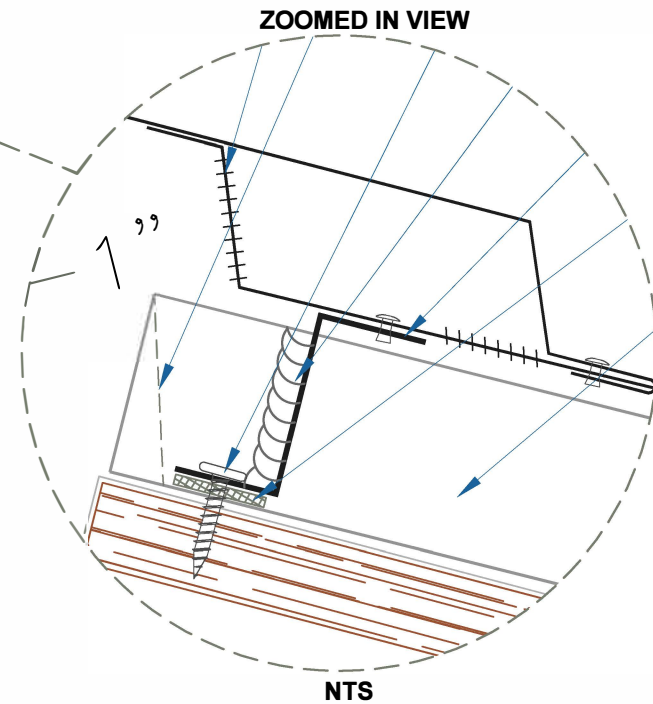
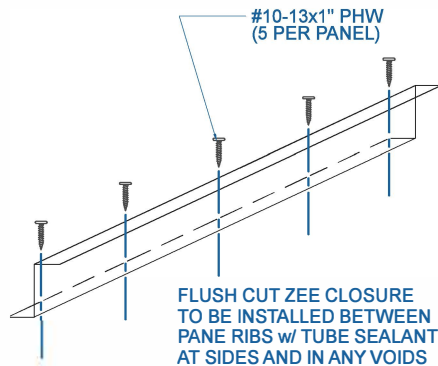

EFFECTIVE DATE: 12-12-12
 SUBJECT TO CHANGE WITHOUT NOTICE

VENTED RIDGE / HIP

SCALE: 3" = 1'-0"

DrexelMetals
 Roofing Systems + Custom Fabrication

