

DMC 100NS - SOLID SUBSTRATE

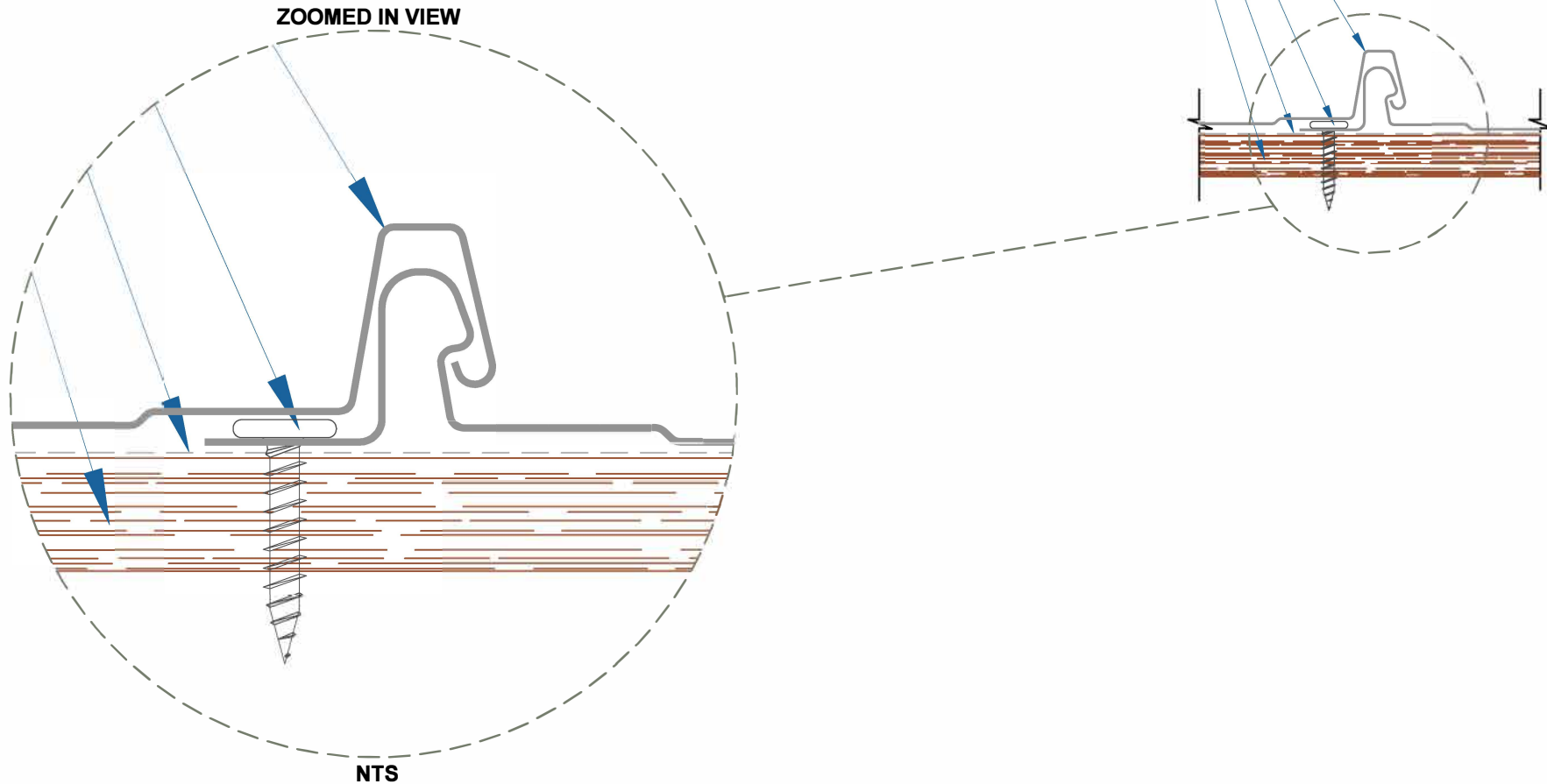

DMC 100NS PANEL
#10 - 13 x 1" PHW (10.5"o.c.)
METSHIELD UNDERLAYMENT
1/2" PLYWOOD MIN.



EFFECTIVE DATE: 02-22-13
SUBJECT TO CHANGE WITHOUT NOTICE

INSTALLATION DETAIL

SCALE: 6" = 1'-0"

DrexelMetals
Roofing Systems + Custom Fabrication



DMC 100NS - PLYWOOD



ZOOMED IN VIEW

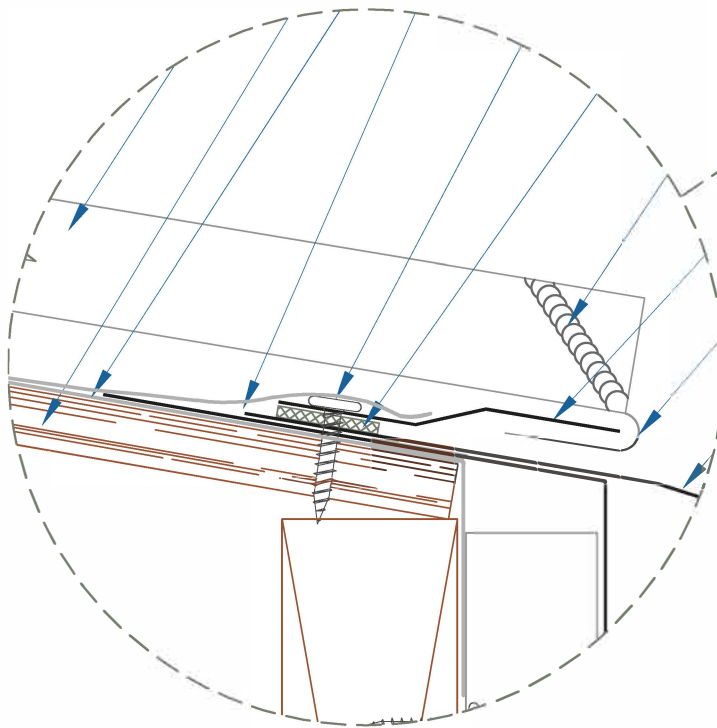

NTS

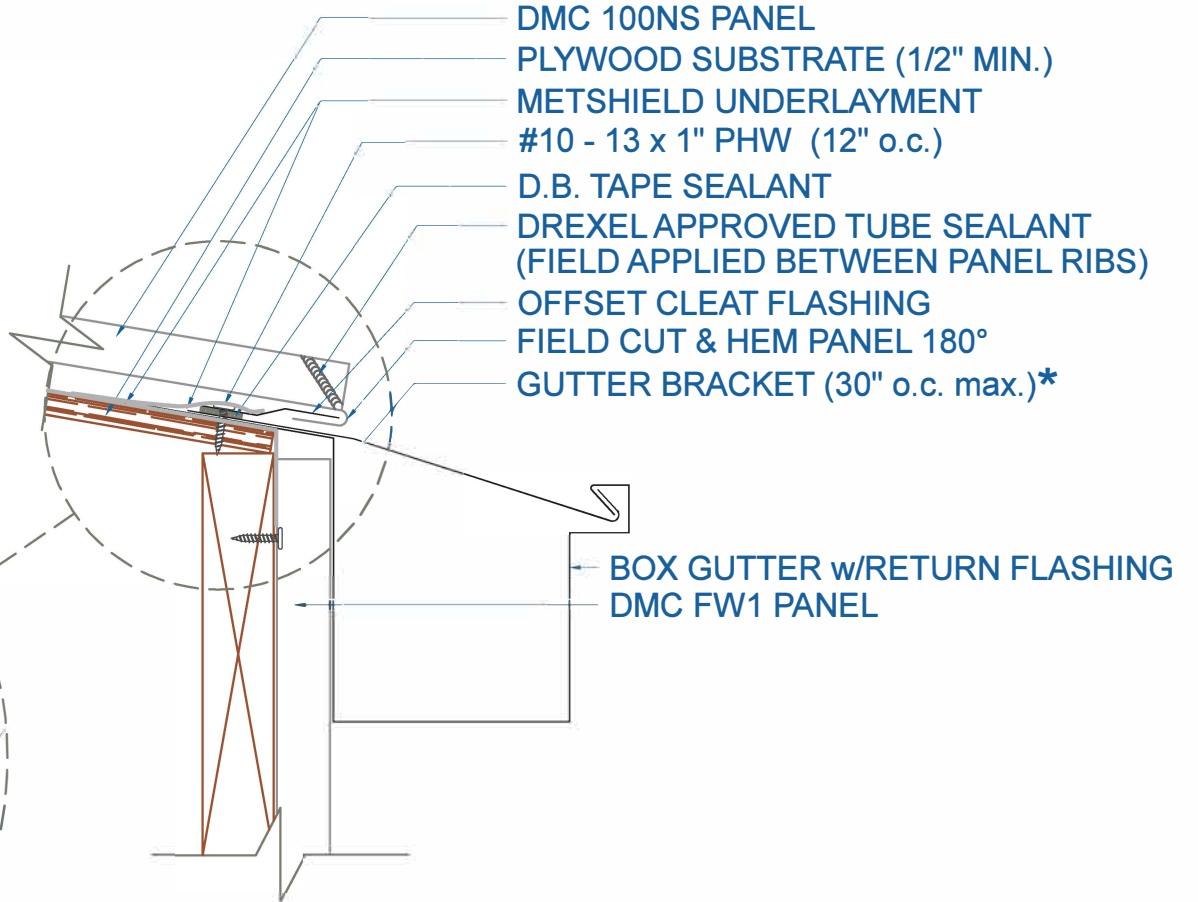

NOTE:
* DESIGN LOADS MAY REQUIRE
CLOSER SPACING.

BOX GUTTER - w/RETURN w/FLUSH PANEL

EFFECTIVE DATE: 02-15-2013
SUBJECT TO CHANGE WITHOUT NOTICE

SCALE: 3" = 1'-0"

Drexel Metals
Roofing Systems + Custom Fabrication



DMC 100NS - PLYWOOD

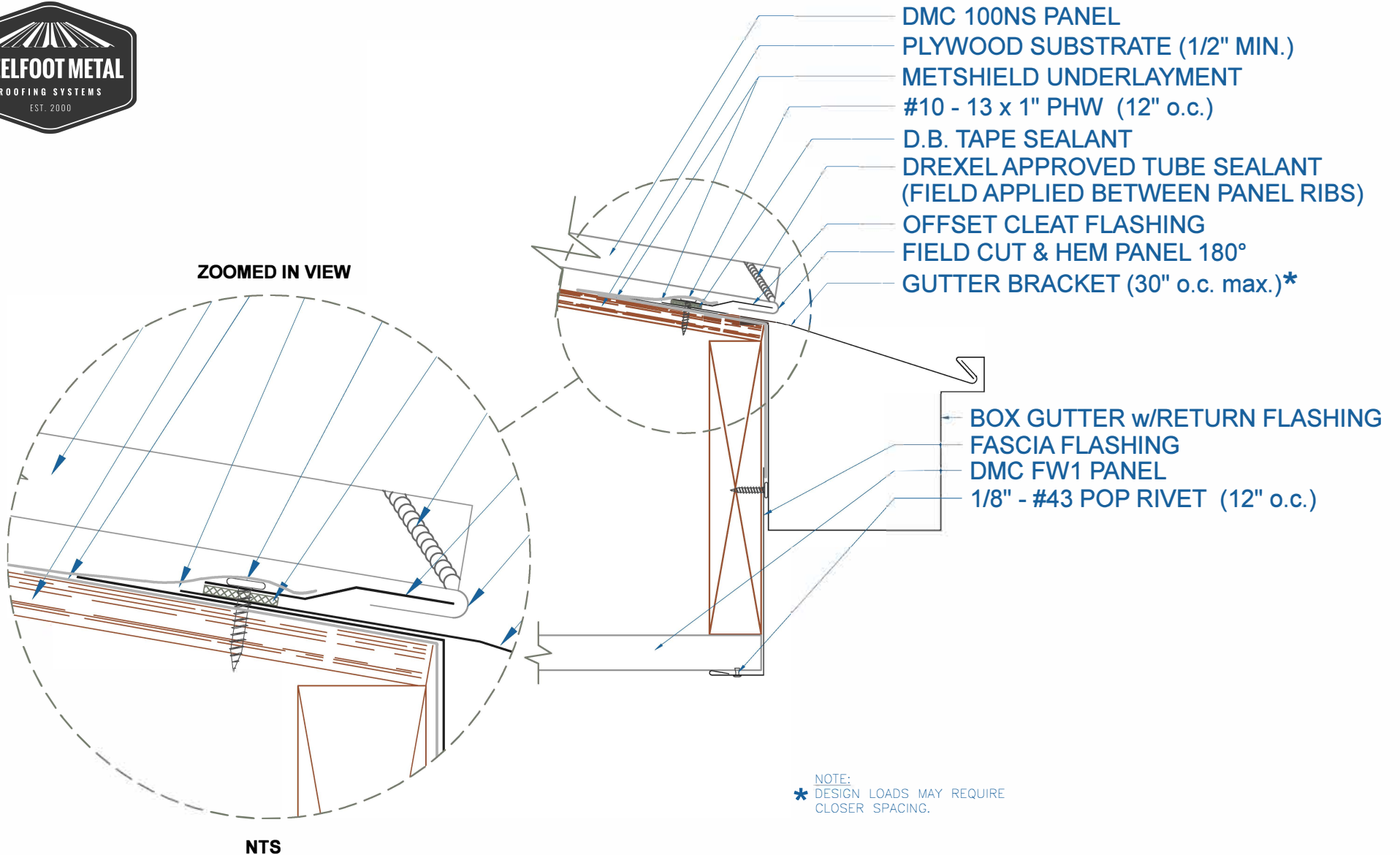

BOX GUTTER - w/RETURN w/SOFFIT

EFFECTIVE DATE: 02-15-13
SUBJECT TO CHANGE WITHOUT NOTICE

SCALE: 3" = 1'-0"



DMC 100NS - PLYWOOD



ZOOMED IN VIEW

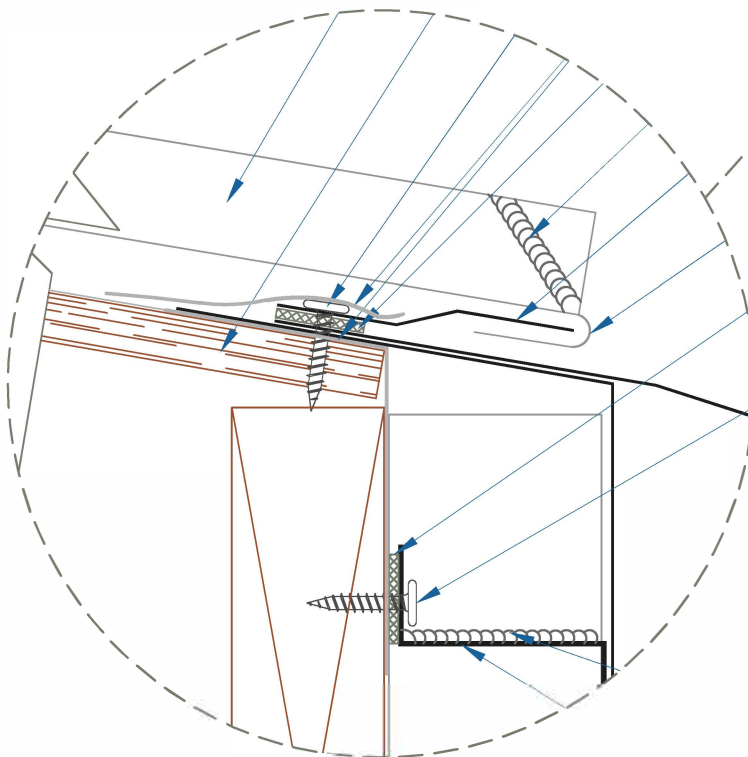

NTS

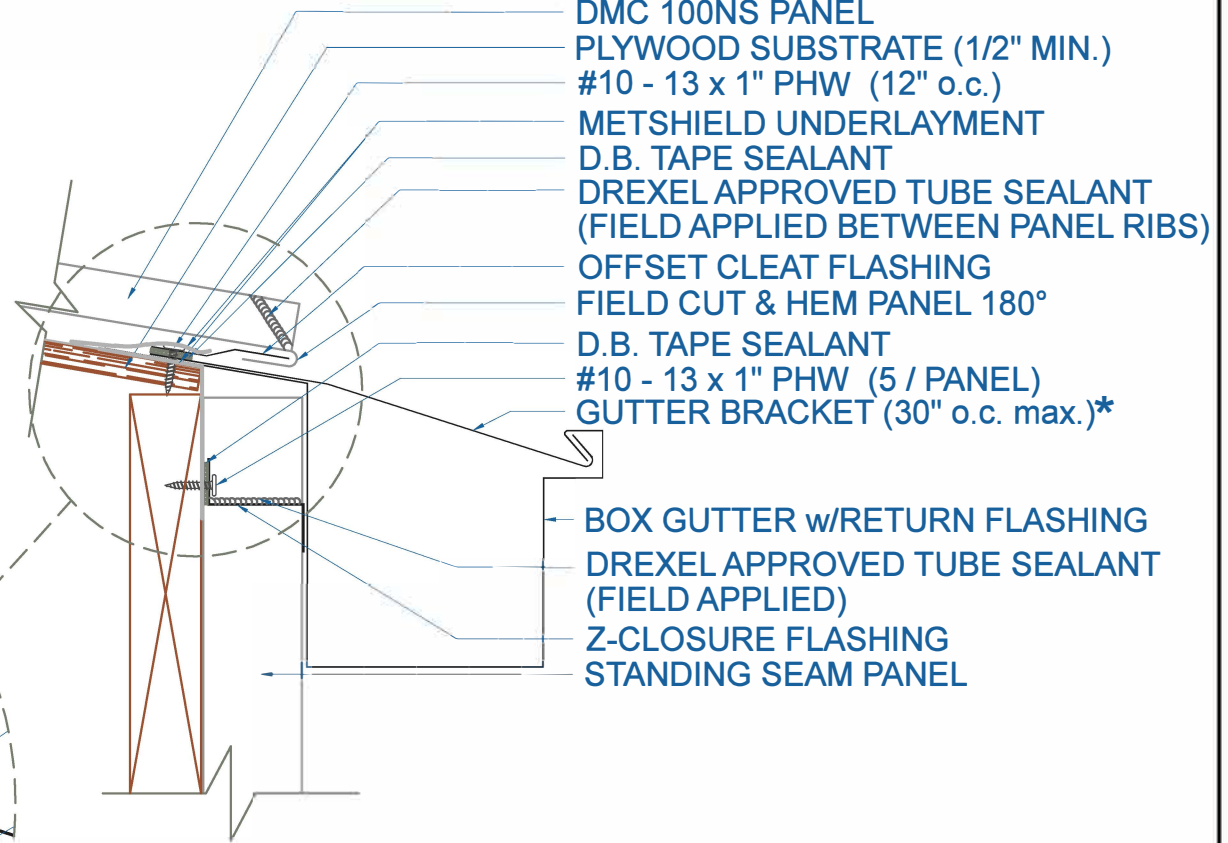

NOTE:
* DESIGN LOADS MAY REQUIRE
CLOSER SPACING.

BOX GUTTER w/RETURN w/STANDING SEAM PANEL

EFFECTIVE DATE: 02-15-2013
SUBJECT TO CHANGE WITHOUT NOTICE

SCALE: 3" = 1'-0"

DrexelMetals
Roofing Systems + Custom Fabrication



DMC 100NS - PLYWOOD

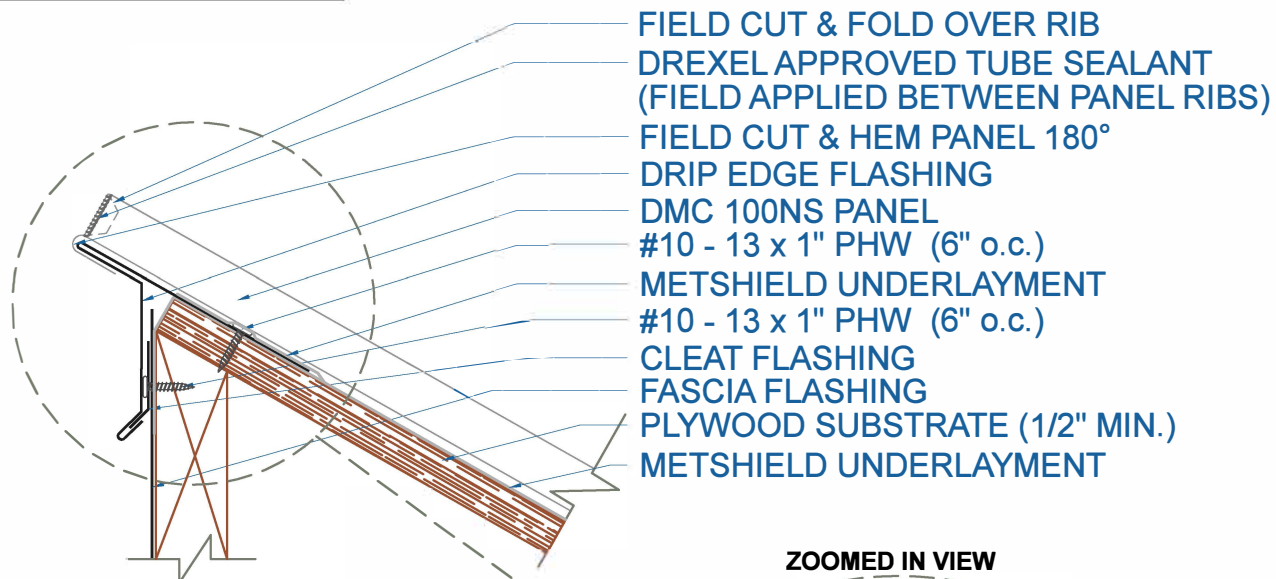

ZOOMED IN VIEW

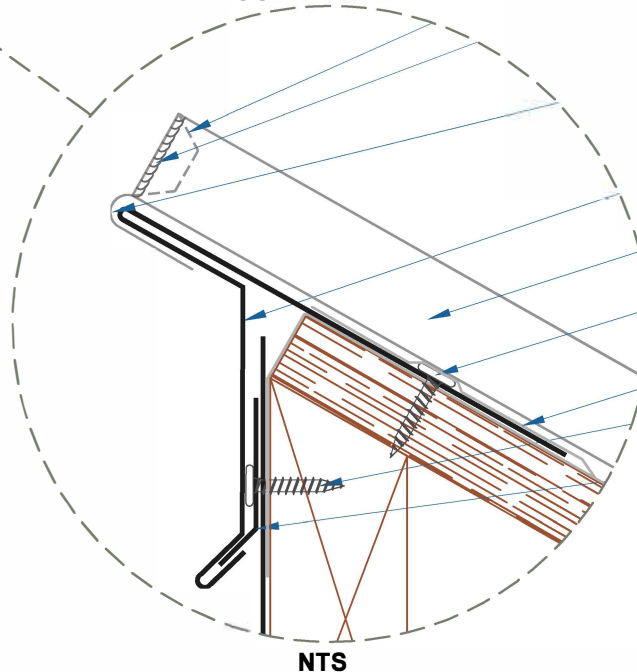

EFFECTIVE DATE: 02-15-2013
SUBJECT TO CHANGE WITHOUT NOTICE

DRIP EDGE PEAK

SCALE: 3" = 1'-0"

Drexel Metals
Roofing Systems + Custom Fabrication



DMC 100NS - PLYWOOD



REELFOOT METAL
ROOFING SYSTEMS
EST. 2000

ZOOMED IN VIEW

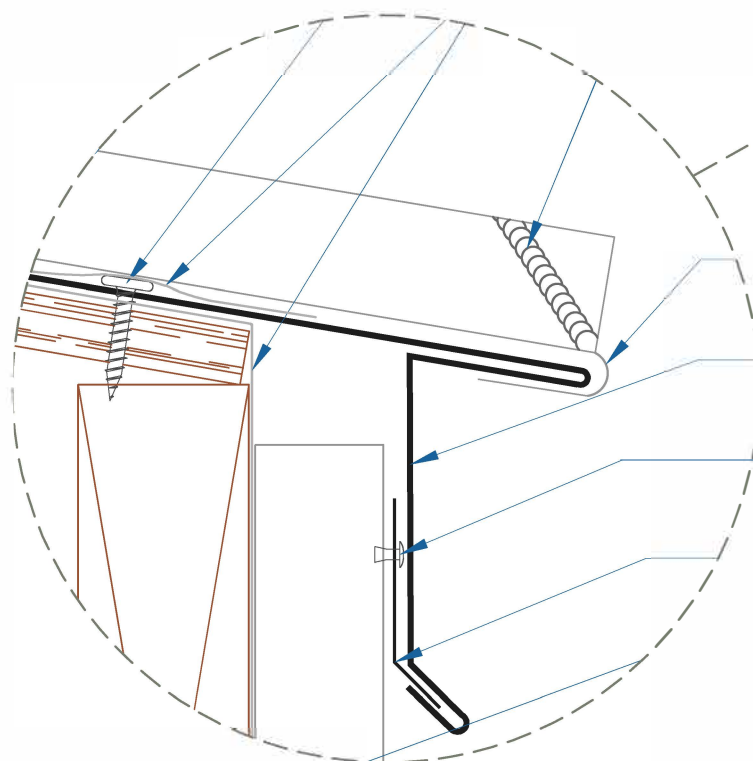

NTS

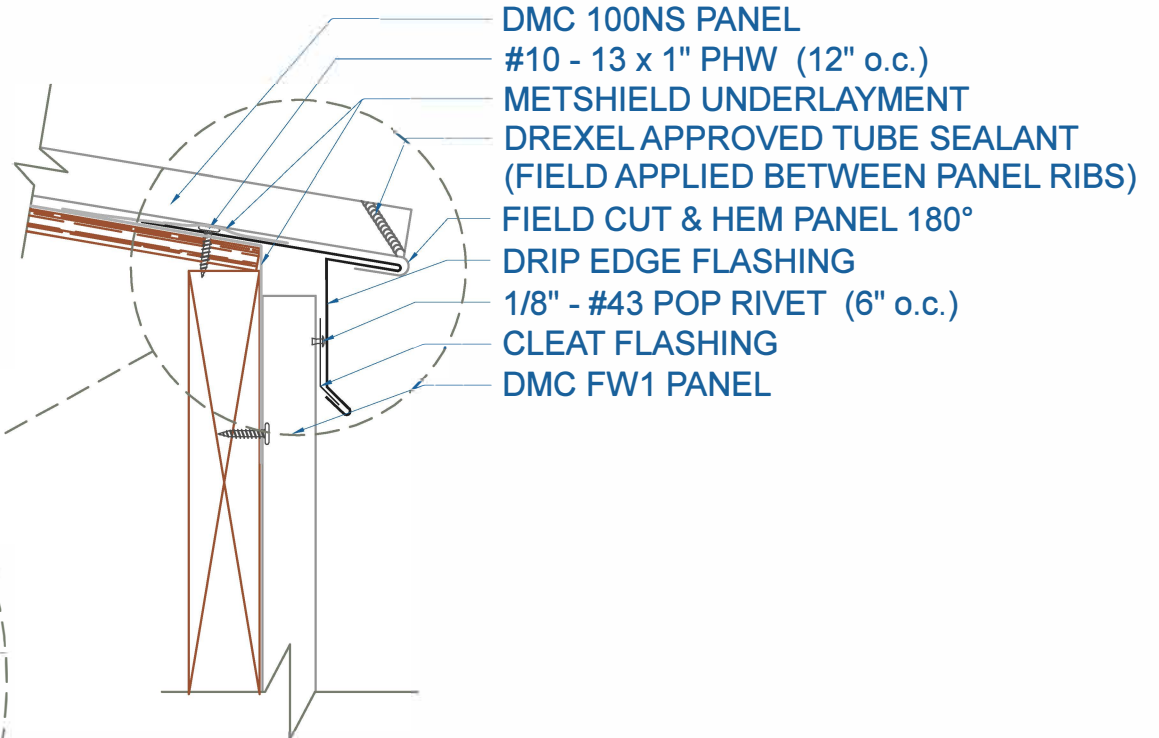

DRIP EDGE w/FLUSH PANEL

SCALE: 3" = 1'-0"

EFFECTIVE DATE: 02-15-2013
SUBJECT TO CHANGE WITHOUT NOTICE

DrexelMetals
Roofing Systems + Custom Fabrication



DMC 100NS - PLYWOOD

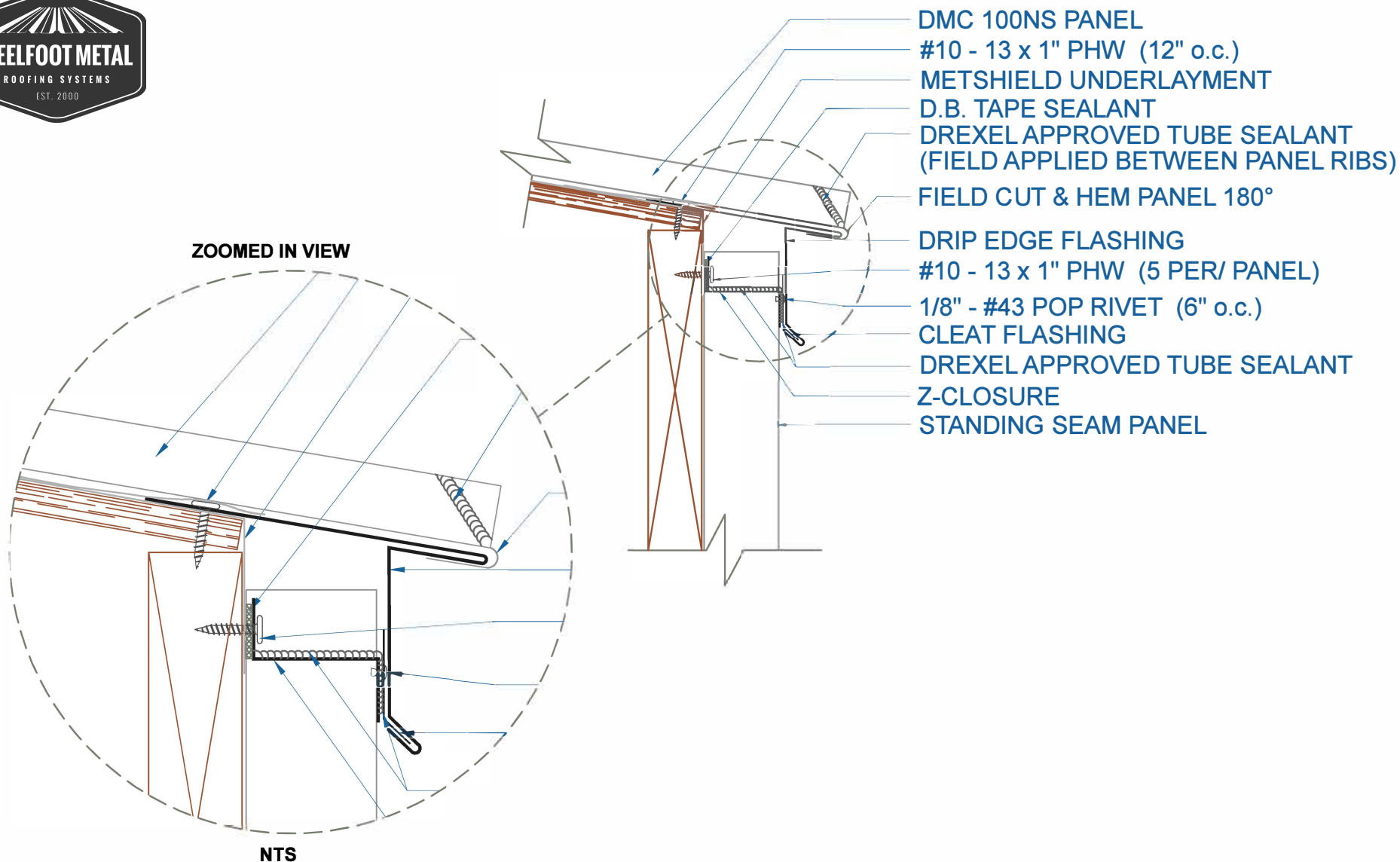

DRIP EDGE w/STANDING SEAM PANEL

EFFECTIVE DATE: 02-15-2013
SUBJECT TO CHANGE WITHOUT NOTICE

SCALE: 3" = 1'-0"

DrexelMetals
Roofing Systems + Custom Fabrication



DMC 100NS - PLYWOOD

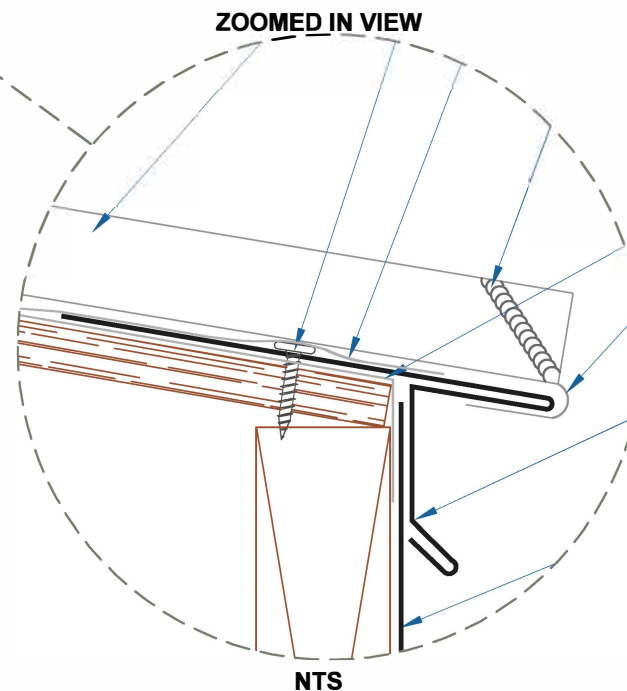
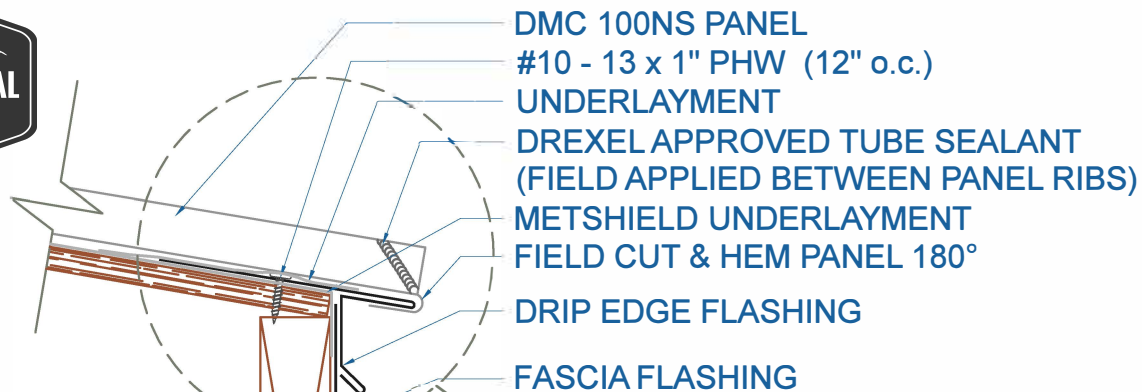

EFFECTIVE DATE: 02-15-2013
SUBJECT TO CHANGE WITHOUT NOTICE

DRIP EDGE

SCALE: 3" = 1'-0"



DMC 100NS - PLYWOOD



ZOOMED IN VIEW

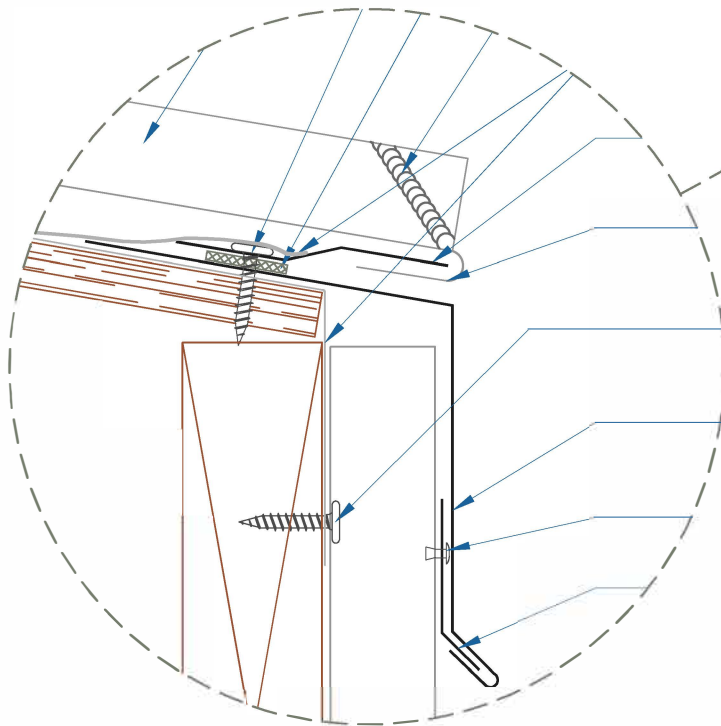

NTS

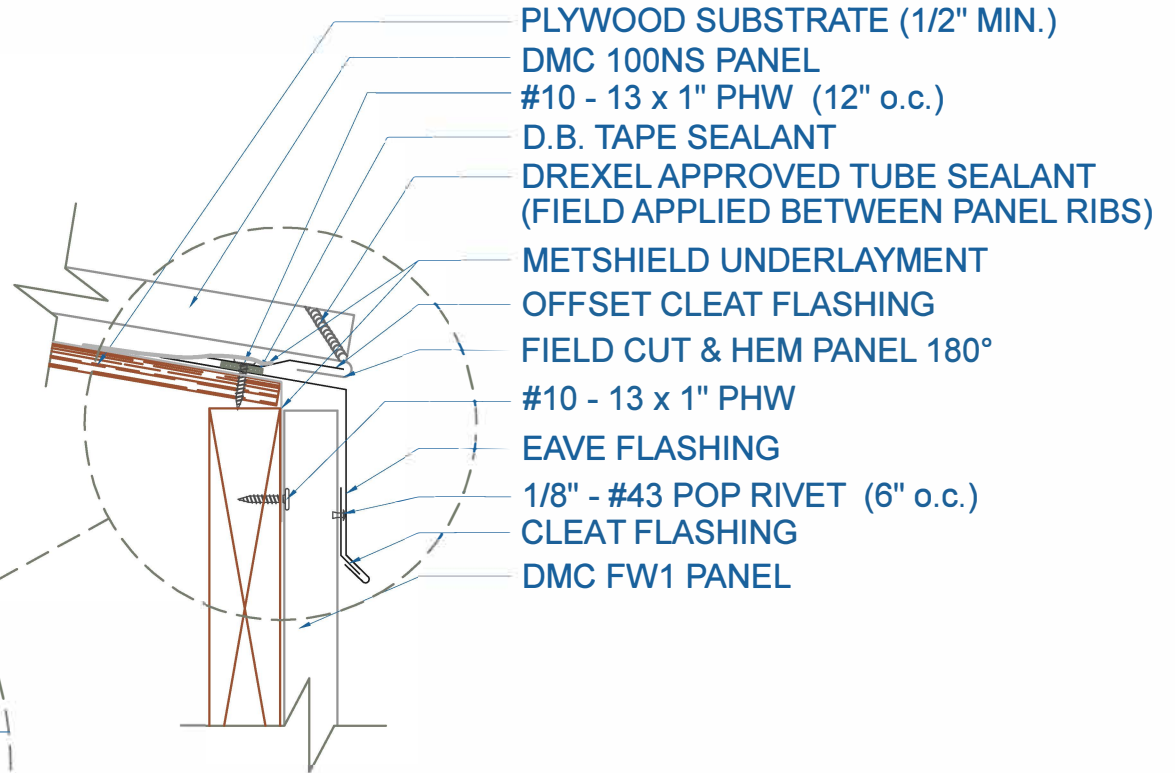

- PLYWOOD SUBSTRATE (1/2" MIN.)
- DMC 100NS PANEL
- #10 - 13 x 1" PHW (12" o.c.)
- D.B. TAPE SEALANT
- DREXEL APPROVED TUBE SEALANT (FIELD APPLIED BETWEEN PANEL RIBS)
- METSHIELD UNDERLAYMENT
- OFFSET CLEAT FLASHING
- FIELD CUT & HEM PANEL 180°
- #10 - 13 x 1" PHW
- EAVE FLASHING
- 1/8" - #43 POP RIVET (6" o.c.)
- CLEAT FLASHING
- DMC FW1 PANEL

EFFECTIVE DATE: 02-15-2013
SUBJECT TO CHANGE WITHOUT NOTICE

EAVE w/FLUSH PANEL

SCALE: 3" = 1'-0"

DrexelMetals
Roofing Systems + Custom Fabrication



DMC 100NS - PLYWOOD

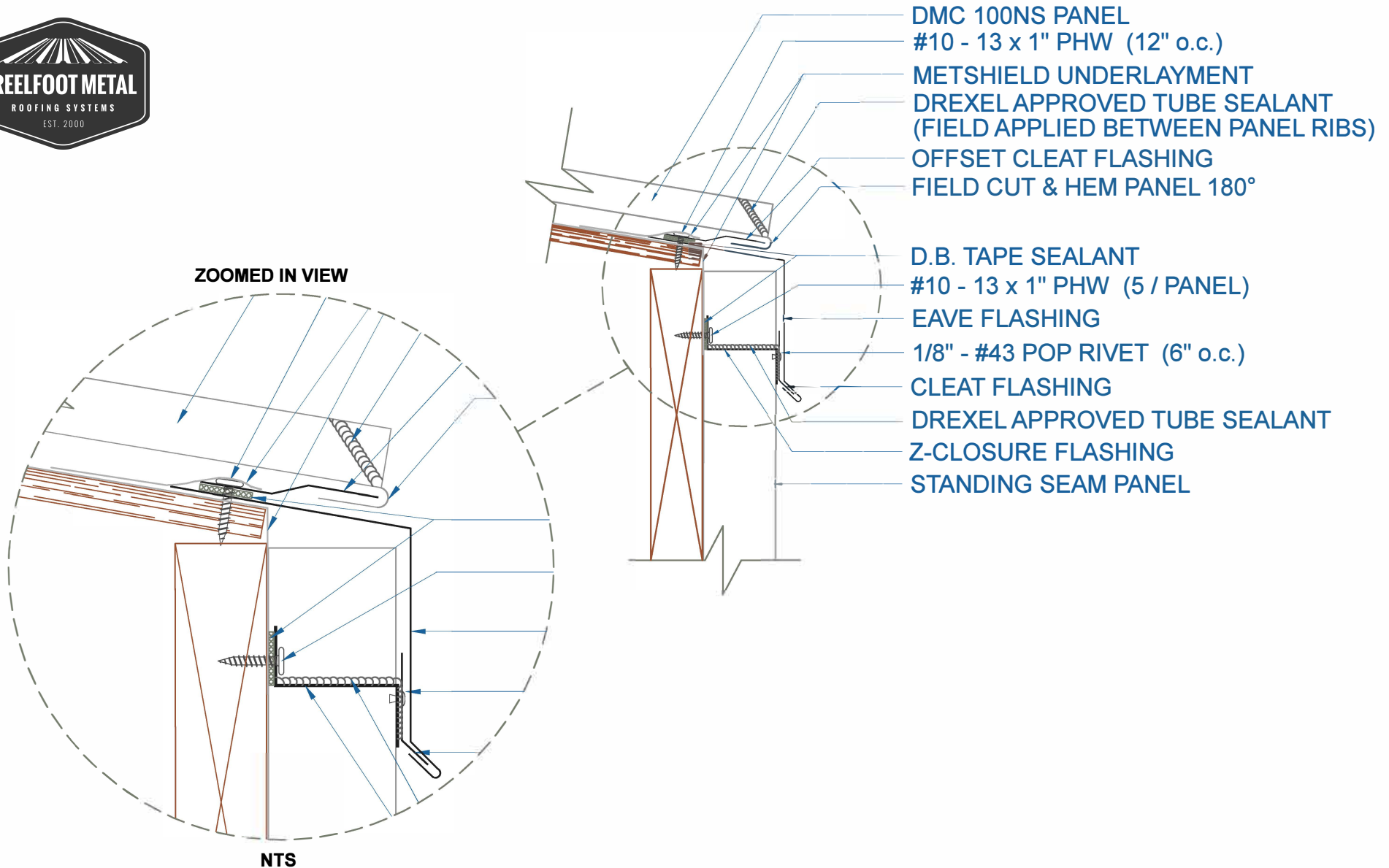

EAVE w/STANDING SEAM PANEL

EFFECTIVE DATE: 02-15-2013
SUBJECT TO CHANGE WITHOUT NOTICE

SCALE: 3" = 1'-0"



DMC 100NS - PLYWOOD



- #10 - 13 x 1" PHW (12" o.c.)
- METSHIELD UNDERLAYMENT
- PLYWOOD SUBSTRATE (1/2" MIN.)
- DMC 100NS PANEL (FIELD CUT AND BEND)
- #10 - 13 x 1" PHW (12" o.c.)
- DRIP EDGE FLASHING
- CLEAT FLASHING
- FASCIA FLASHING

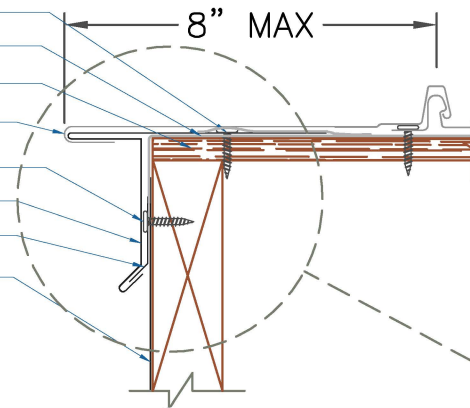

ZOOMED IN VIEW

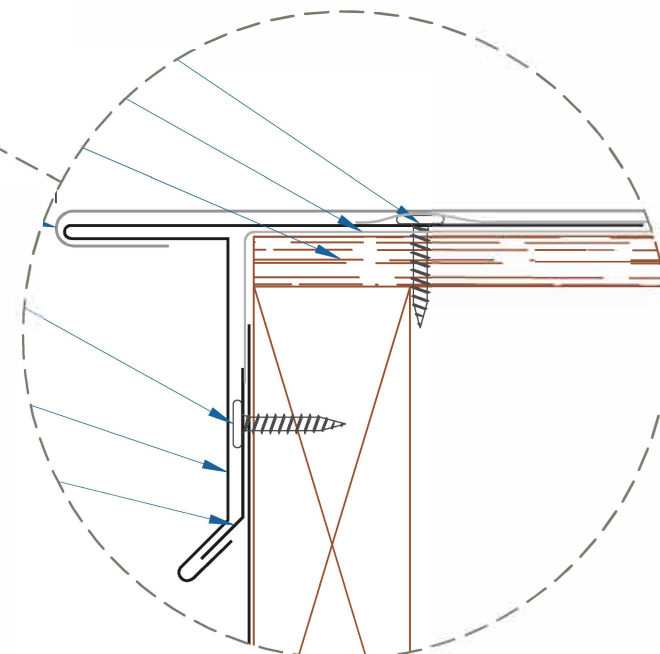

NTS

GABLE
ALTERNATE / CURVED

EFFECTIVE DATE: 02-15-2013
SUBJECT TO CHANGE WITHOUT NOTICE

SCALE: 3" = 1'-0"



DMC 100NS - PLYWOOD

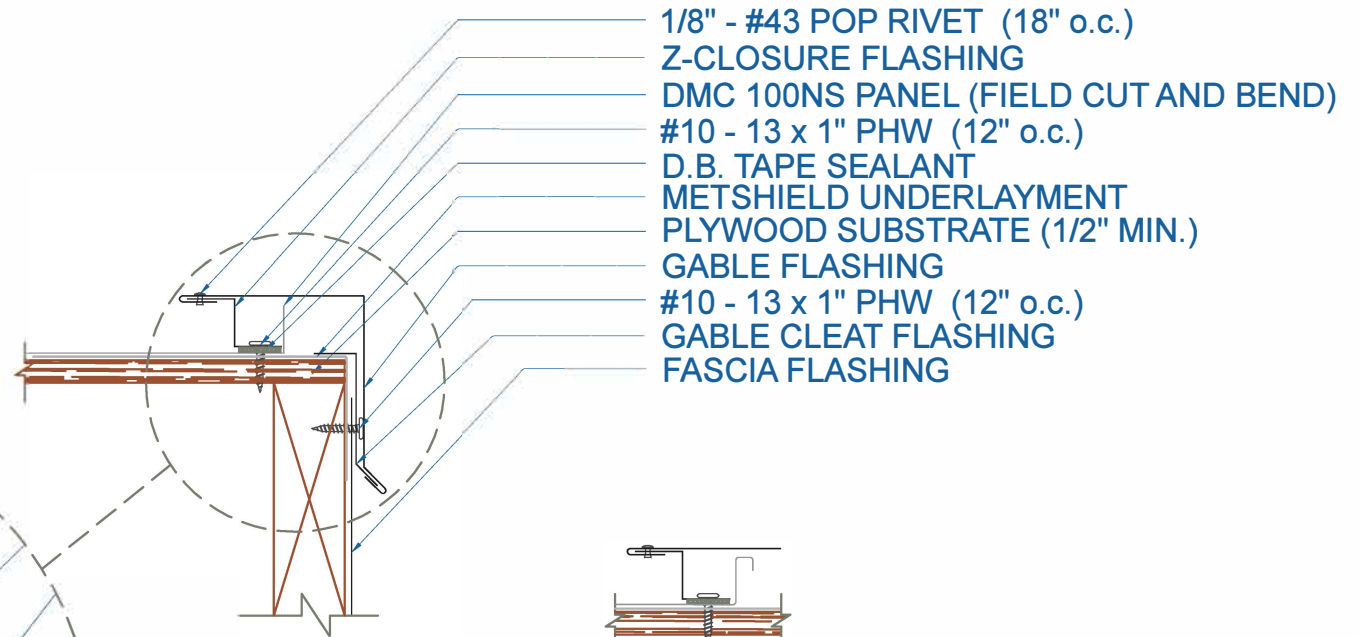

ZOOMED IN VIEW

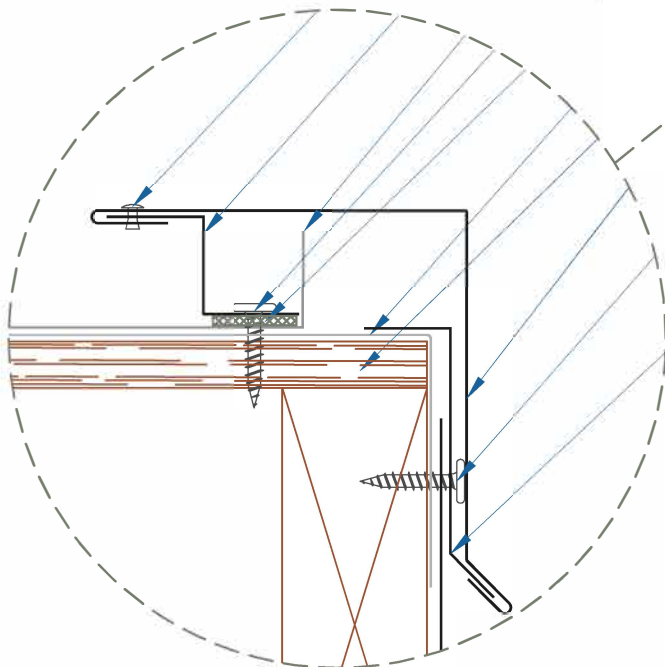

NTS

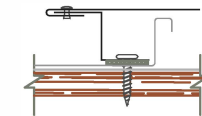

ON MODULE

EFFECTIVE DATE: 02-15-2013
SUBJECT TO CHANGE WITHOUT NOTICE

GABLE
SCALE: 3" = 1'-0"

Drexel Metals
Roofing Systems + Custom Fabrication



DMC 100NS - PLYWOOD

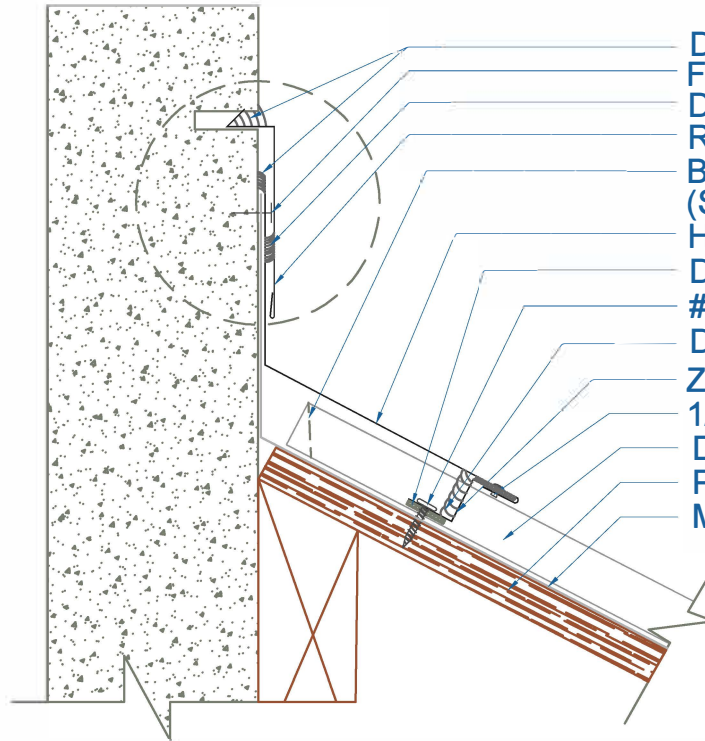

DREXEL APPROVED TUBE SEALANT
FASTENERS (BY OTHERS)
DREXEL APPROVED TUBE SEALANT
REGLET FLASHING
BOX END OF PANEL
(SEE ZEE CLOSURE OPTIONS DETAIL)
HEADWALL FLASHING
D.B. TAPE SEALANT
#10 - 13 x 1" PHW (5 PER PANEL)
DREXEL APPROVED TUBE SEALANT
Z-CLOSURE FLASHING
1/8" - #43 POP RIVET (18" o.c.)
DMC 100NS PANEL
PLYWOOD SUBSTRATE (1/2" MIN.)
METSHIELD UNDERLAYMENT

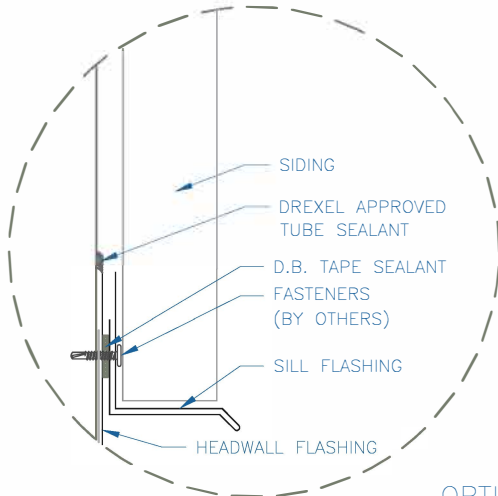

OPTION 1

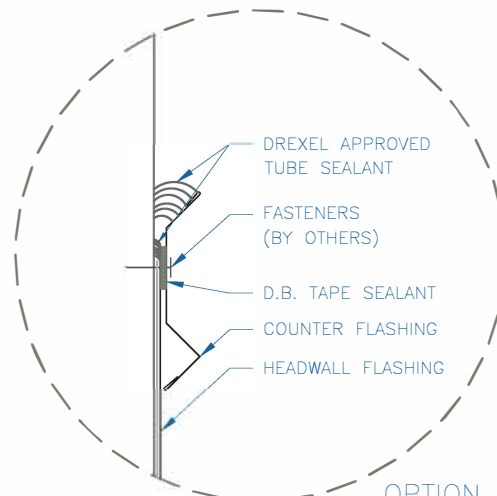

OPTION 2

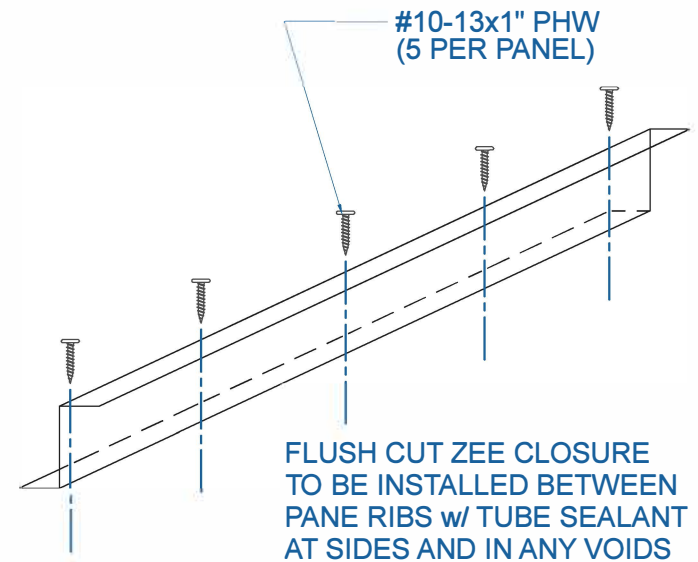

FLUSH CUT ZEE CLOSURE
TO BE INSTALLED BETWEEN
PANE RIBS w/ TUBE SEALANT
AT SIDES AND IN ANY VOIDS

EFFECTIVE DATE: 02-15-2013
SUBJECT TO CHANGE WITHOUT NOTICE

HEADWALL

SCALE: 3" = 1'-0"

Drexel Metals
Roofing Systems + Custom Fabrication



DMC 100NS - PLYWOOD

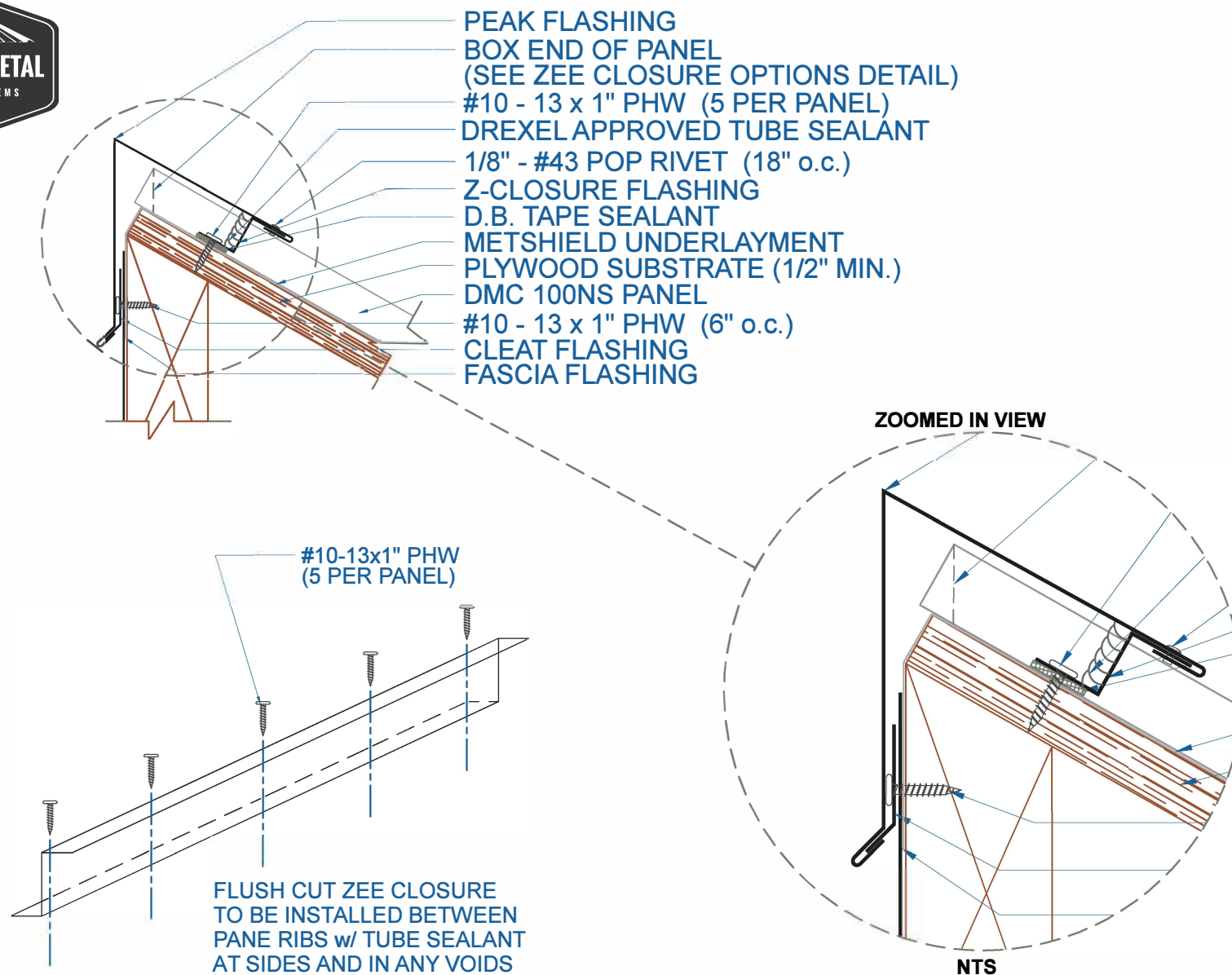

EFFECTIVE DATE: 02-15-2013
 SUBJECT TO CHANGE WITHOUT NOTICE

PEAK
 SCALE: 3" = 1'-0"

Drexel Metals
 Roofing Systems + Custom Fabrication



DMC 100NS - PLYWOOD

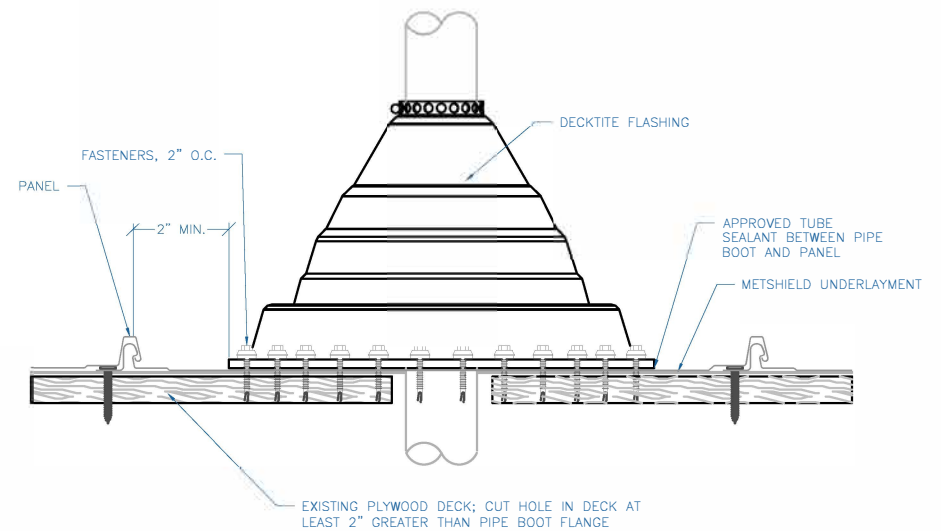
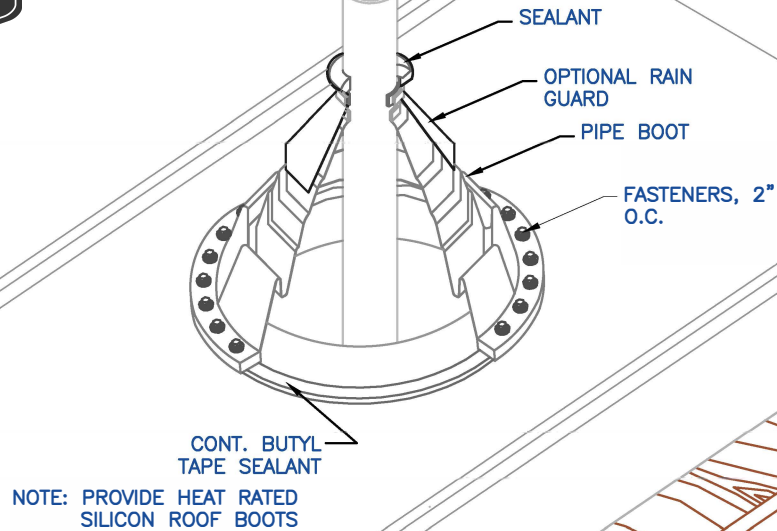

EFFECTIVE DATE: 02-22-2013
SUBJECT TO CHANGE WITHOUT NOTICE

PIPE FLASHING DETAIL

SCALE: NTS

Drexel Metals
Roofing Systems + Custom Fabrication



DMC 100NS - PLYWOOD



ZOOMED IN VIEW

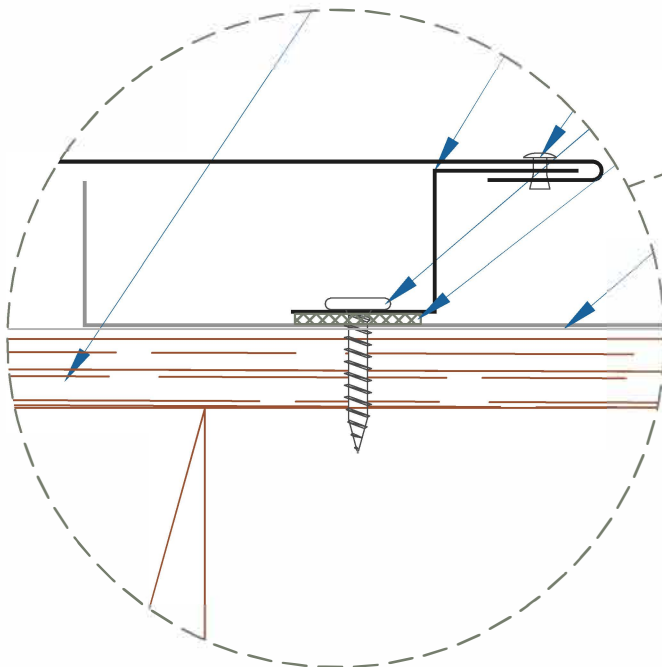

NTS

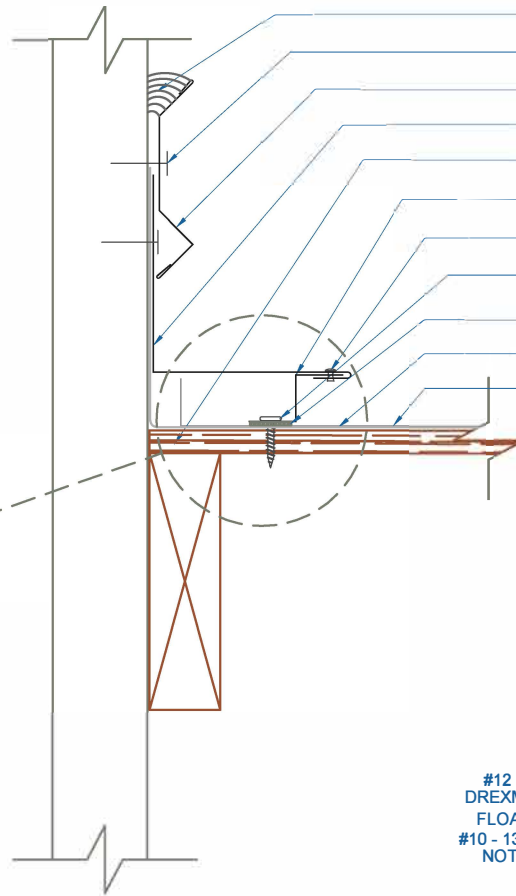

DREXEL APPROVED TUBE SEALANT
FASTENERS (BY OTHERS)
COUNTER FLASHING
RAKEWALL FLASHING
PLYWOOD SUBSTRATE (1/2" MIN.)
Z-CLOSURE FLASHING
1/8" - #43 POP RIVET (18" o.c.)
#10 - 13 x 1" PHW (12" o.c.)
D.B. TAPE SEALANT
METSHIELD UNDERLAYMENT
DMC 100NS PANEL (FIELD CUT AND BEND)

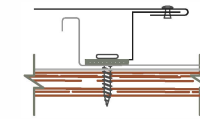

ON MODULE

#12 - 14 x 1 1/2" DP3 SD
DREXMET HEAD (12" o.c.)
FLOATING RAKE ANGLE
#10 - 13 x 1" PHW (12" o.c.)
NOT TO BE TIGHTENED

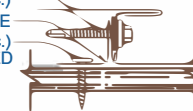

FLOATING RAKEWALL

EFFECTIVE DATE: 02-15-2013
SUBJECT TO CHANGE WITHOUT NOTICE

RAKEWALL

SCALE: 3" = 1'-0"

DrexelMetals
Roofing Systems + Custom Fabrication



DMC 100NS - PLYWOOD

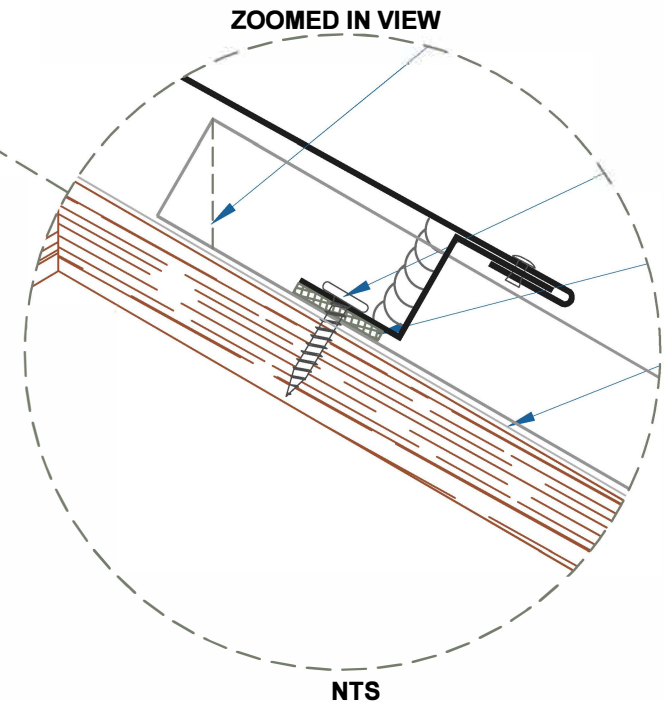
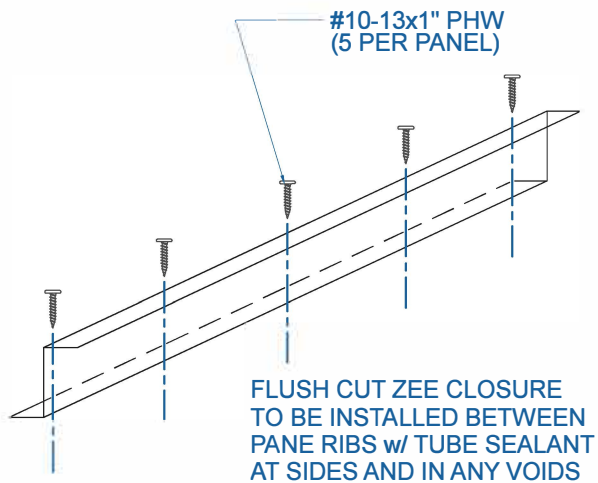
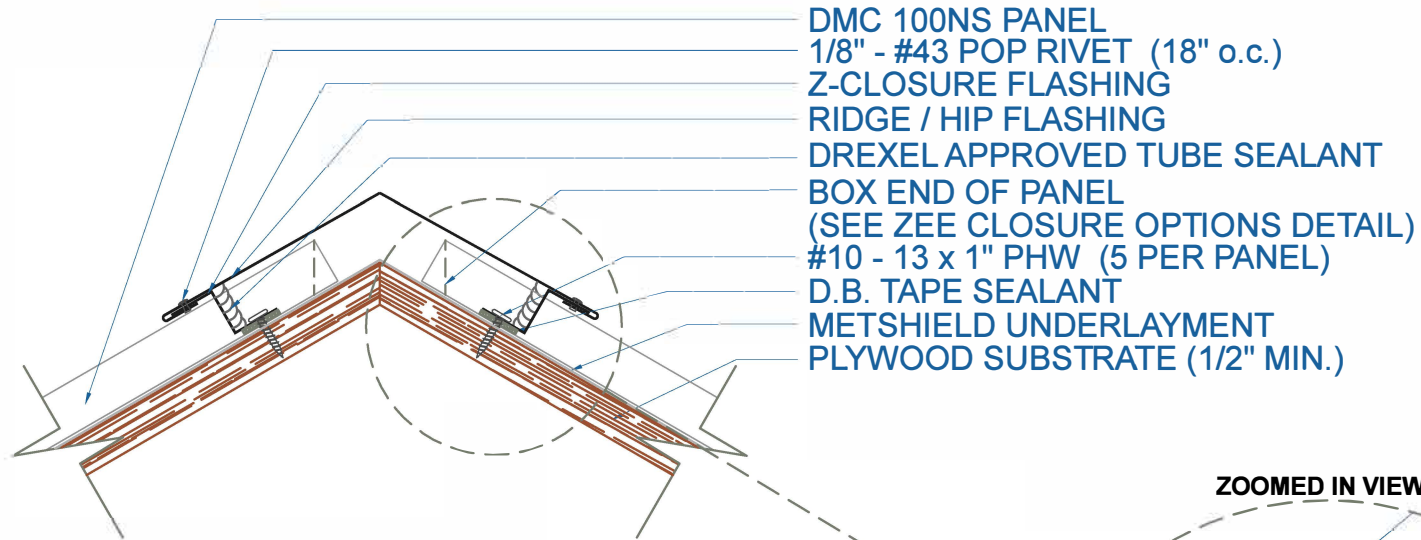

EFFECTIVE DATE: 02-15-2013
SUBJECT TO CHANGE WITHOUT NOTICE

RIDGE / HIP

SCALE: 3" = 1'-0"

Drexel Metals
Roofing Systems + Custom Fabrication



DMC100NS - PLYWOOD



- DMC 100NS PANEL
- #10 - 13 x 1" PHW (12" o.c.)
- D.B. TAPE SEALANT
- OFFSET CLEAT FLASHING
- FIELD CUT & HEM PANEL 180°
- BOX END OF PANEL
(SEE ZEE CLOSURE OPTIONS DETAIL)
- TRANSITION FLASHING
- #10 - 13 x 1" PHW (5 PER PANEL)
- D.B. TAPE SEALANT
- 1/8" - #43 POP RIVET (18" o.c.)
- Z-CLOSURE
- PLYWOOD SUBSTRATE (1/2" MIN.)
- DMC 100NS PANEL
- METSHIELD UNDERLAYMENT

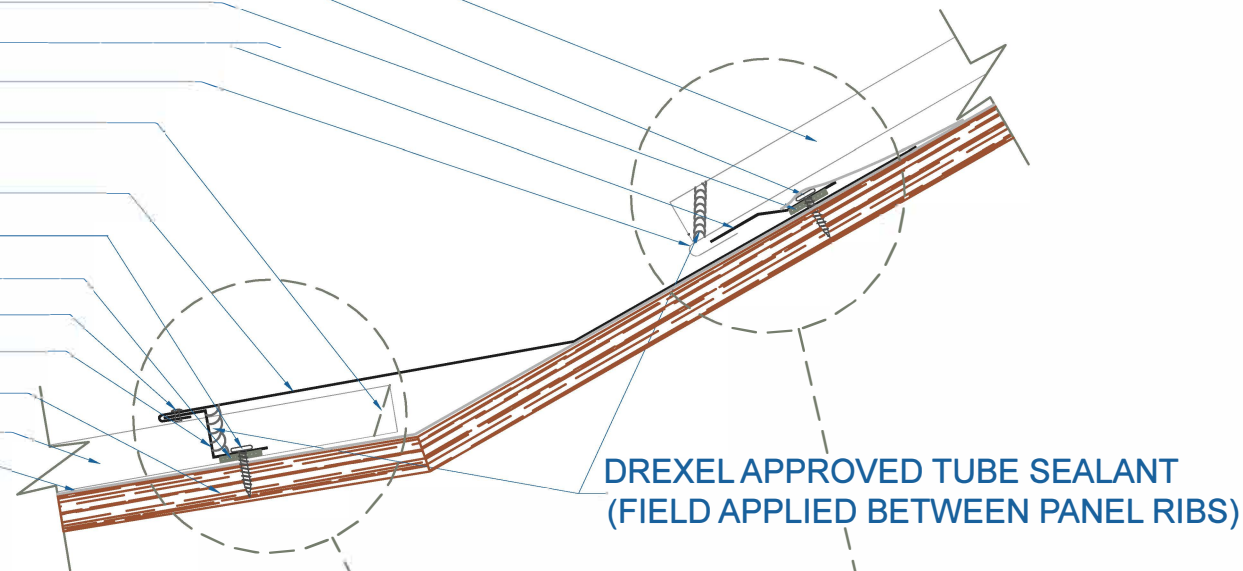

DREXEL APPROVED TUBE SEALANT
(FIELD APPLIED BETWEEN PANEL RIBS)

ZOOMED IN VIEW

ZOOMED IN VIEW

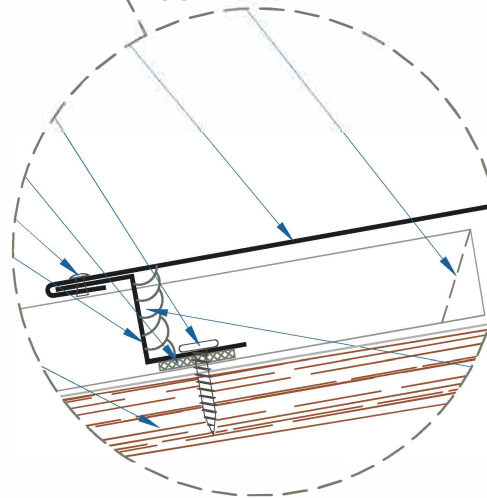

NTS

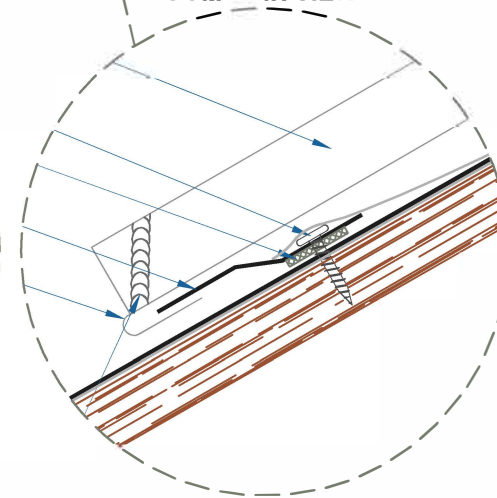

NTS

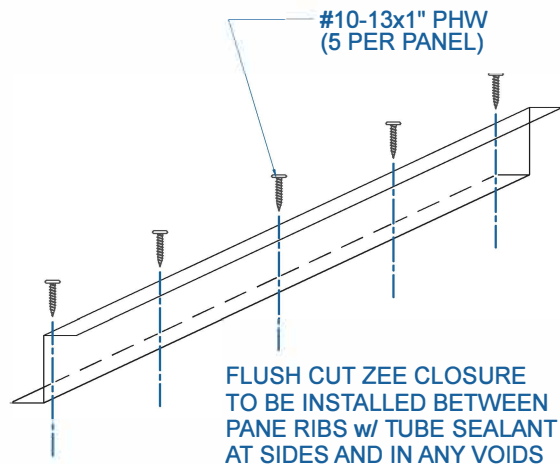

FLUSH CUT ZEE CLOSURE
TO BE INSTALLED BETWEEN
PANE RIBS w/ TUBE SEALANT
AT SIDES AND IN ANY VOIDS

TRANSITION

SCALE: 3" = 1'-0"

EFFECTIVE DATE: 02-15-2013
SUBJECT TO CHANGE WITHOUT NOTICE

Drexel Metals
Roofing Systems + Custom Fabrication



DMC 100NS - PLYWOOD



ZOOMED IN VIEW

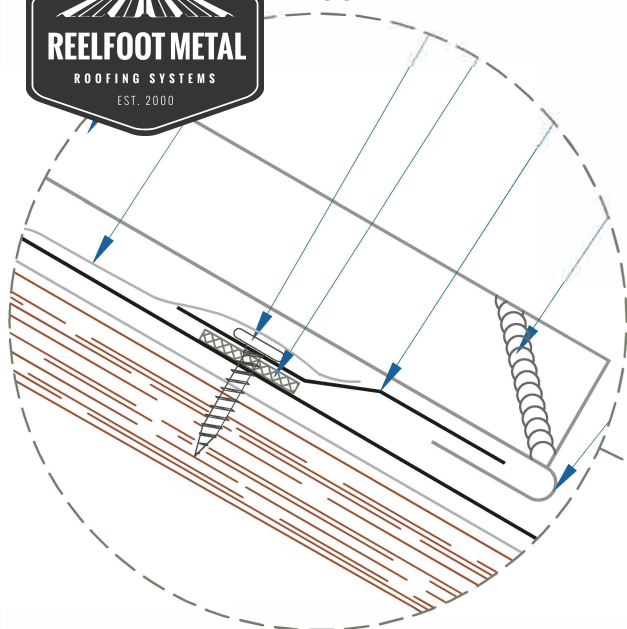

NTS

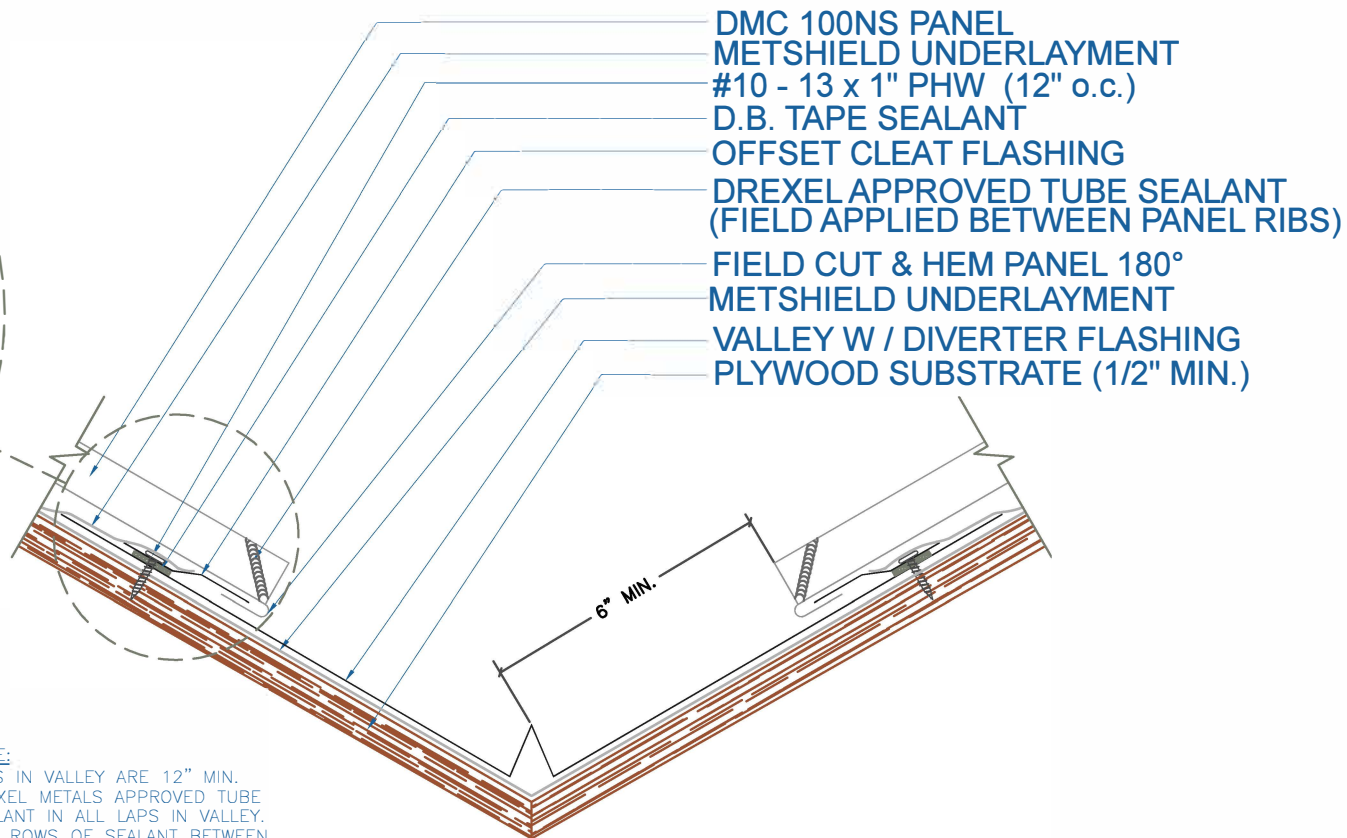

NOTE:

- 1.) LAPS IN VALLEY ARE 12" MIN.
DREXEL METALS APPROVED TUBE
SEALANT IN ALL LAPS IN VALLEY.
TWO ROWS OF SEALANT BETWEEN
VALLEY LAPS, 4" UP FROM LAP.
- 2.) LARGE ROOF AREAS MAY REQUIRE
A LARGER GAP BETWEEN PANEL
AND DIVERTER TO ALLOW FOR
STORM WATER RUN OFF.

VALLEY W / DIVERTER

SCALE: 3" = 1'-0"

EFFECTIVE DATE: 02-15-2013
SUBJECT TO CHANGE WITHOUT NOTICE

DrexelMetals
Roofing Systems + Custom Fabrication



DMC 100NS - PLYWOOD



ZOOMED IN VIEW

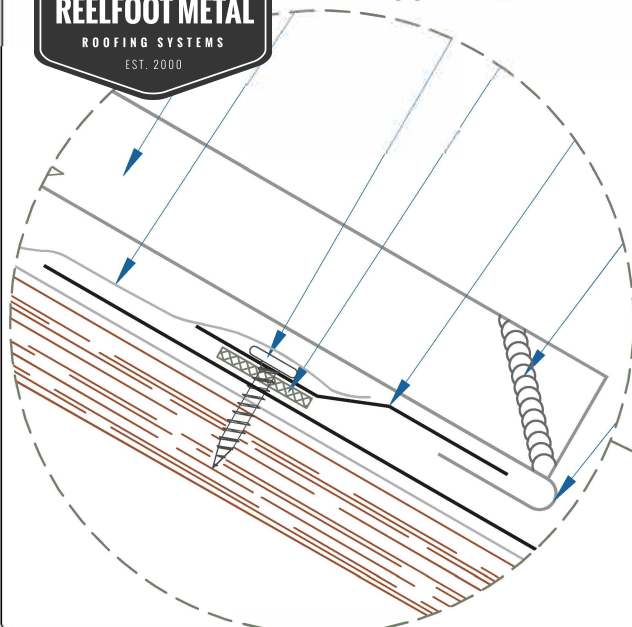

NTS

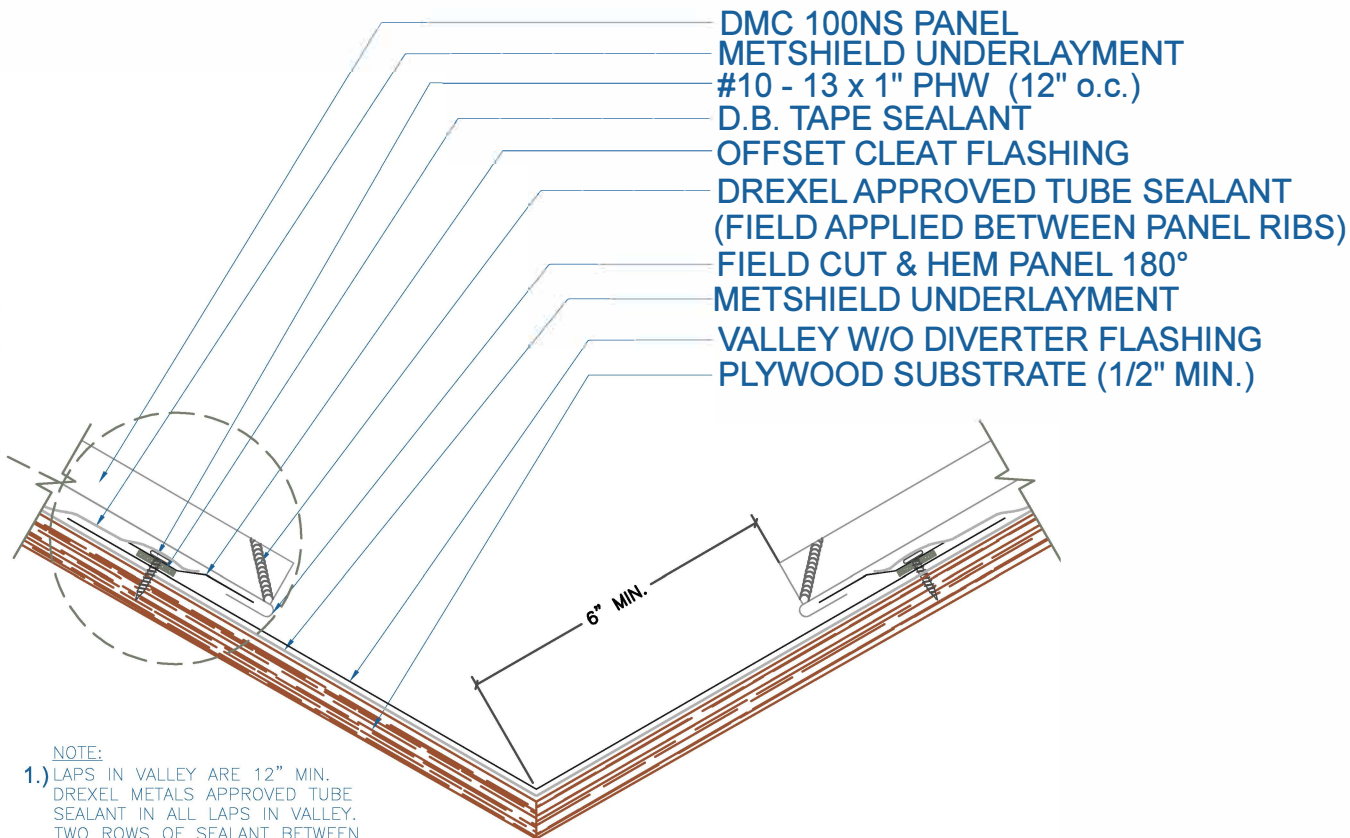

NOTE:

- 1.) LAPS IN VALLEY ARE 12" MIN.
DREXEL METALS APPROVED TUBE SEALANT IN ALL LAPS IN VALLEY.
TWO ROWS OF SEALANT BETWEEN VALLEY LAPS, 4" UP FROM LAP.
- 2.) LARGE ROOF AREAS MAY REQUIRE A LARGER GAP BETWEEN PANEL AND DIVERTER TO ALLOW FOR STORM WATER RUN OFF.

VALLEY W/O DIVERTER

SCALE: 3" = 1'-0"

Drexel Metals
Roofing Systems + Custom Fabrication

EFFECTIVE DATE: 02-15-2013
SUBJECT TO CHANGE WITHOUT NOTICE

DMC 100NS - PLYWOOD



NOTE:

- 1.) LAPS IN VALLEYWALL ARE 12" MIN. DREXEL METALS APPROVED SEALANT IN ALL LAPS IN VALLEY. TWO ROWS OF SEALANT BETWEEN VALLEYWALL LAPS, 4" UP FROM LAP.
- 2.) LARGE ROOF AREAS MAY REQUIRE A LARGER GAP BETWEEN PANEL AND WALL TO ALLOW FOR STORM WATER RUN OFF.

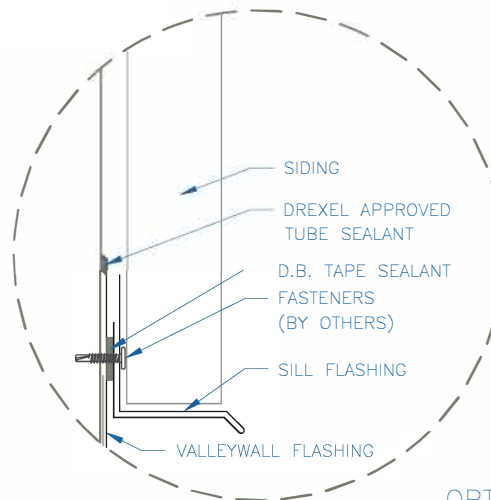
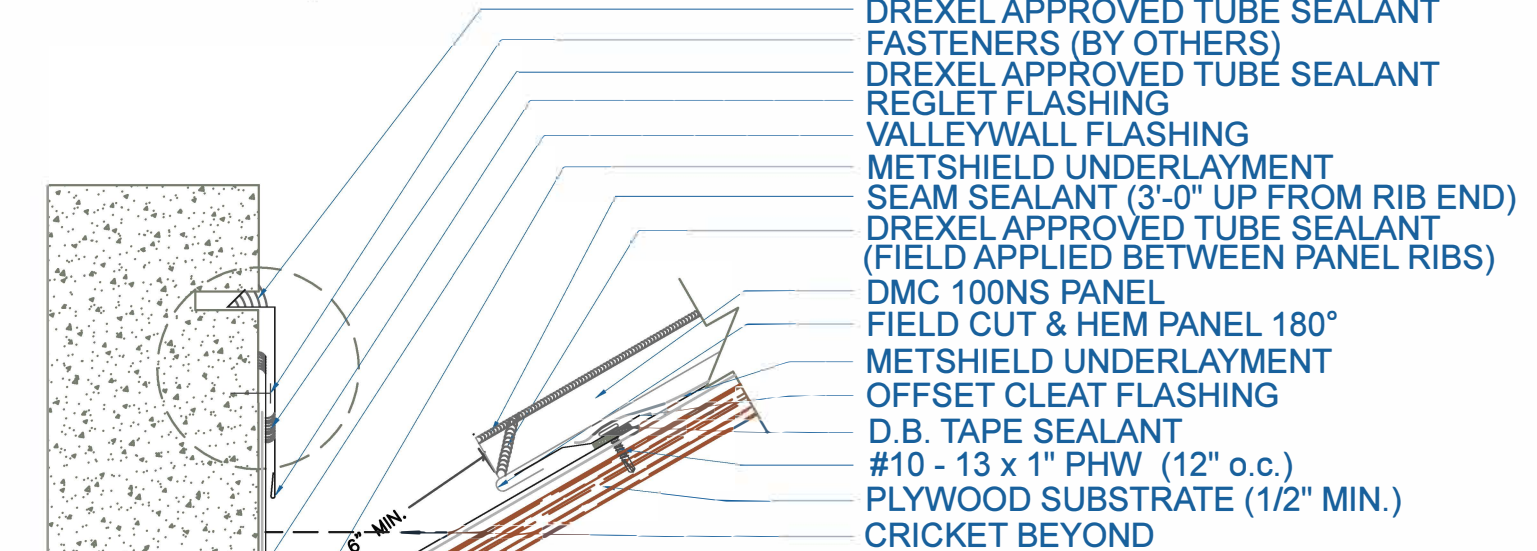

OPTION 1

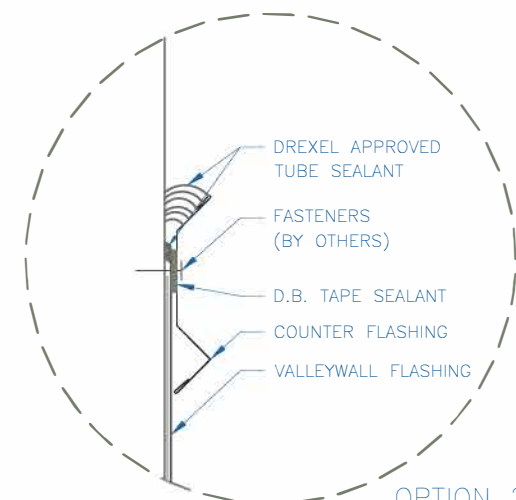

OPTION 2

VALLEYWALL

SCALE: 3" = 1'-0"

EFFECTIVE DATE: 02-15-2013
SUBJECT TO CHANGE WITHOUT NOTICE

DMC 100NS - PLYWOOD

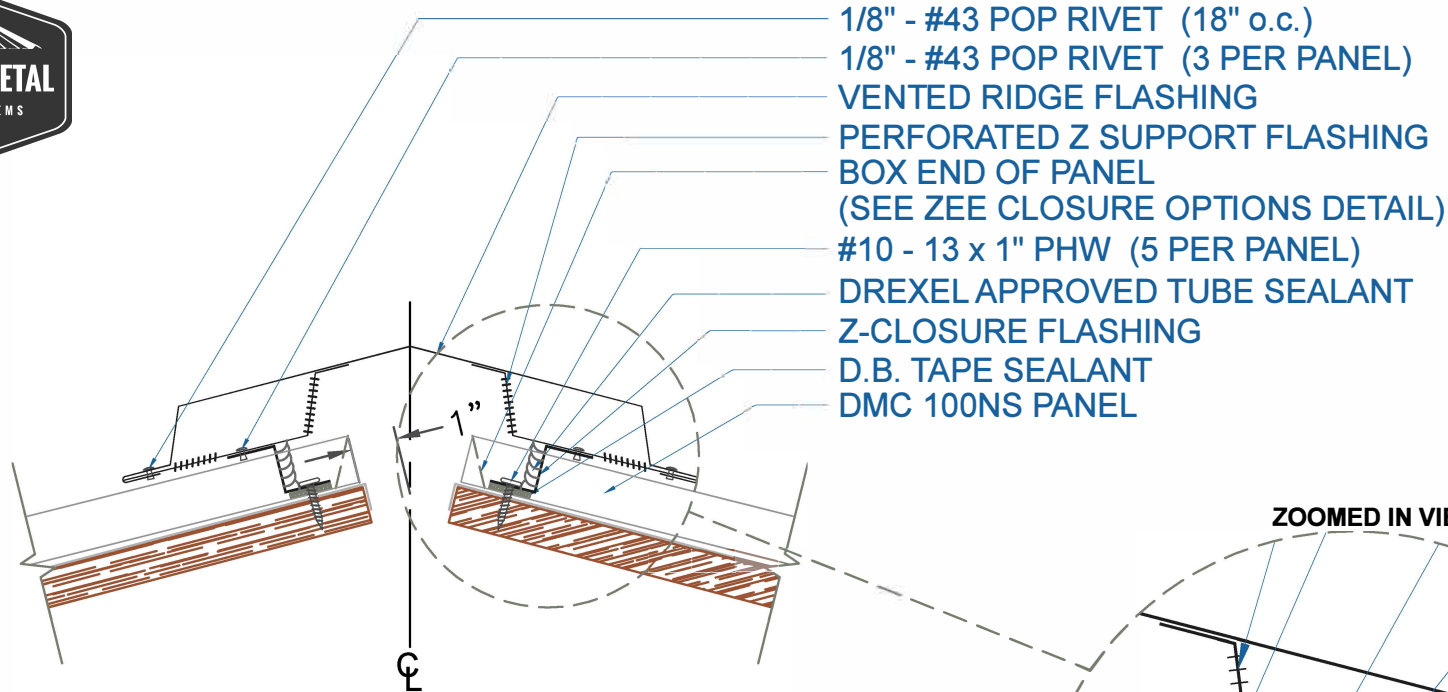

NOTE:
1.) NET FREE AREA = 6.16 SQ IN/FT

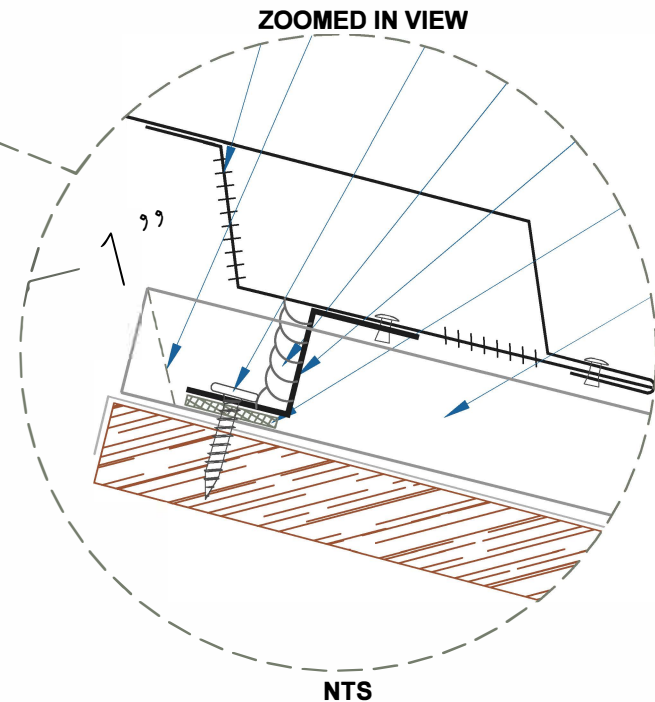
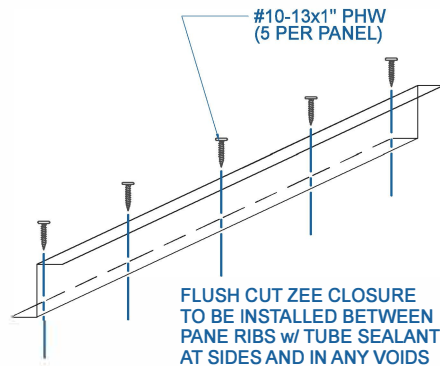

VENTED RIDGE / HIP

SCALE: 3" = 1'-0"

EFFECTIVE DATE: 02-15-2013
SUBJECT TO CHANGE WITHOUT NOTICE

